

F.A.I. RTE.	SECTION	COUNTY	TOTAL SHEETS	SHEET NO.
90/94	2004-094 I	COOK	40	22
STA. 113+00	TO STA. 118+00			
FED. ROAD DIST. NO. 1	ILLINOIS	FED. AID PROJECT		

62835

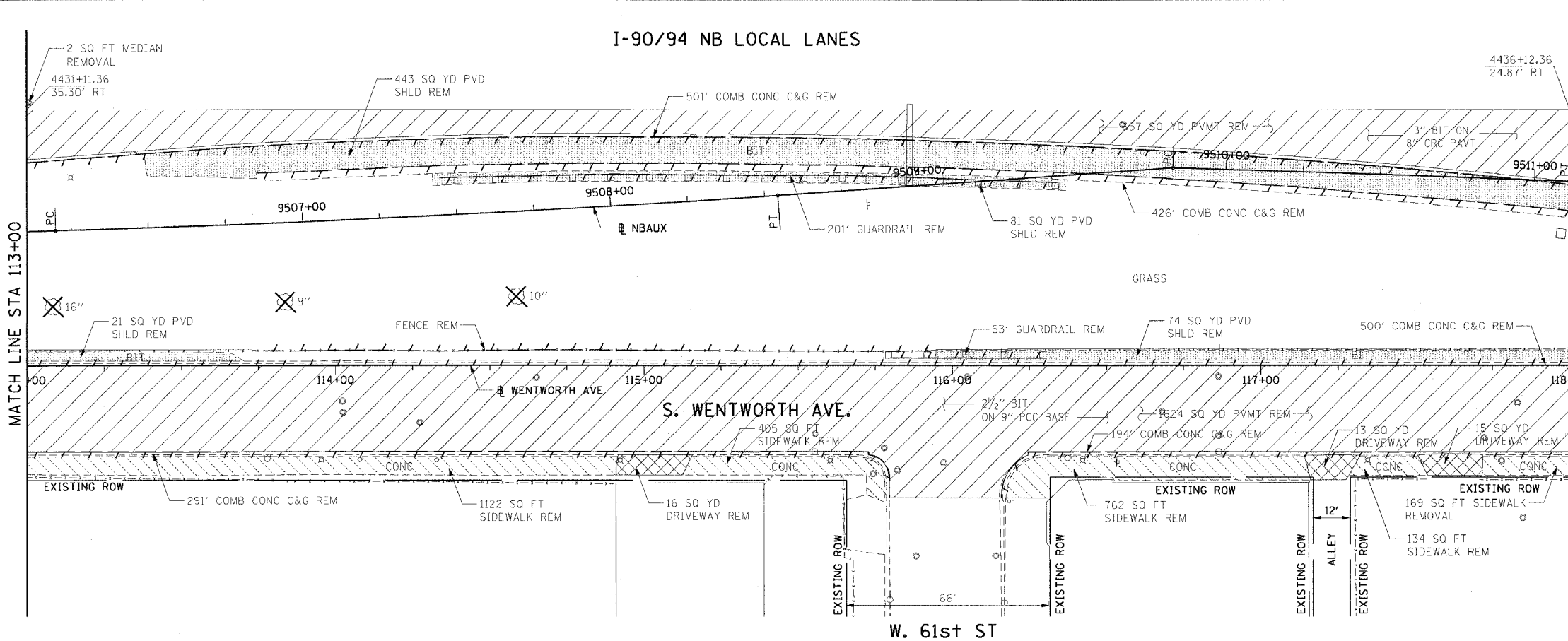

- LEGEND:**
- PAVEMENT REMOVAL (BY OTHERS)
 - MEDIAN REMOVAL (BY OTHERS)
 - LINEAR REMOVALS (BY OTHERS)
 - SIDEWALK REMOVAL (BY OTHERS)
 - APPROACH SLAB REMOVAL (BY OTHERS)
 - DRIVEWAY PAVEMENT REMOVAL (BY OTHERS)
 - PAVED SHOULDER REMOVAL (BY OTHERS)
 - TREE REMOVAL (BY OTHERS)

**EXISTING CONDITIONS AND REMOVAL
PROPOSED IMPROVEMENTS**

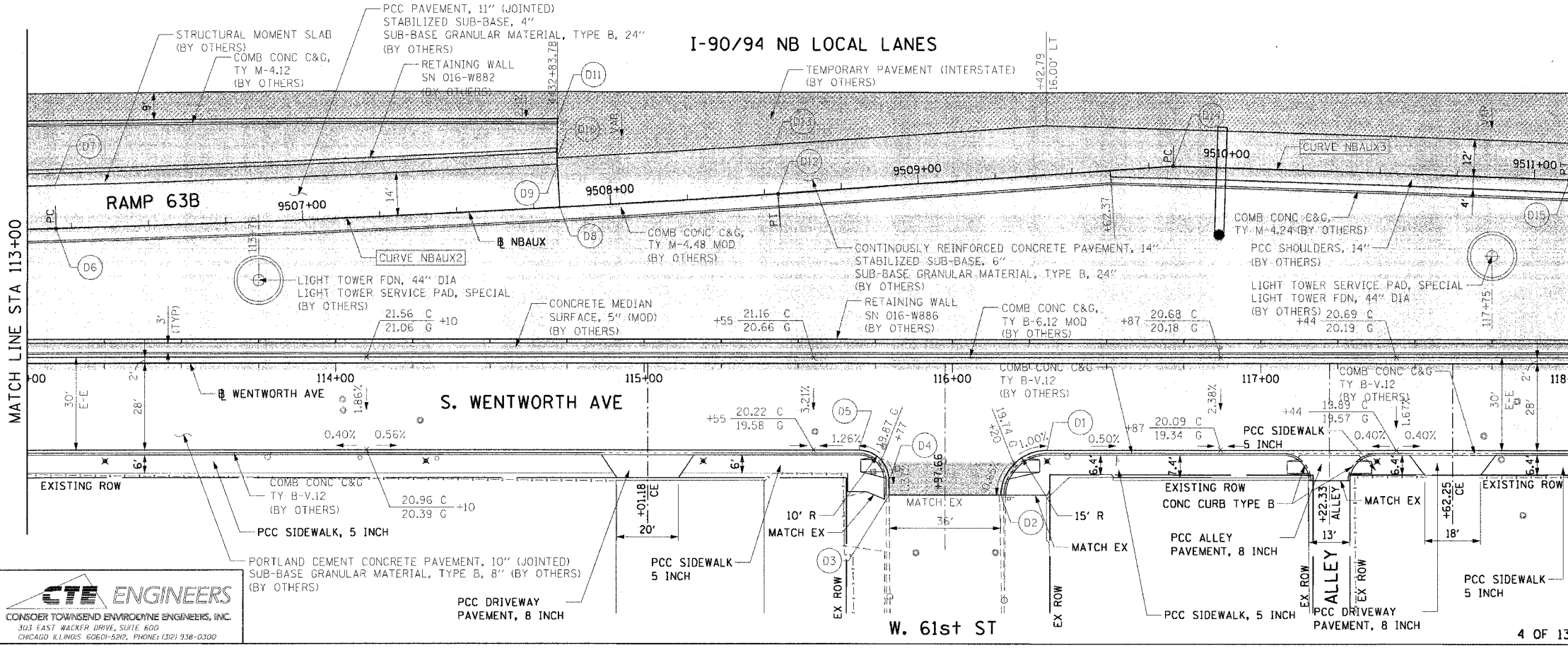

- LEGEND:**
- WORK TO BE DONE BY OTHERS

- NOTES:**
1. SEE SIDEWALK DETAIL ON SHEET 34.
 2. SEE SIDEWALK RAMP DETAIL ON SHEET 33.
 3. SEE DRIVEWAY DETAIL ON SHEET 35.
 4. SEE ALLEY DETAIL ON SHEET 36.
 5. SEE CURB DETAIL ON SHEET 32.
 6. THE CONTRACTOR SHALL COORDINATE LOCATIONS REGARDING THE SIGNING (62836) AND CONDUIT & LIGHT POLE FOUNDATION (62842) CONTRACTS.

PT.	STATION	OFFSET	LOC	PT.	STATION	OFFSET	LOC
D1	116+30.77	28.00' RT	EOP	D9	9507+83.45	14.00' LT	EOP
D2	116+15.77	42.86' RT	EOP	D10	9507+83.45	16.00' LT	EOP
D3	115+79.55	42.86' RT	EOP	D11	9507+84.38	28.11' LT	EOP
D4	115+79.52	37.93' RT	EOP	D12	9508+54.39	0.00	EOP
D5	115+69.52	28.00' RT	EOP	D13	9508+54.39	16.00' LT	EOP
D6	9506+20.03	0.00	EOP	D14	9509+82.81	0.00	EOP
D7	9506+20.03	14.00' LT	EOP	D15	9511+11.27	0.00	EOP
D8	9507+83.45	0.00	EOP				

REVISIONS

NAME	DATE

ILLINOIS DEPARTMENT OF TRANSPORTATION
F.A.I. 90/94 (DAN RYAN EXPRESSWAY)
63rd ST TO 59th ST (SIDEWALKS & DRIVEWAYS)

**EXISTING AND PROPOSED ROADWAY PLANS
WENTWORTH AVENUE**

SCALE: 1"=20'
DATE: MARCH 04, 2005

DRAWN BY: JB
CHECKED BY: RMG

CTE ENGINEERS
CONSOER TOWNSEND ENVIRONMENTAL ENGINEERS, INC.
303 EAST WACKER DRIVE, SUITE 600
CHICAGO, ILLINOIS 60601-5202, PHONE: (312) 938-0300