

F.A.I. NO.	SECTION	COUNTY	TOTAL SHEETS	SHEET NO.
90/94	2004-094 1	COOK	40	28
STA. 516+50		TO STA. 521+75		
FED. ROAD DIST. NO. 1 ILLINOIS FED. AID PROJECT				

62835

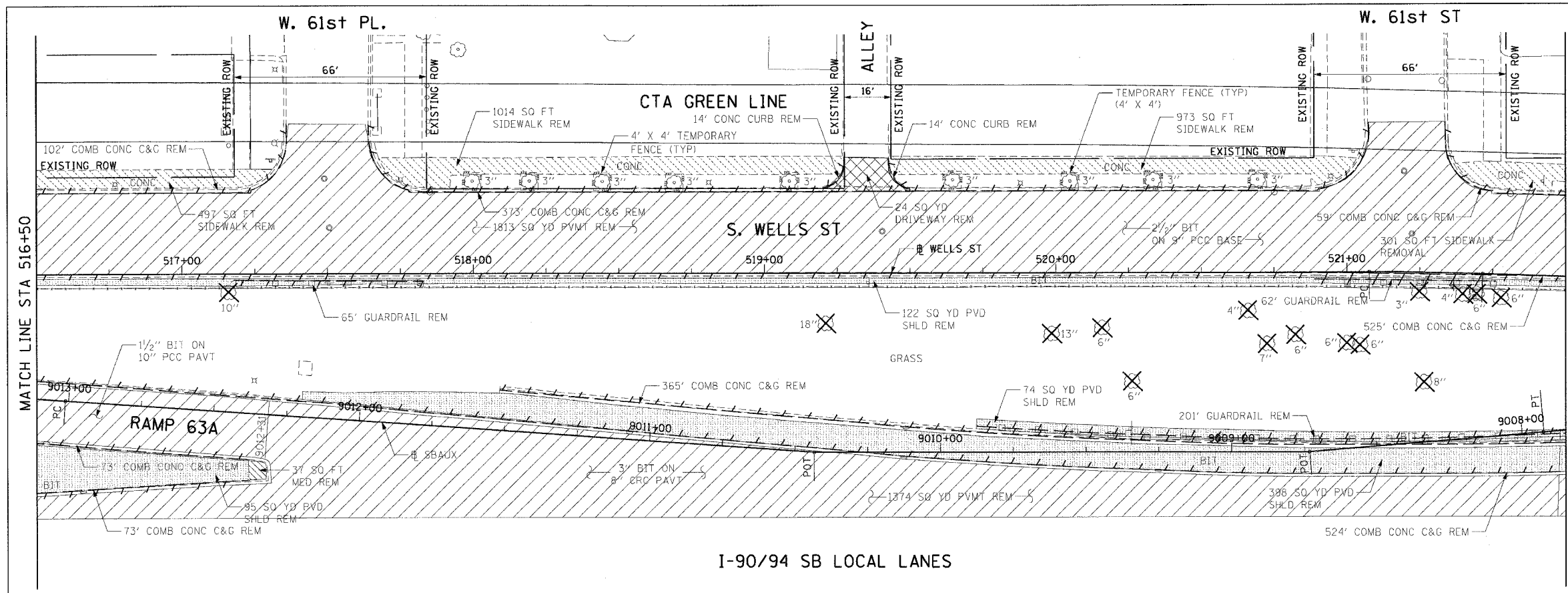

- LEGEND:
- PAVEMENT REMOVAL (BY OTHERS)
 - MEDIAN REMOVAL (BY OTHERS)
 - LINEAR REMOVALS (BY OTHERS)
 - SIDEWALK REMOVAL (BY OTHERS)
 - APPROACH SLAB REMOVAL (BY OTHERS)
 - DRIVEWAY PAVEMENT REMOVAL (BY OTHERS)
 - PAVED SHOULDER REMOVAL (BY OTHERS)
 - TREE REMOVAL (BY OTHERS)

EXISTING CONDITIONS AND REMOVAL
PROPOSED IMPROVEMENTS

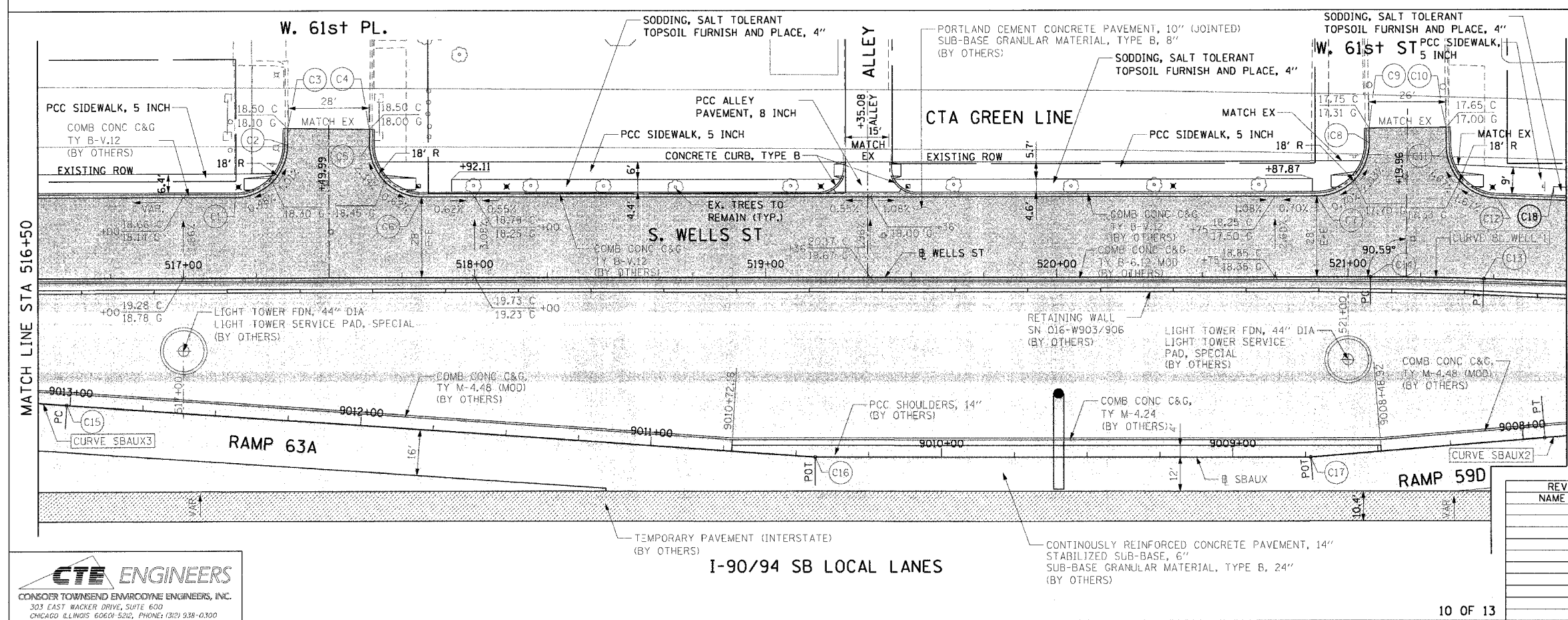

- LEGEND:
- WORK TO BE DONE BY OTHERS
- NOTES:
1. SEE SIDEWALK DETAIL ON SHEET 34.
 2. SEE SIDEWALK RAMP DETAIL ON SHEET 33.
 3. SEE ALLEY DETAIL ON SHEET 36.
 4. SEE CURB DETAIL ON SHEET 33.
 5. THE CONTRACTOR SHALL COORDINATE LOCATIONS REGARDING THE SIGNING (62836) AND CONDUIT & LIGHT POLE FOUNDATION (62842) CONTRACTS.
- | PT. | STATION | OFFSET | LOC |
|-----|------------|-----------|-----|
| C1 | 517+17.83 | 28.00' LT | EOP |
| C2 | 517+35.83 | 45.79' LT | EOP |
| C3 | 517+35.90 | 51.51' LT | EOP |
| C4 | 517+64.03 | 51.18' LT | EOP |
| C5 | 517+63.98 | 46.18' LT | EOP |
| C6 | 517+81.98 | 28.00' LT | EOP |
| C7 | 520+89.33 | 28.00' LT | EOP |
| C8 | 521+07.33 | 46.22' LT | EOP |
| C9 | 521+07.26 | 51.21' LT | EOP |
| C10 | 521+32.61 | 51.80' LT | EOP |
| C11 | 521+32.84 | 45.21' LT | EOP |
| C12 | 521+50.29 | 28.00' LT | EOP |
| C13 | 521+46.63 | 0.00' | EOP |
| C14 | 521+07.69 | 0.00' | EOP |
| C15 | 9013+01.08 | 0.00' | EOP |
| C16 | 9010+13.37 | 0.00' | EOP |
| C17 | 9008+73.17 | 0.00' | EOP |
| C18 | 521+69.58 | 32.55' LT | EOS |

REVISIONS	NAME	DATE

ILLINOIS DEPARTMENT OF TRANSPORTATION
F.A.I. 90/94 (DAN RYAN EXPRESSWAY)
63rd ST TO 59th ST (SIDEWALKS & DRIVEWAYS)

EXISTING AND PROPOSED ROADWAY PLANS
WELLS STREET

SCALE: 1"=20'
DATE: MARCH 04, 2005

DRAWN BY: JB
CHECKED BY: RMG

CTE ENGINEERS
CONSIDER TOWNSEND ENVIRONMENTAL ENGINEERS, INC.
303 EAST WACKER DRIVE, SUITE 600
CHICAGO, ILLINOIS 60601-5202, PHONE: (312) 938-0300

03/01/2005 10:46:05 AM