

F.A.I. RTE.	SECTION	COUNTY	TOTAL SHEETS	SHEET NO.
90/94	2004-094 1	COOK	40	31
STA. 531+75		TO STA. 536+75		
FED. ROAD DIST. NO. 1		ILLINOIS		FED. AID PROJECT

62835

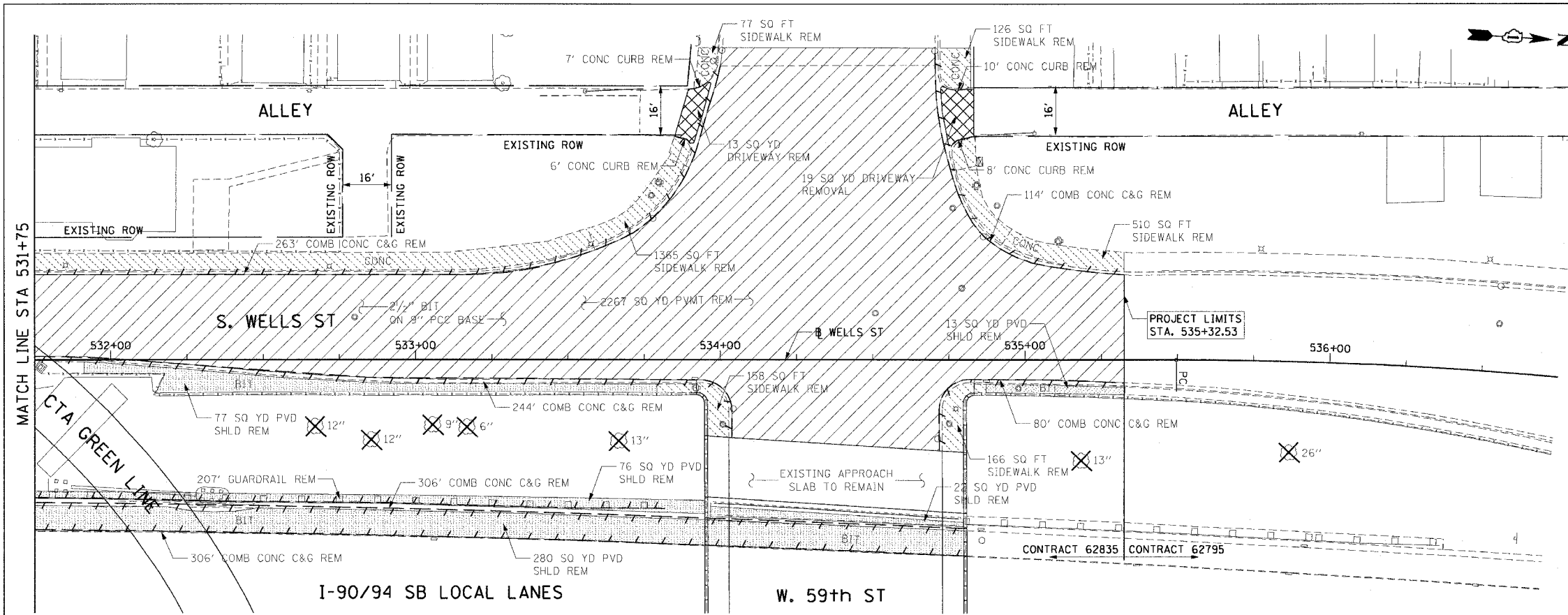

LEGEND:

- PAVEMENT REMOVAL (BY OTHERS)
- MEDIAN REMOVAL (BY OTHERS)
- LINEAR REMOVALS (BY OTHERS)
- SIDEWALK REMOVAL (BY OTHERS)
- APPROACH SLAB REMOVAL (BY OTHERS)
- DRIVEWAY PAVEMENT REMOVAL (BY OTHERS)
- PAVED SHOULDER REMOVAL (BY OTHERS)
- TREE REMOVAL (BY OTHERS)

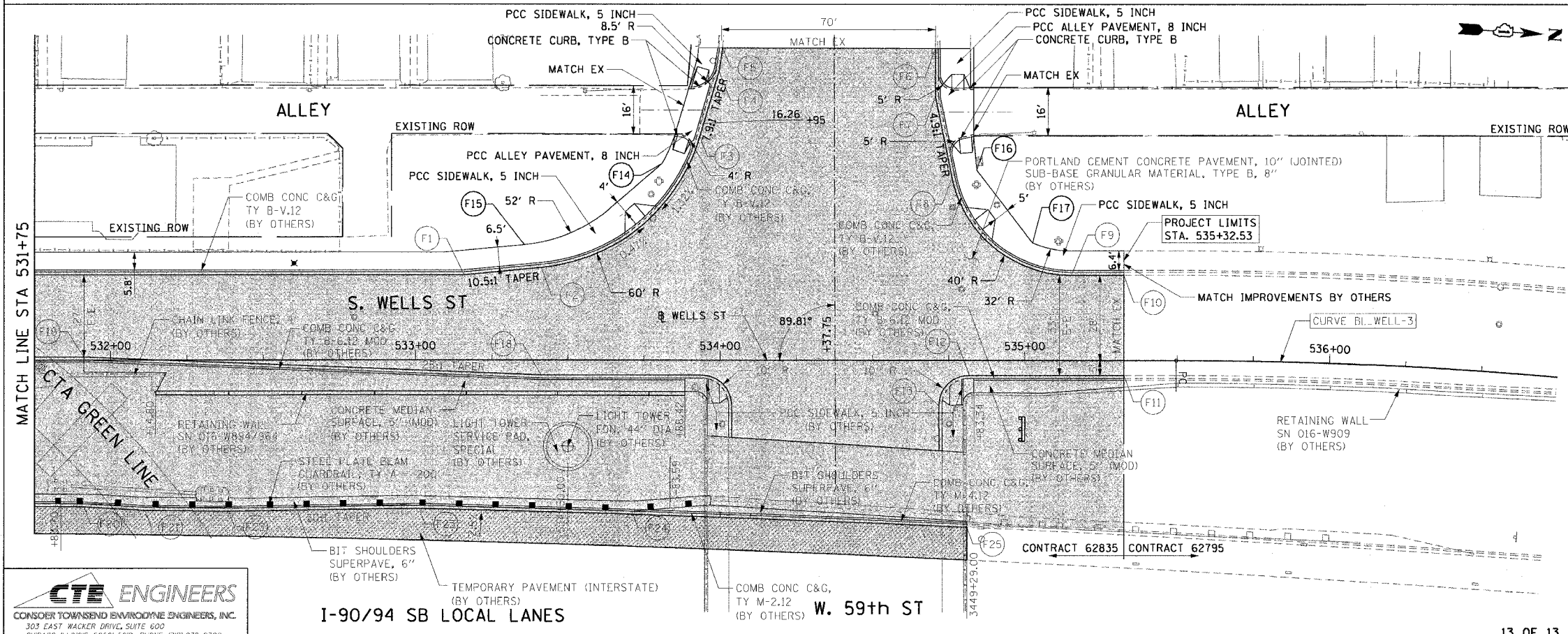

EXISTING CONDITIONS AND REMOVAL

LEGEND: PROPOSED IMPROVEMENTS

- WORK TO BE DONE BY OTHERS
- NOTES:
1. SEE SIDEWALK DETAIL ON SHEET 34.
  2. SEE SIDEWALK RAMP DETAIL ON SHEET 33.
  3. SEE ALLEY DETAIL ON SHEET 36.
  4. SEE CURB DETAIL ON SHEET 32.
  5. THE CONTRACTOR SHALL COORDINATE LOCATIONS REGARDING THE SIGNING (62836) AND CONDUIT & LIGHT POLE FOUNDATION (62842) CONTRACTS.

PT.	STATION	OFFSET	LOC	PT.	STATION	OFFSET	LOC
F1	533+15.89	28.00'	LT	EOP	F14	530+80.90	64.48' LT SW
F2	533+41.34	30.41'	LT	EOP	F15	533+35.76	37.97' LT SW
F3	533+93.29	73.38'	LT	EOP	F16	534+84.23	62.46' LT SW
F4	533+99.60	95.04'	LT	EOP	F17	535+02.52	38.66' LT SW
F5	534+00.83	102.80'	LT	EOP	F18	533+41.26	5.00' RT EOP
F6	534+70.67	102.68'	LT	EOP	F19	531+91.26	1.00' LT EOP
F7	534+70.65	86.84'	LT	EOP	F20	3446+40.35	37.16' LT EOP
F8	534+76.09	60.04'	LT	EOP	F21	3446+60.24	36.12' LT EOP
F9	535+15.29	28.00'	LT	EOP	F22	3446+87.56	36.01' LT EOP
F10	535+32.53	28.00'	LT	EOP	F23	3447+49.73	37.91' LT EOP
F11	535+32.53	5.00'	RT	EOP	F24	3448+19.13	38.79' LT GR
F12	534+81.80	5.00'	RT	EOP	F25	3449+28.51	37.78' LT EOP
F13	534+71.80	15.03'	RT	EOP			

REVISIONS	
NAME	DATE

ILLINOIS DEPARTMENT OF TRANSPORTATION  
 F.A.I. 90/94 (DAN RYAN EXPRESSWAY)  
 63rd ST TO 59th ST (SIDEWALKS & DRIVEWAYS)  
 EXISTING AND PROPOSED ROADWAY PLANS  
 WELLS STREET

SCALE: 1"=20'  
 DATE: MARCH 04, 2005

DRAWN BY: JB  
 CHECKED BY: RMG



03/01/2005 10:46:11 AM