

F.A.U. RTE.	SECTION	COUNTY	TOTAL SHEETS	N.
1238	2004-125 TS	LAKE	18	18
STA.	TO STA.			
FED. ROAD DIST. NO.	ILLINOIS	FED. AID PROJECT		
CONTRACT NO. 62890				

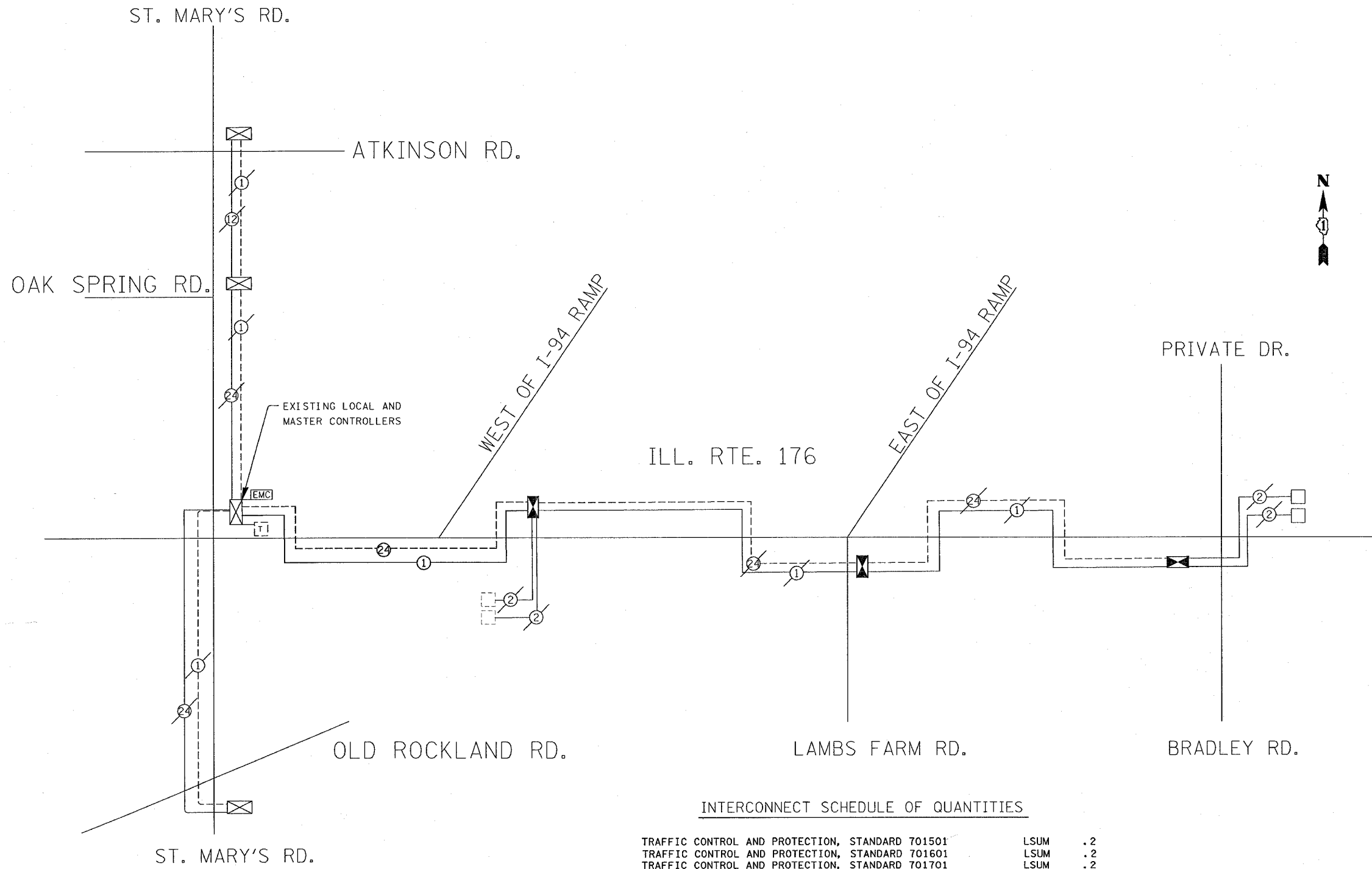

INTERCONNECT SCHEMATIC LEGEND

- EXISTING INTERSECTION CONTROLLER ☒
- PROPOSED INTERSECTION CONTROLLER ☒
- EXISTING MASTER CONTROLLER EMC
- PROPOSED MASTER CONTROLLER MC
- MASTER MASTER CONTROLLER MMC
- EXISTING INTERSECTION & SAMPLING (SYSTEM) DETECTORS ☐
- PROPOSED INTERSECTION & SAMPLING (SYSTEM) DETECTORS ☐
- EXISTING INTERSECTION LOOP DETECTORS P
- PROPOSED SAMPLING (SYSTEM) DETECTORS P
- EXISTING SAMPLING (SYSTEM) DETECTORS ES
- PROPOSED SAMPLING (SYSTEM) DETECTORS PS
- EXISTING SAMPLING (SYSTEM) DETECTORS, PROPOSED INTERSECTION AND SAMPLING (SYSTEM) DETECTORS. ESP
- EXISTING SAMPLING (SYSTEM) DETECTORS, PROPOSED SAMPLING (SYSTEM) DETECTORS. ESPS
- EXISTING PREFORMED INTERSECTION & SAMPLING (SYSTEM) DETECTORS PDI
- PROPOSED PREFORMED INTERSECTION & SAMPLING (SYSTEM) DETECTORS PD
- EXISTING SAMPLING (SYSTEM) PREFORMED DETECTORS ESPD
- PROPOSED SAMPLING (SYSTEM) PREFORMED DETECTORS PSPD
- EXISTING FIBER OPTIC CABLE IN CONDUIT, NO. 62.5/125, MM12F SM12F 24
- PROPOSED FIBER OPTIC CABLE IN CONDUIT, NO. 62.5/125, MM12F SM12F 24
- EXISTING INTERCONNECT CABLE - NO. 62.5/125 12F FIBER OPTIC CABLE 12
- PROPOSED INTERCONNECT CABLE - NO. 62.5/125 12F FIBER OPTIC CABLE 12
- EXISTING INTERCONNECT CABLE - NO. 18 3 PAIR TWISTED, SHIELDED 6
- PROPOSED INTERCONNECT CABLE - NO. 18 3 PAIR TWISTED, SHIELDED 6
- EXISTING LOOP DETECTOR CABLE 2/C TWISTED, SHIELDED 2
- PROPOSED LOOP DETECTOR CABLE 2/C TWISTED, SHIELDED 2
- EXISTING ELECTRIC CABLE, 1/C (AS SPECIFIED) 1
- PROPOSED ELECTRIC CABLE, 1/C (AS SPECIFIED) 1
- EXISTING TELEPHONE CONNECTION T
- PROPOSED TELEPHONE CONNECTION T



INTERCONNECT SCHEDULE OF QUANTITIES

TRAFFIC CONTROL AND PROTECTION, STANDARD 701501	LSUM	.2
TRAFFIC CONTROL AND PROTECTION, STANDARD 701601	LSUM	.2
TRAFFIC CONTROL AND PROTECTION, STANDARD 701701	LSUM	.2
TRAFFIC CONTROL AND PROTECTION, STANDARD 701801	LSUM	.2
CONDUIT IN TRENCH, 2" DIA. GALVANIZED STEEL	FOOT	2380
CONDUIT IN PUSHED, 2" DIA. GALVANIZED STEEL	FOOT	120
HEAVY-HANDHOLE	EACH	4
TRENCH AND BACK FILL FOR ELECTRICAL WORK	FOOT	2380
DRILL EXISTING HANDHOLES	EACH	2
FIBER OPTIC CABLE IN CONDUIT, NO. 62.5/125, MM12F SM12F	FOOT	3230
ELECTRIC CABLE IN CONDUIT TRACER NO. 14 1C	FOOT	3230

REVISIONS	
NAME	DATE

ILLINOIS DEPARTMENT OF TRANSPORTATION

**ILL. RTE. 176
ST. MARY'S RD TO BRADLEY RD.
INTERCONNECT SCHEMATIC**

SCALE: NONE
DATE: 01-05-2005

DRAWN BY: SM
DESIGNED BY: SM
CHECKED BY: DAD

1 4310/13M 06/05/2005