

Benchmarks: BM 3550 Set "+" westerly flange bolt of hydrant at southwest intersection of 91st St. and Lafayette Ave. El. 22.88

Existing Structure: None

F.A.I. RTE.	SECTION	COUNTY	TOTAL SHEETS	SHEET NO.
94	*	COOK	36	12
STA. 1200+00.00 TO STA. 1330+00.00				
FED. ROAD DIST. NO. ILLINOIS		FED. AID PROJECT		
*(1516.1, 1717 & 1818) I-2		62931		

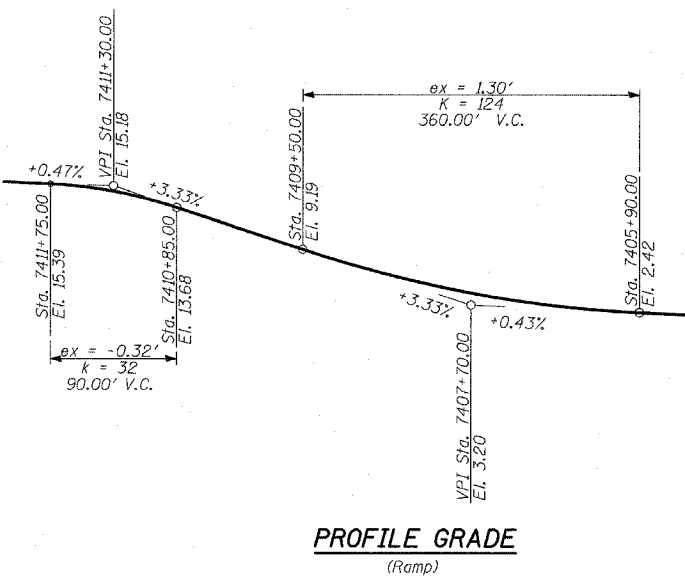
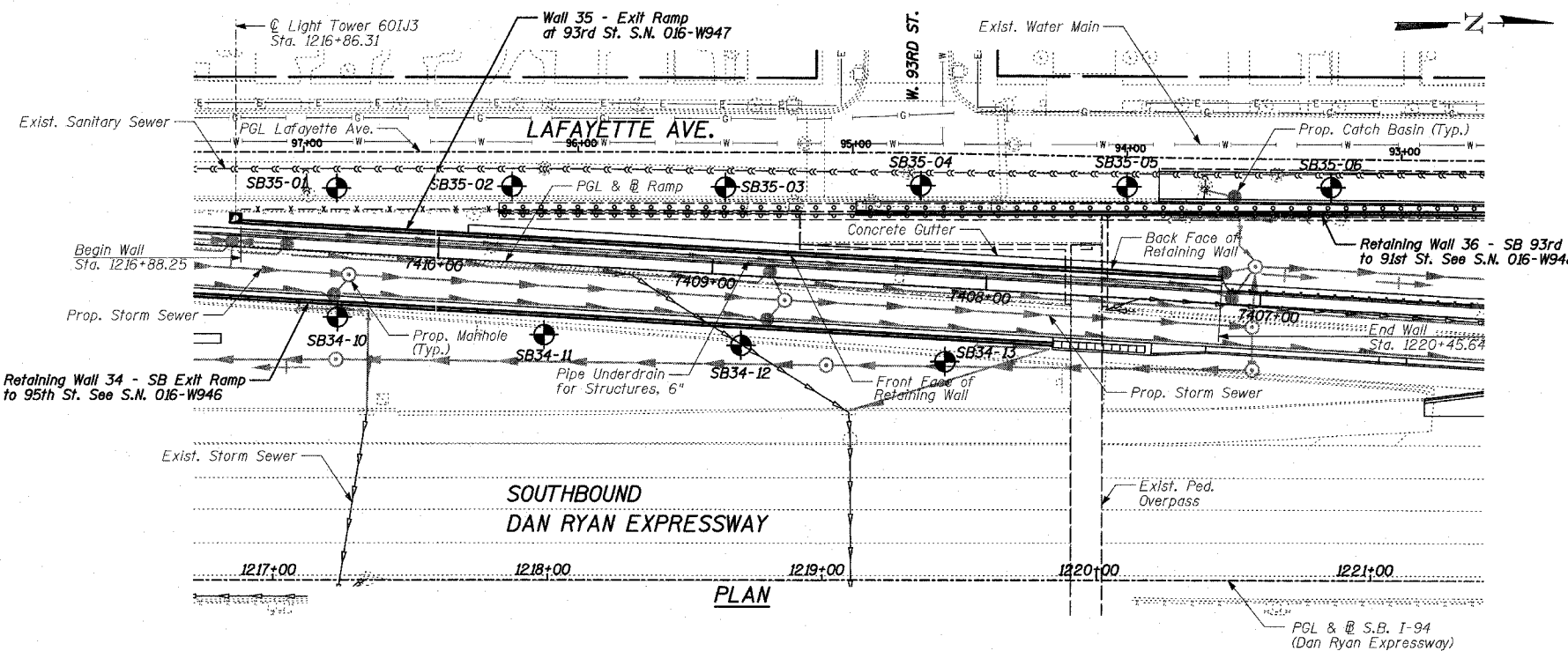
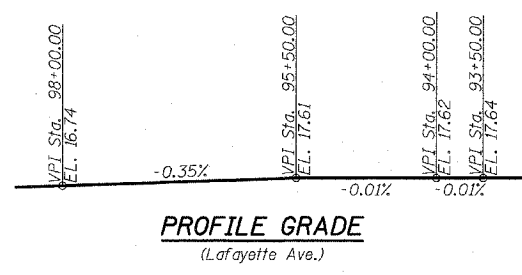
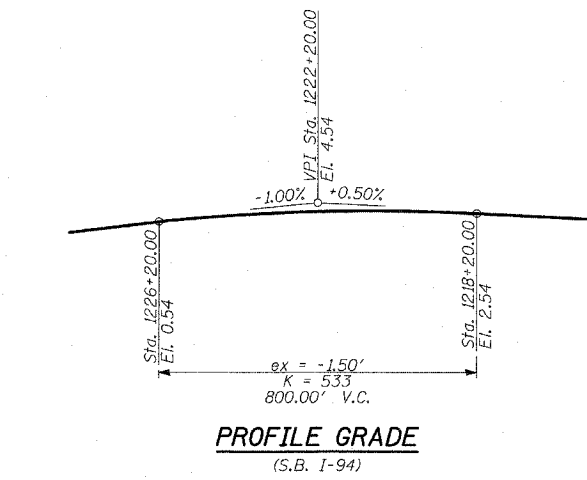
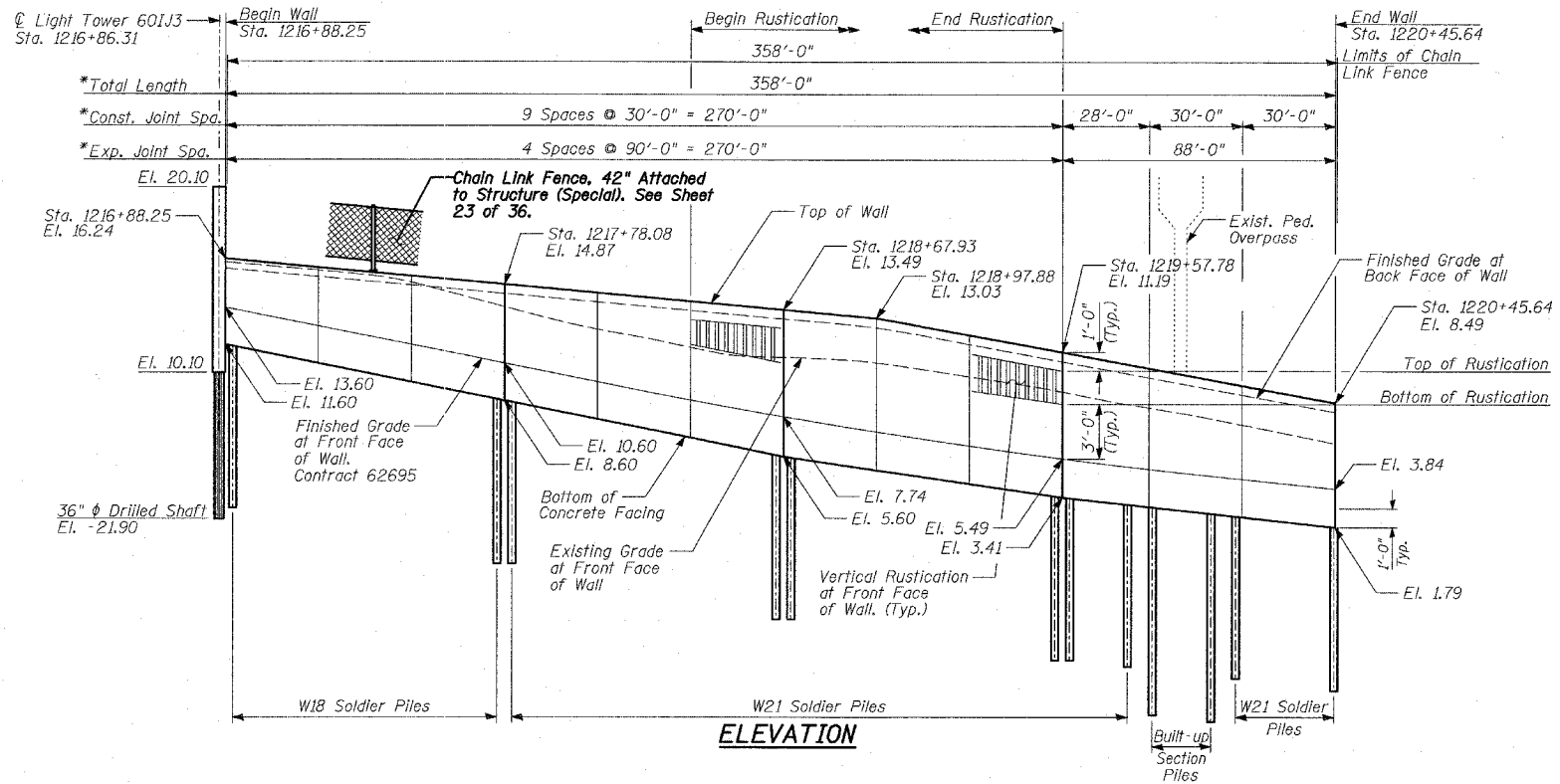

DESIGN SPECIFICATION
AASHTO 2002 Standard Specifications for Highway Bridges

DESIGN STRESSES
FIELD UNITS
f'c = 3,500 psi
fy = 60,000 psi (Reinforcement)
fy = 36,000 psi (M270 Grade 36) Soldier Piles

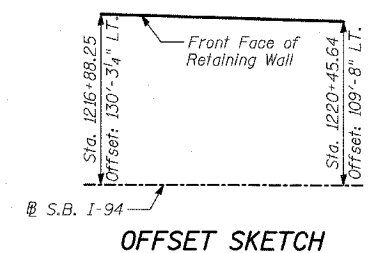

LEGEND
 Boring Location
 * Measured along Front Face of Wall.

TYLIN INTERNATIONAL

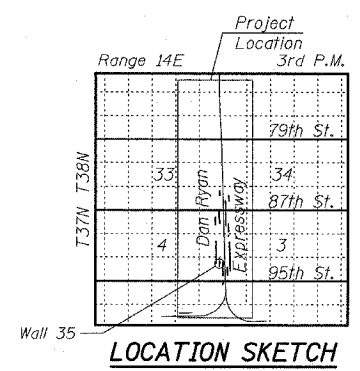

REVISIONS	
NAME	DATE

ILLINOIS DEPARTMENT OF TRANSPORTATION
F.A.I. 94 (DAN RYAN EXPRESSWAY)
RETAINING WALL ALONG LAFAYETTE AVE.
EXIT RAMP AT 93RD ST.
WALL 35 - GENERAL PLAN
STA. 1216+88.25 TO STA. 1220+45.64
 S.N. 016-W947
 SCALE: N.T.S.
 DATE: APRIL 15, 2005
 DESIGNED BY: MI, MAF
 DRAWN BY: MAF, TB
 CHECKED BY: TD, MI

1/14/2005 7:17:24 AM