

Benchmarks: BM 3550 Set "+" westerly flange bolt of hydrant at southwest intersection of 91st St. and Lafayette Ave. El. 22.88

Existing Structure: Reinforced concrete cantilever retaining wall, supported on concrete pile footings, along East edge of Lafayette Avenue, at 93rd St. Built in 1960. Total length ±450'-6".**
Reinforced concrete cantilever retaining wall, supported on concrete pile footings, along East edge of Lafayette Avenue, at 91st St. Built in 1960. Total length ±240'.

Salvage: None.

F.A.I. RTE.	SECTION	COUNTY	TOTAL SHEETS	SHEET NO.
94		COOK	36	13
STA. 1200+00.00		TO STA. 1330+00.00		
FED. ROAD DIST. NO.		ILLINOIS FED. AID PROJECT		
(1516.1, 1717 & 1818) I-2				62931

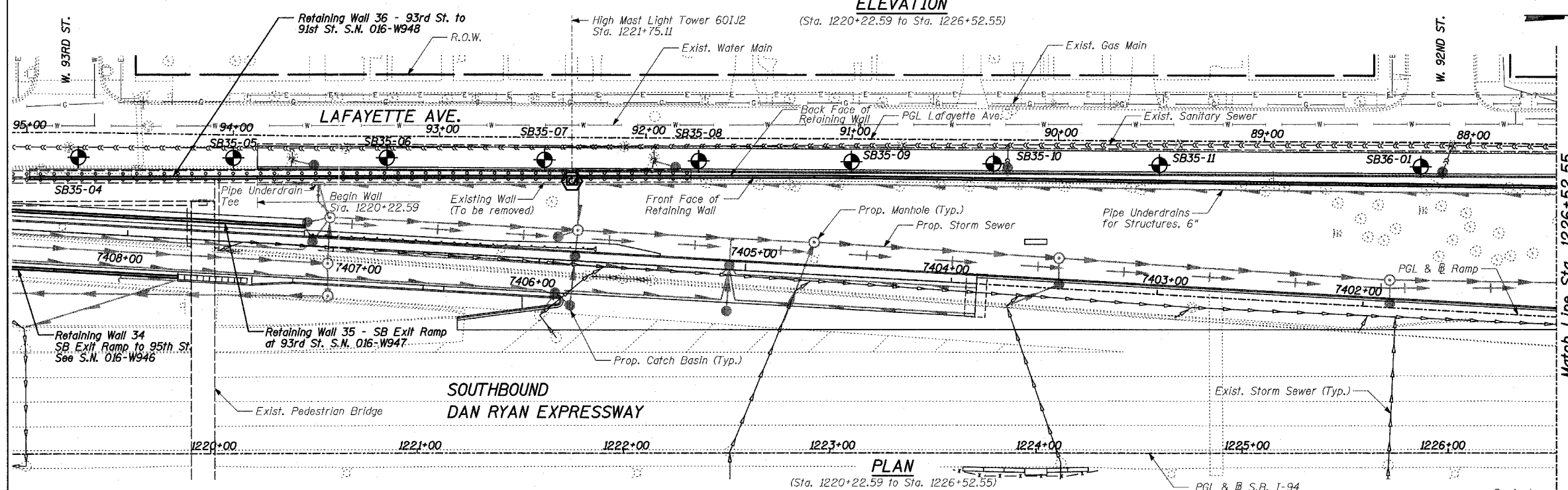
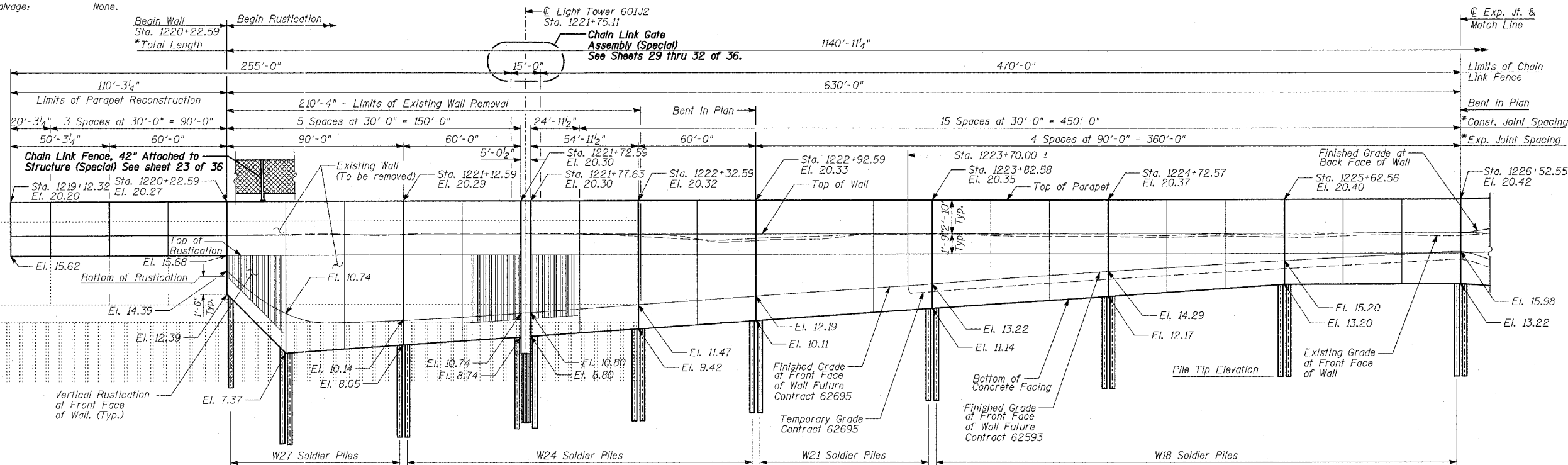

Match Line Sta. 1226+52.55

DESIGN SPECIFICATION
 AASHTO 2002 Standard Specifications for Highway Bridges

DESIGN STRESSES
FIELD UNITS
 f'c = 3,500 psi
 fy = 60,000 psi (Reinforcement)
 fy = 36,000 psi (M270 Grade 36) Soldier Piles

LEGEND

- Boring Location
- * Measured along Front Face of Wall.
- ** Portions of existing walls to be removed to accommodate proposed wall.

TYLIN INTERNATIONAL

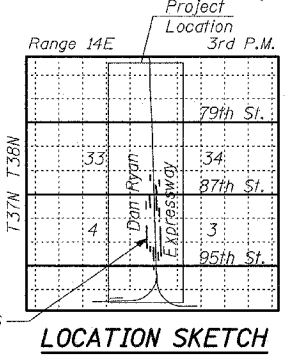
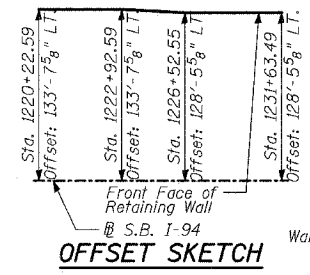

REVISIONS	
NAME	DATE

ILLINOIS DEPARTMENT OF TRANSPORTATION
F.A.I. 94 (DAN RYAN EXPRESSWAY)
RETAINING WALL ALONG LAFAYETTE AVE.
93RD ST. TO 91ST ST.
WALL 36 - GENERAL PLAN
 STA. 1220+22.59 TO STA. 1231+63.49
 S.N. 016-W948
 SCALE: N.T.S.
 DATE: APRIL 15, 2005

DESIGNED BY: MI, DJR
 DRAWN BY: DJR, TB
 CHECKED BY: TD, MI

4/14/2005 7:17:31 AM