

Benchmarks: BM 3550 Set "A" westerly flange bolt of hydrant at southwest intersection of 91st St. and Lafayette Ave. El. 22.88

Existing Structure: Reinforced concrete cantilever retaining wall, supported on concrete pile footings, along Southbound Dan Ryan, East edge of Lafayette Avenue, 91ST Street to CRI&P RR. Built in 1960. Total length ±137'±±

Salvage: None.

F.A.I. RTE.	SECTION	COUNTY	TOTAL SHEETS	SHEET NO.
94		COOK	36	15
STA. 1200+00.00 TO STA. 1330+00.00		FED. ROAD DIST. NO. ILLINOIS FED. AID PROJECT		
• (1516.1, 1717 & 1818) I-2				62931

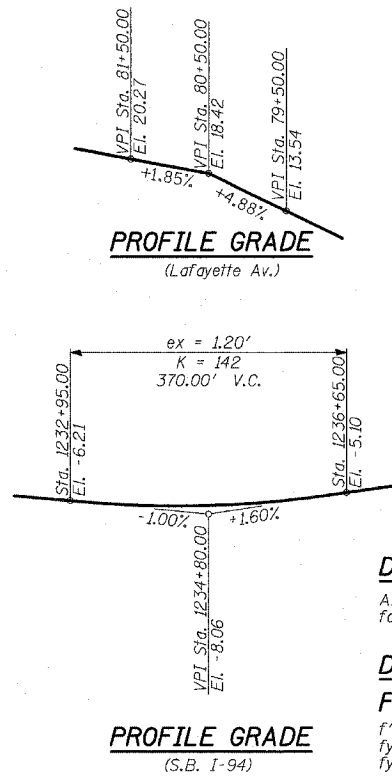
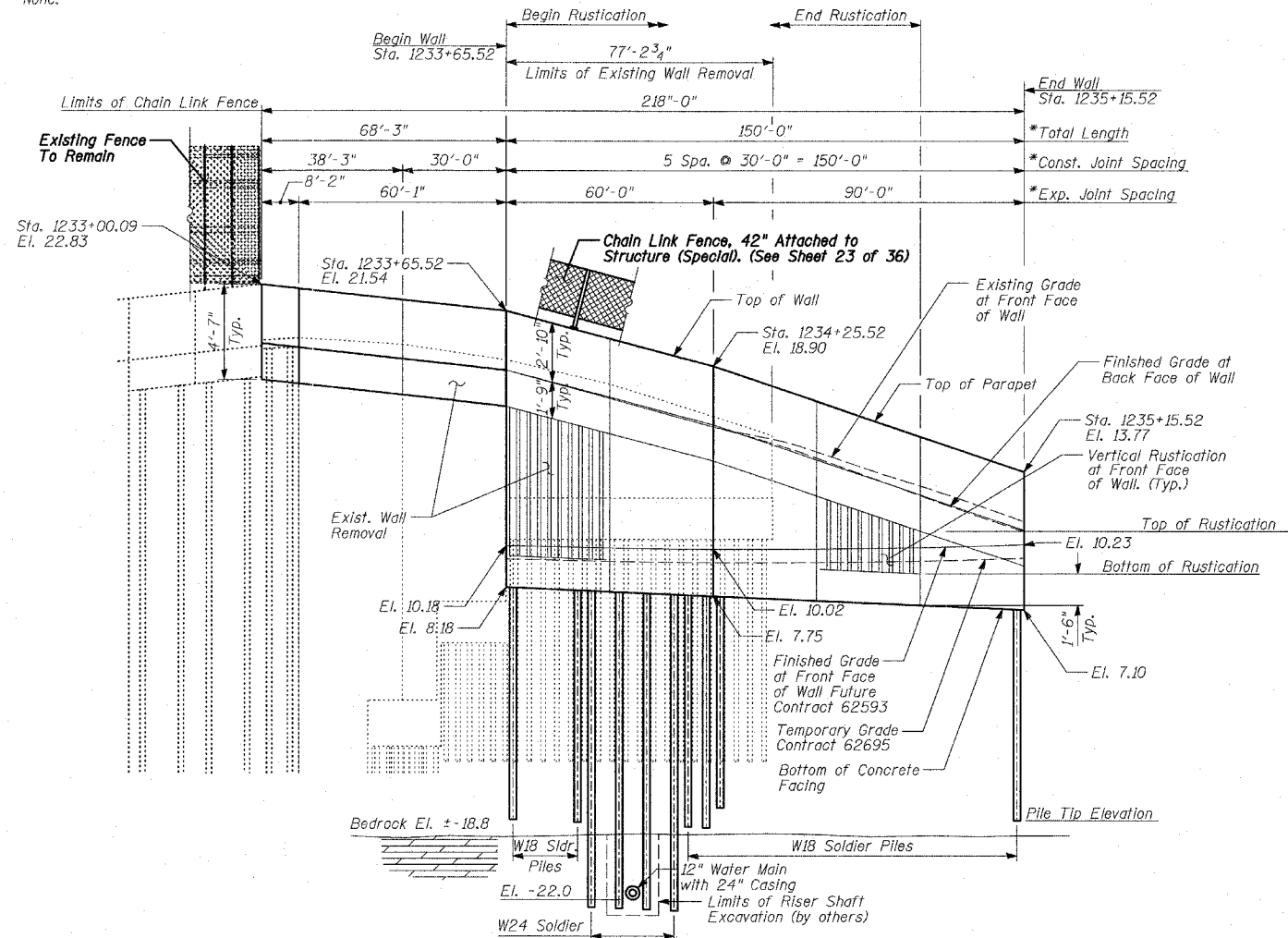

DESIGN SPECIFICATION

AASHTO 2002 Standard Specifications for Highway Bridges

DESIGN STRESSES

FIELD UNITS

f'_c = 3,500 psi
 f_y = 60,000 psi (Reinforcement)
 f_y = 36,000 psi (M270 Grade 36)
 Soldier Piles

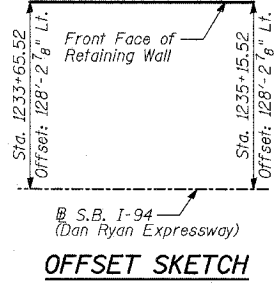
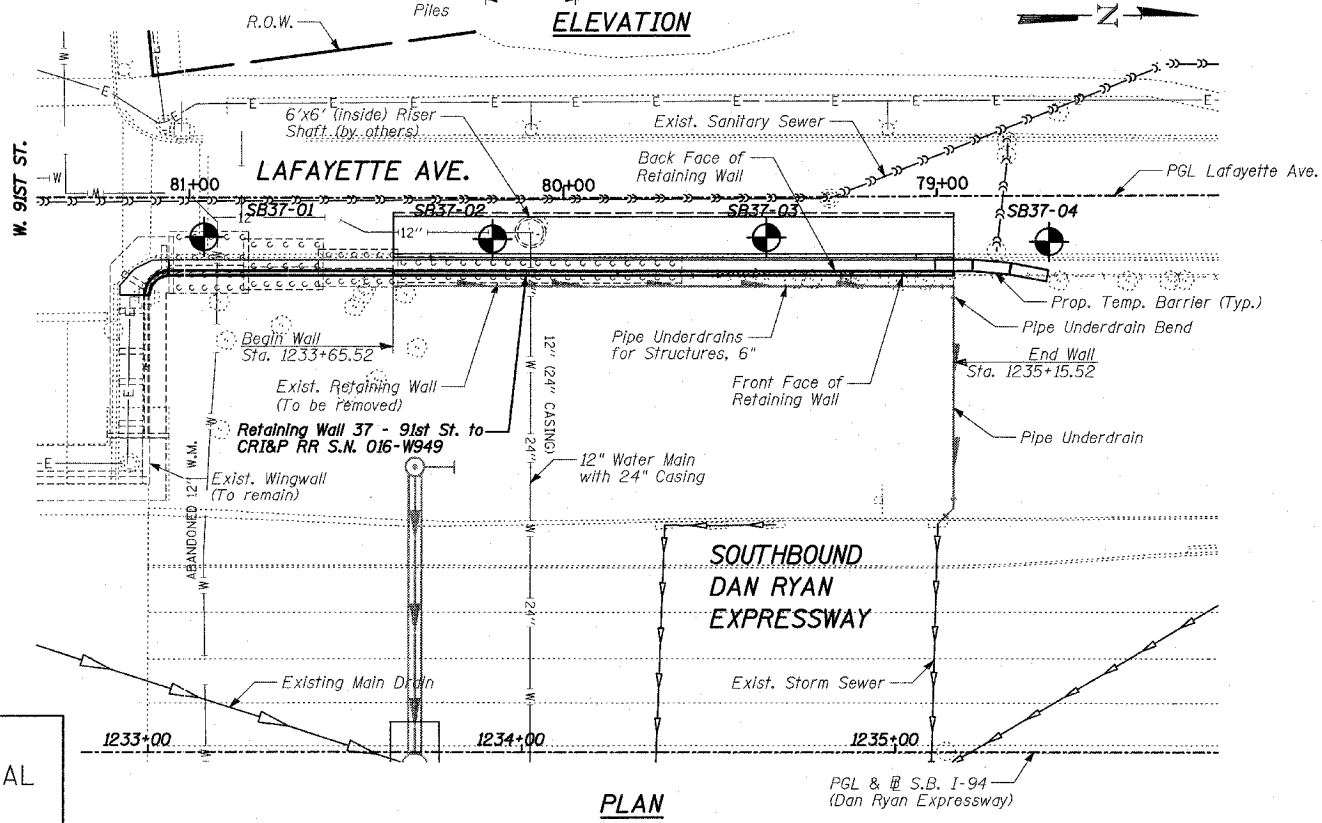

- LEGEND**
- ⊕ Boring Location
 - * Measured along Front Face of Wall.
 - ** Portions of existing walls to be removed to accommodate proposed walls.

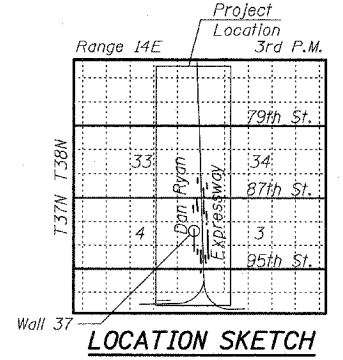

REVISIONS	
NAME	DATE

ILLINOIS DEPARTMENT OF TRANSPORTATION
 F.A.I. 94 (DAN RYAN EXPRESSWAY)
 RETAINING WALL ALONG LAFAYETTE AVE.
 91ST ST. TO CRI&P RR
 WALL 37 - GENERAL PLAN
 STA. 1233+65.52 TO STA. 1235+15.52
 S.N. 016-W949
 SCALE: N.T.S.
 DATE: APRIL 15, 2005

DESIGNED BY: MI, DJR
 DRAWN BY: DJR, TB
 CHECKED BY: TD, MI

TYLIN INTERNATIONAL

4/14/2005 7:46 AM