

Benchmarks: BM 3549 Set "+" westerly flange bolt of hydrant at southwest intersection of 87th St. and Lafayette Ave. El. 9.49

F.A.I. RTE.	SECTION	COUNTY	TOTAL SHEETS	SHEET NO.
94		COOK	36	17
STA. 1200+00.00		TO STA. 1330+00.00		
FED. ROAD DIST. NO.		ILLINOIS FED. AID PROJECT		
(1516.1, 1717 & 1818) I-2				62931

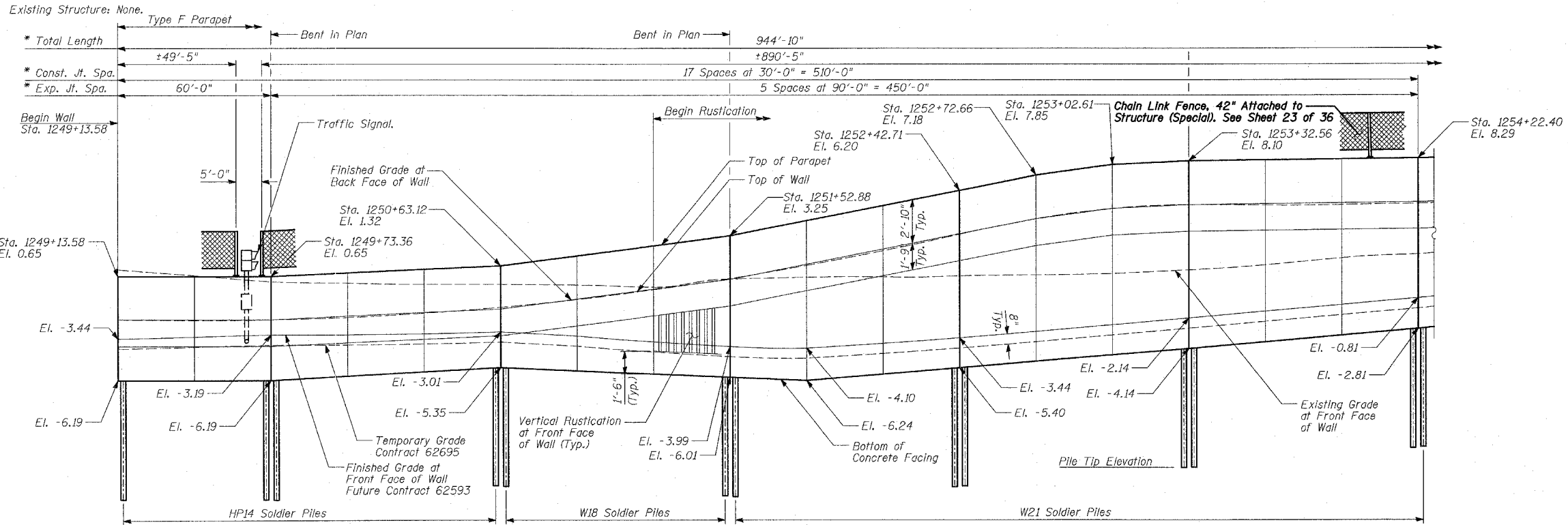

DESIGN SPECIFICATION
AASHTO 2002 Standard Specifications for Highway Bridges

DESIGN STRESSES
FIELD UNITS
 $f'_c = 3,500$ psi
 $f_y = 60,000$ psi (Reinforcement)
 $f_y = 36,000$ psi (M270 Grade 36) Soldier Piles

LOADING
Max. Soil Pressure Under Footing = 700 psf

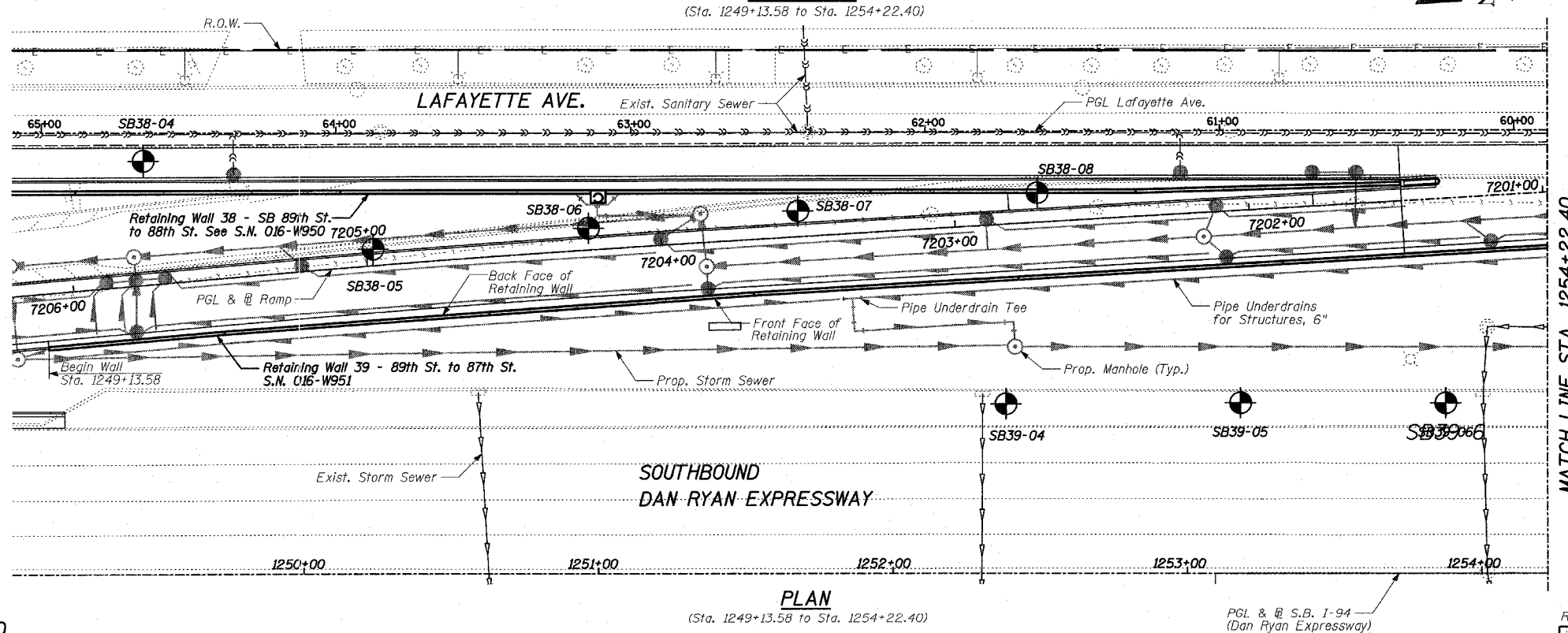

LEGEND
 ◉ Boring Location
 * Measured along Front Face of Wall.

TYLIN INTERNATIONAL

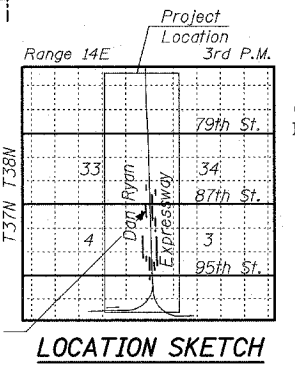

REVISIONS	
NAME	DATE

ILLINOIS DEPARTMENT OF TRANSPORTATION
 F.A.I. 94 (DAN RYAN EXPRESSWAY)
 RETAINING WALL ALONG LAFAYETTE AVE.
 89TH ST. TO 87TH ST.
 WALL 39 - GENERAL PLAN
 STA. 1249+13.58 TO STA. 1254+22.40
 S.N. 016-W951
 SCALE: N.T.S.
 DATE: APRIL 15, 2005

DESIGNED BY: MI, TB
 DRAWN BY: DJR, TB
 CHECKED BY: TD, MI

4/17/2005 7:17:58 AM