

Benchmarks: BM 3810 Cut square on southerly corner of metal base for overhead sign, on the westerly side of southbound Dan Ryan, opposite of West 77th Place, approximately 1000 feet north of 79th Street bridge. Elev. 0.29 feet.
 Existing Structure: None.

F.A.I. RTE.	SECTION	COUNTY	TOTAL SHEETS	SHEET NO.
94		COOK	36	21
STA. 1200+00.00 TO STA. 1330+00.00		ILLINOIS FED. AID PROJECT		
FED. ROAD DIST. NO.		(1516, 1717 & 1818) 1-2		
				62931

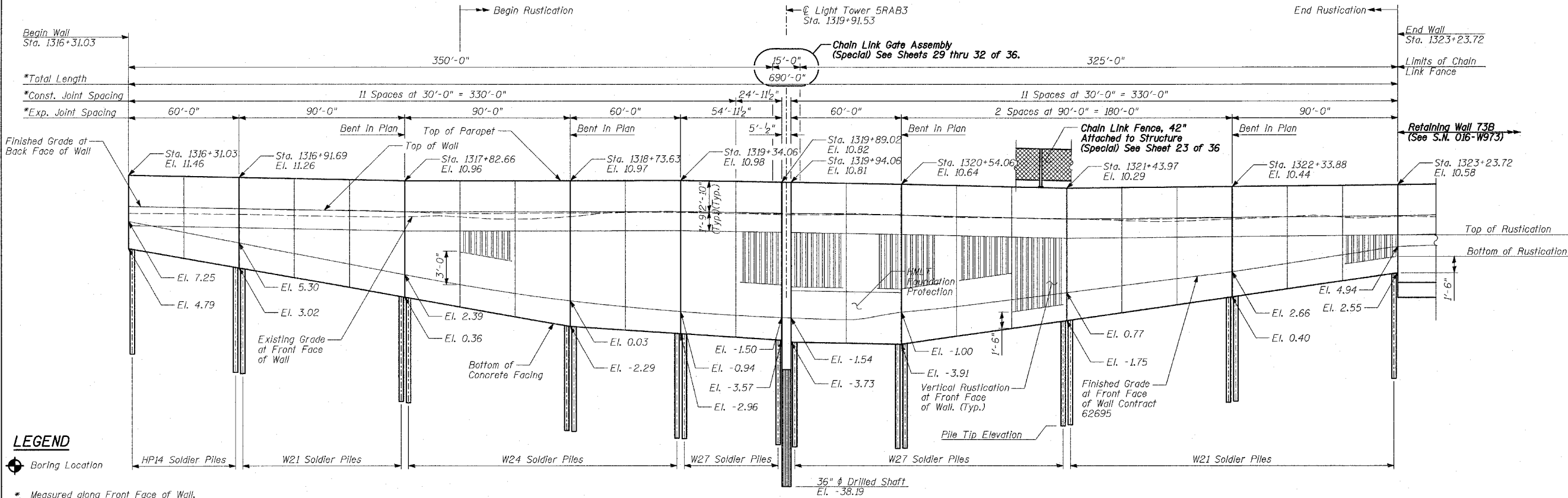

LEGEND
 Boring Location
 * Measured along Front Face of Wall.

DESIGN SPECIFICATION
 AASHTO 2002 Standard Specifications for Highway Bridges
DESIGN STRESSES
FIELD UNITS
 f'c = 3,500 psi
 fy = 60,000 psi (Reinforcement)
 fy = 36,000 psi (M270 Grade 36) Solder Piles

ELEVATION

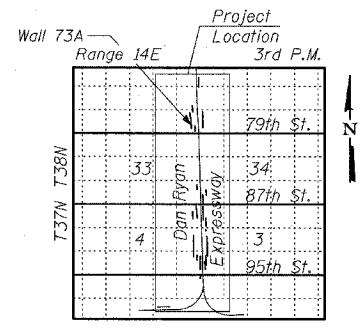
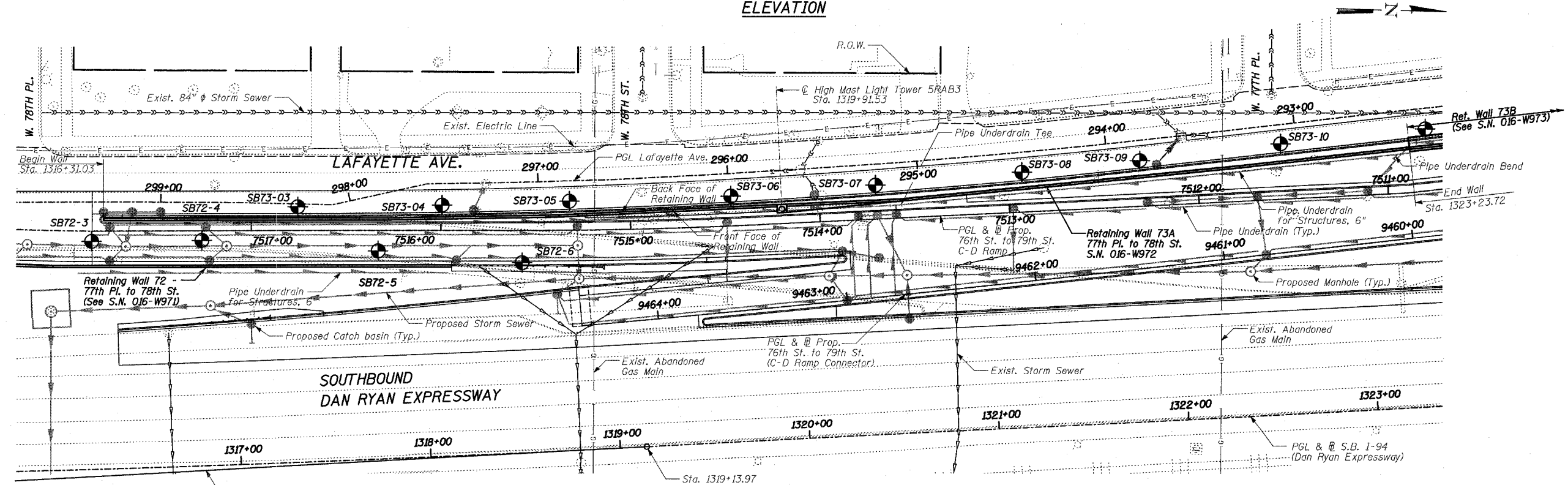

LOCATION SKETCH

PLAN

TYLIN INTERNATIONAL

REVISIONS	
NAME	DATE

ILLINOIS DEPARTMENT OF TRANSPORTATION
 F.A.I. 94 (DAN RYAN EXPRESSWAY)
 RETAINING WALL ALONG LAFAYETTE AVE.
 77TH PL. TO 78TH ST.
 WALL 73A - GENERAL PLAN
 STA. 1316+31.03 TO STA. 1327+23.72
 S.N. 016-W972 DESIGNED BY: MI, DJR
 SCALE: N.T.S. DRAWN BY: DJR, MAF
 DATE: APRIL 15, 2005 CHECKED BY: TD, MI

7/14/2005 7:48:21 AM