

F.A.I. RTE.	SECTION	COUNTY	TOTAL SHEETS	SHEET NO.
94		COOK	29	12
STA. 2200+00.00		TO STA. 2362+00.00		
FED. ROAD DIST. NO.		ILLINOIS FED. AID PROJECT		
		(1516.1, 1717 & 1818) T-1		62935

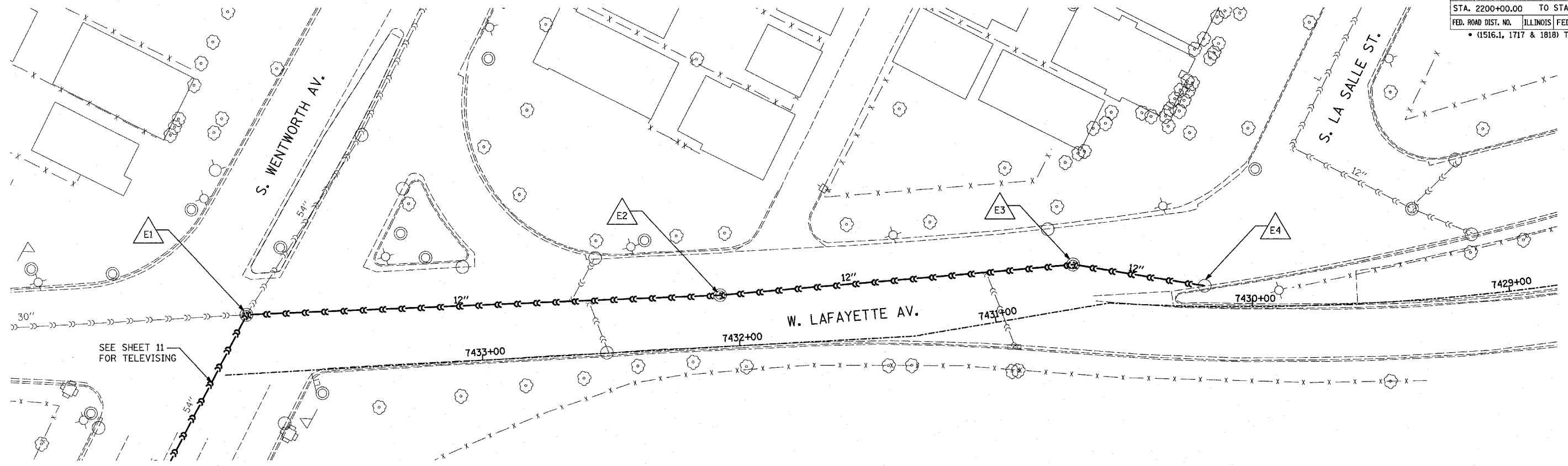

SEE SHEET 11 FOR TELEVISIONING

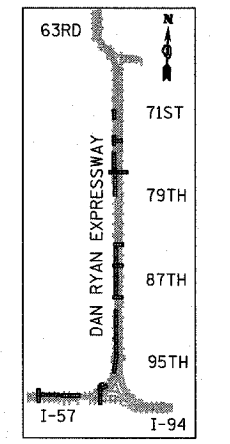

LOCATION MAP

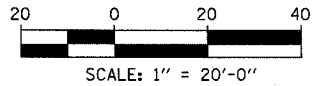

**LEGEND:**

- EXISTING COMBINED SEWER
- EXISTING COMBINED SEWER TO BE TELEVIEWED
- △ XY MANHOLE STRUCTURE NO.

REVISIONS	
NAME	DATE

ILLINOIS DEPARTMENT OF TRANSPORTATION  
 F.A.I. 94 (DAN RYAN EXPRESSWAY)  
**SEWER TELEVISIONING  
 W. LAFAYETTE AVE.**  
 SCALE: 1"=20'-0"  
 DATE: APRIL 15, 2005  
 DRAWN BY: DE  
 CHECKED BY: TGB

**TYLIN** INTERNATIONAL