

| | | | | |
|---------------------|---------|-----------------------------|--------------|-----------|
| F.A.I. RTE. | SECTION | COUNTY | TOTAL SHEETS | SHEET NO. |
| 94 | | COOK | 29 | 15 |
| STA. 2200+00.00 | | TO STA. 2362+00.00 | | |
| FED. ROAD DIST. NO. | | ILLINOIS FED. AID PROJECT | | |
| | | • (1516.1, 1717 & 1818) T-1 | | |
| | | | | 62935 |

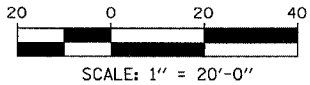
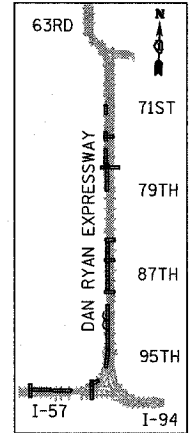
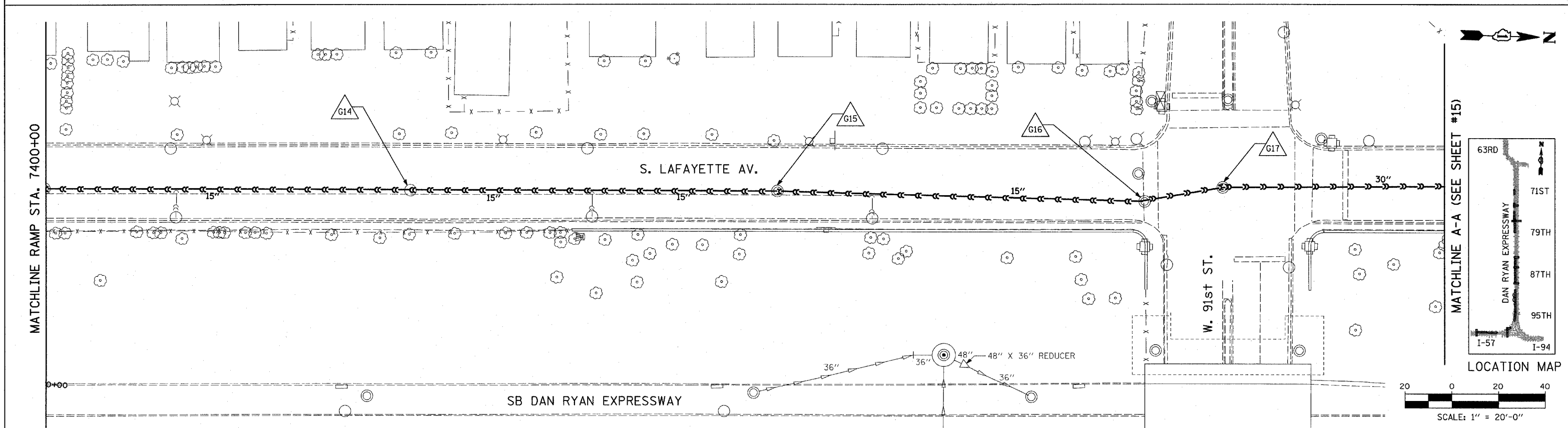
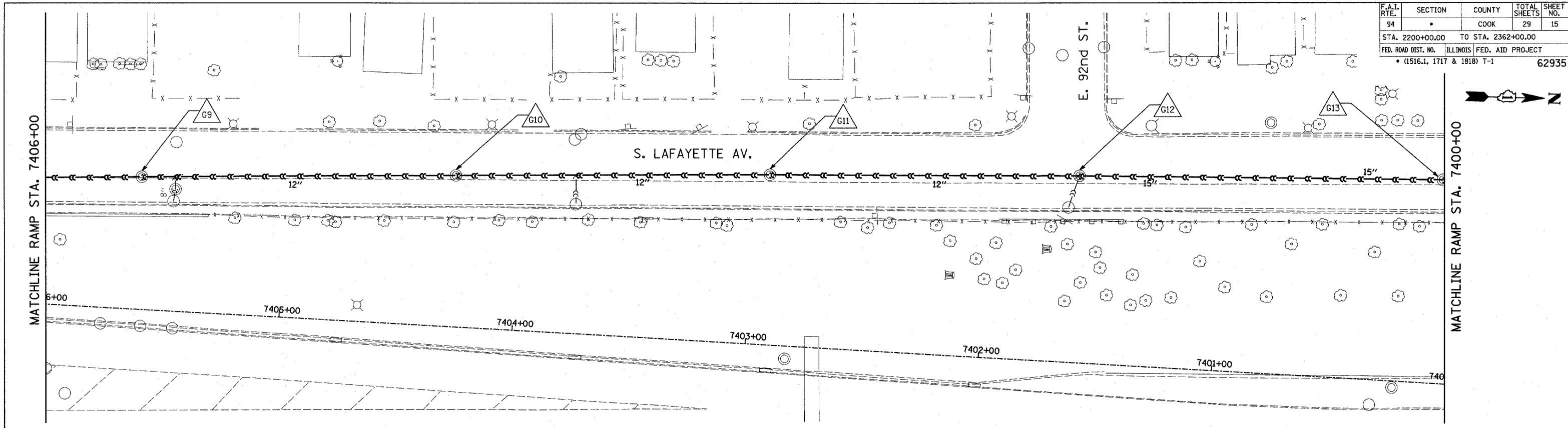

- LEGEND:**
- — — — — EXISTING COMBINED SEWER
 - — — — — EXISTING COMBINED SEWER TO BE TELEVISED
 - △ XY MANHOLE STRUCTURE NO.

| REVISIONS | |
|-----------|------|
| NAME | DATE |
| | |
| | |
| | |
| | |
| | |
| | |
| | |
| | |

ILLINOIS DEPARTMENT OF TRANSPORTATION
 F.A.I. 94 (DAN RYAN EXPRESSWAY)
**SEWER TELEVISIONING
 S. LAFAYETTE AVE.**

SCALE: 1"=20'-0"
 DATE: APRIL 15, 2005

DRAWN BY: DE
 CHECKED BY: TGB

TYLIN INTERNATIONAL