

F.A.I. RTE.	SECTION	COUNTY	TOTAL SHEETS	SHEET NO.
94		COOK	29	27
STA. 2200+00.00		TO STA. 2362+00.00		
FED. ROAD DIST. NO.		ILLINOIS FED. AID PROJECT		
		(1516.1, 1717 & 1818) T-1		
				62935

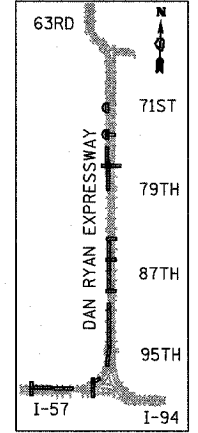

LOCATION MAP

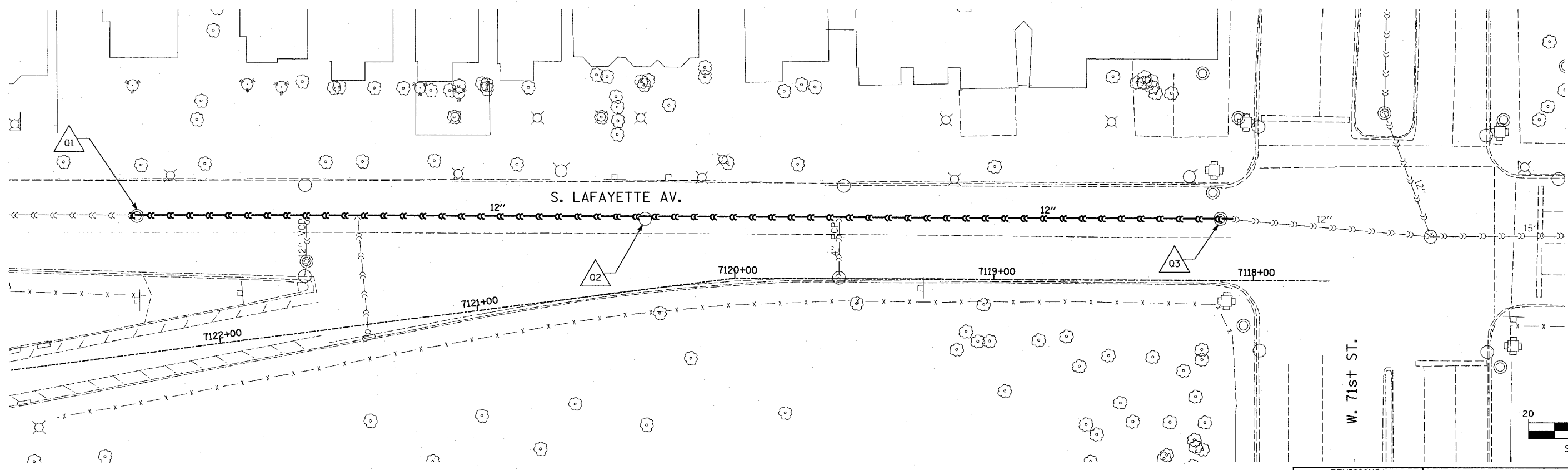
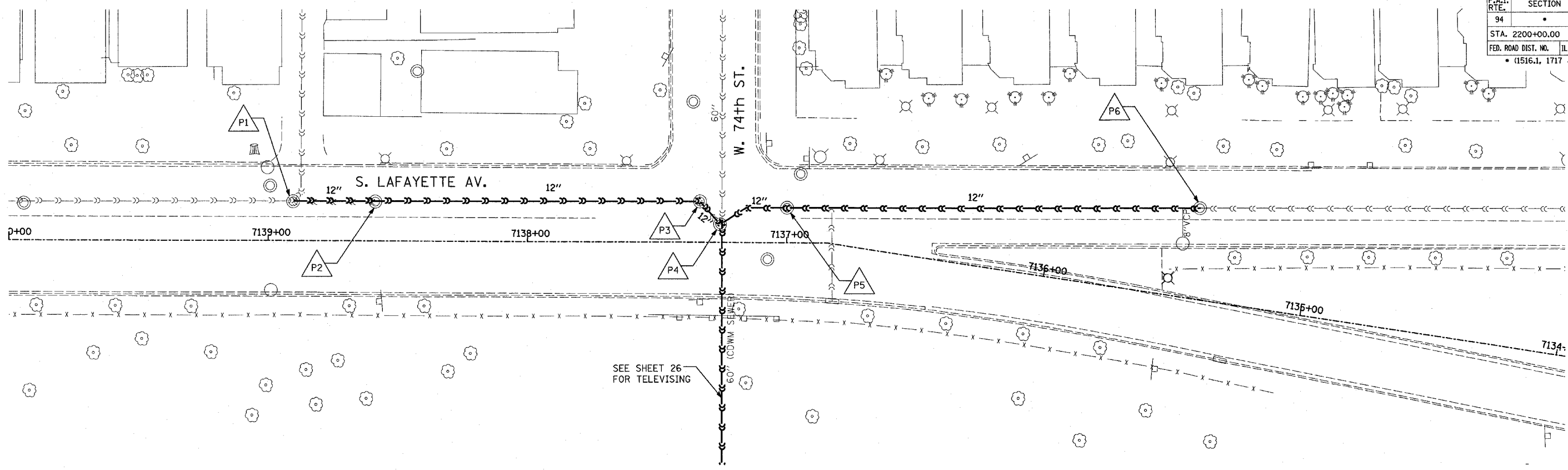
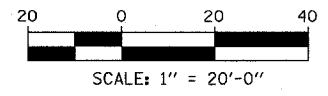

LEGEND:

- — — — — EXISTING COMBINED SEWER
- — — — — EXISTING COMBINED SEWER TO BE TELEVIEWED
- △ XY MANHOLE STRUCTURE NO.

REVISIONS	
NAME	DATE

ILLINOIS DEPARTMENT OF TRANSPORTATION
 F.A.I. 94 (DAN RYAN EXPRESSWAY)
**SEWER TELEVISION
 S. LAFAYETTE AV.**

SCALE: 1"=20'-0"
 DATE: APRIL 15, 2005

DRAWN BY: DE
 CHECKED BY: TGB

TYLININTERNATIONAL