

64423

SBI	SECTION	COUNTY	TOTAL SHEETS	SHEET NO.
88	103C-BR	BUREAU	51	10
STA. 37+00 TO STA. 39+00				
FED. ROAD DIST. NO.			ILLINOIS FED. AID PROJECT	

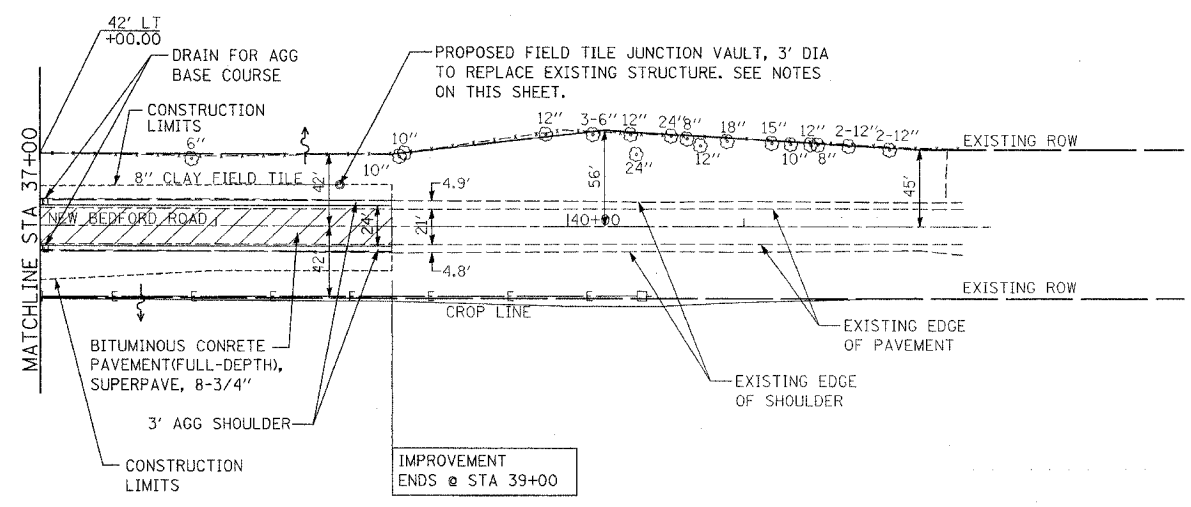

1. THE FRAME AND LID FOR THE VAULT AS SHOWN IN DISTRICT STANDARD 30.2 SHALL BE INCLUDED IN THE UNIT PRICE PER EACH FOR "FIELD TILE JUNCTION VAULTS, 3' DIA."
2. THE COST OF THE REMOVAL AND DISPOSAL OF THE EXISTING VAULT SHALL BE INCLUDED IN THE UNIT PRICE PER EACH FOR "FIELD TILE JUNCTION VAULTS, 3' DIA."
3. THE COST OF CONNECTING THE EXISTING FIELD TILE TO THE PROPOSED VAULT INCLUDING REMOVAL OR REPLACEMENT OF EXISTING SECTIONS OF FIELD TILE SHALL BE INCLUDED IN THE UNIT PRICE PER EACH FOR "FIELD TILE JUNCTION VAULTS, 3' DIA."

PAVEMENT REMOVAL - STA 19+00.00 TO 22+50.00
 STA 28+30.00 TO 28+66.55
 STA 29+84.10 TO 30+20.00
 STA 35+50.00 TO 39+00.00

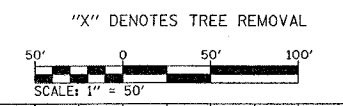

PLAN	REVIEWED	DATE
	BY	
	DATE	
	BY	
	DATE	
	BY	
	DATE	

PROFILE	REVIEWED	DATE
	BY	
	DATE	
	BY	
	DATE	
	BY	
	DATE	

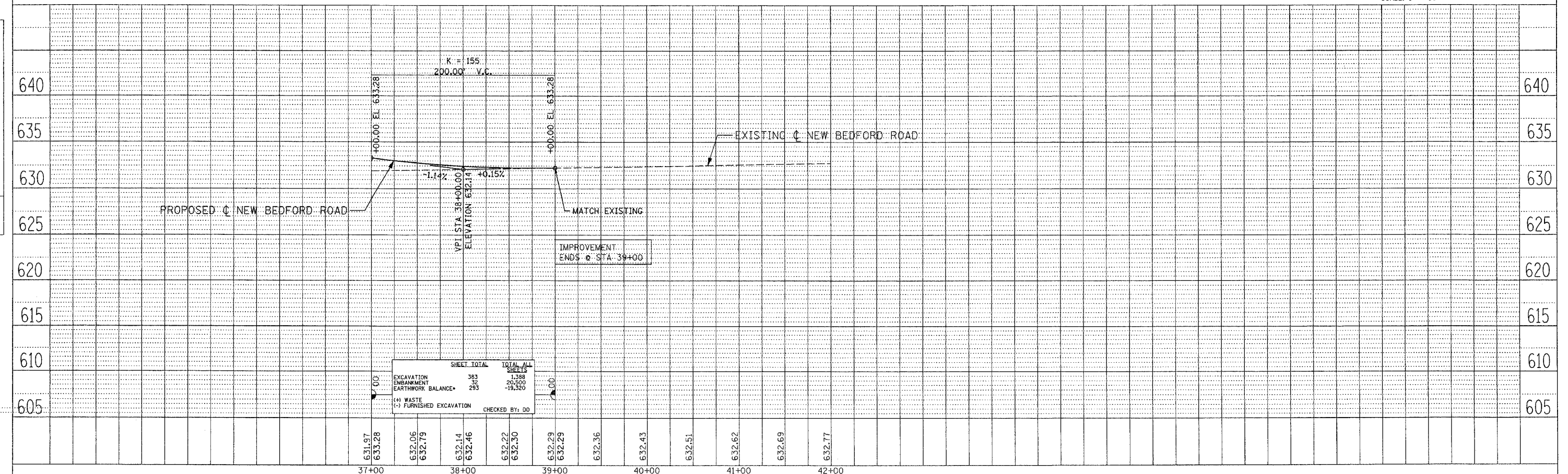

EXCAVATION	383	TOTAL ALL SHEETS	1,388
EMBANKMENT	32		20,500
EARTHWORK BALANCE	293		-19,320
(+) WASTE			
(-) FURNISHED EXCAVATION			

631.97	633.28	632.06	632.79	632.14	632.46	632.22	632.30	632.29	632.29	632.36	632.43	632.51	632.62	632.69	632.77
37+00		38+00		39+00		40+00		41+00		42+00					

NEW BEDFORD ROAD