

STATE OF ILLINOIS  
DEPARTMENT OF TRANSPORTATION

Sheet No. 4  
of 16 Sheets

ROUTE NO.	SECTION	COUNTY	TOTAL SHEETS	SHEET NO.
SBI 88	103C-BR	BUREAU	51	15
FED. ROAD DIST. NO.		ILLINOIS PROJECT	CONTRACT #64423	

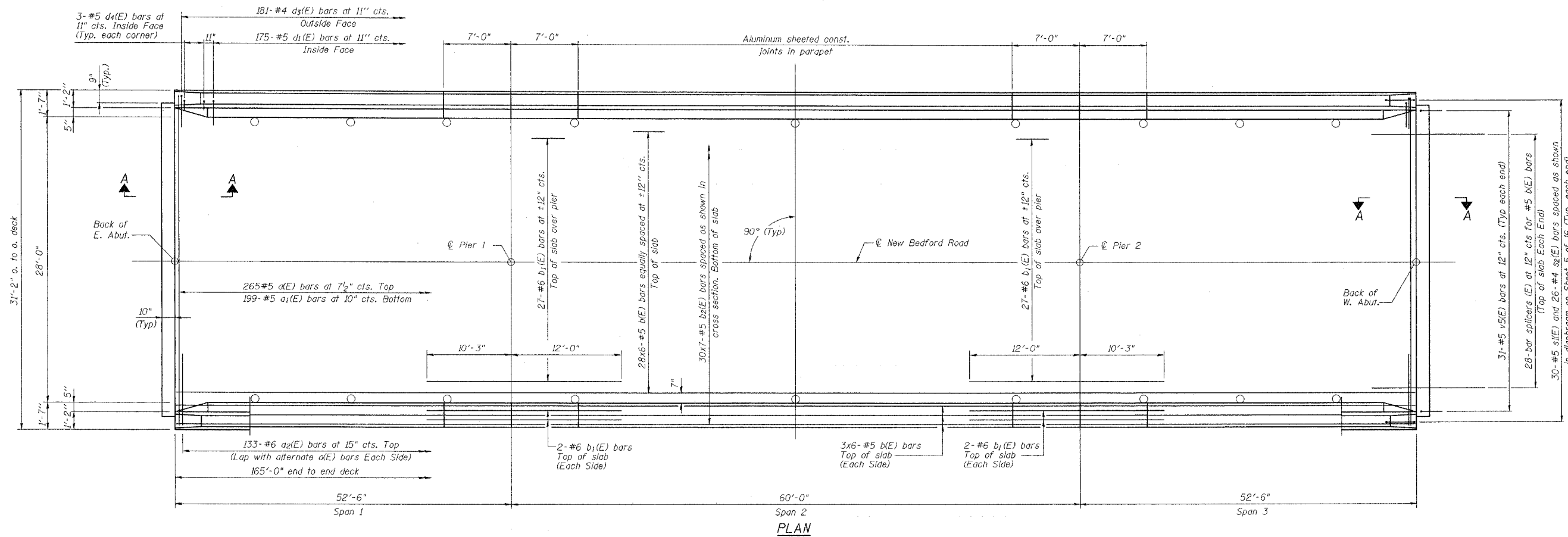

**MIN BAR LAP**  
#5 bar = 2'-2"

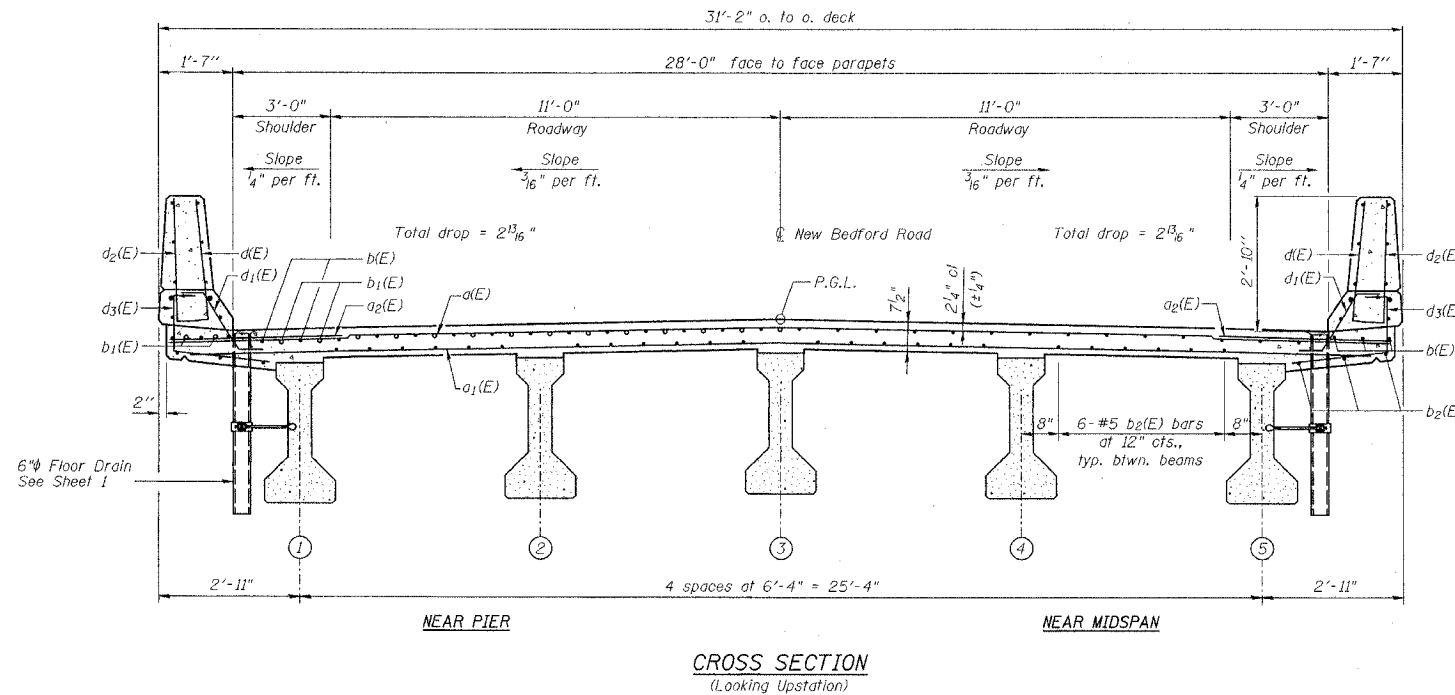

Notes:  
See sheet 6 of 16 for superstructure details and Bill of Material.  
For Section A-A and diaphragm details see sheet 5 of 16.  
Reinforcement bars designated (E) shall be epoxy coated.  
Bars indicated thus 20 x 3-#5 etc. indicates 20 lines of bars with 3 lengths per line.  
See sheet 6 of 16 for parapet reinforcement.  
For Floor Drain spacing see Sheet 1 of 16.  
See sheet 14 of 16 for Bar Splicer Details.

NEW BEDFORD ROAD OVER GREEN RIVER  
DECK PLAN AND CROSS SECTION

REVISIONS		STATE OF ILLINOIS DEPARTMENT OF TRANSPORTATION DIVISION OF HIGHWAYS		DRAWN BY DATE R King 4/04	
NO.	DATE	INITIALS		CREATED BY DATE CMV 4/04	
1				CHG. BY DATE CWC 4/04	
2				BOOK NUMBER	
3					
4					
5					
6					
7					
8					
9					
10					
11					
12					

SBI 88 SPUR SECTION 103C-BR  
SN 006-0163 BUREAU COUNTY  
STA 29+25.34  
HOMER L. CHASTAIN & ASSOCIATES, LLP  
CONSULTING ENGINEERS  
184-001397

PROJECT NO.  
4858-1  
SHEET NO.