

F.A.P. RTE.	SECTION	COUNTY	TOTAL SHEETS	SHEET NO.
553	120RS-3	OGLE	145	44
STA.		TO STA.		
FED. ROAD DIST. NO.		ILLINOIS FED. AID PROJECT		

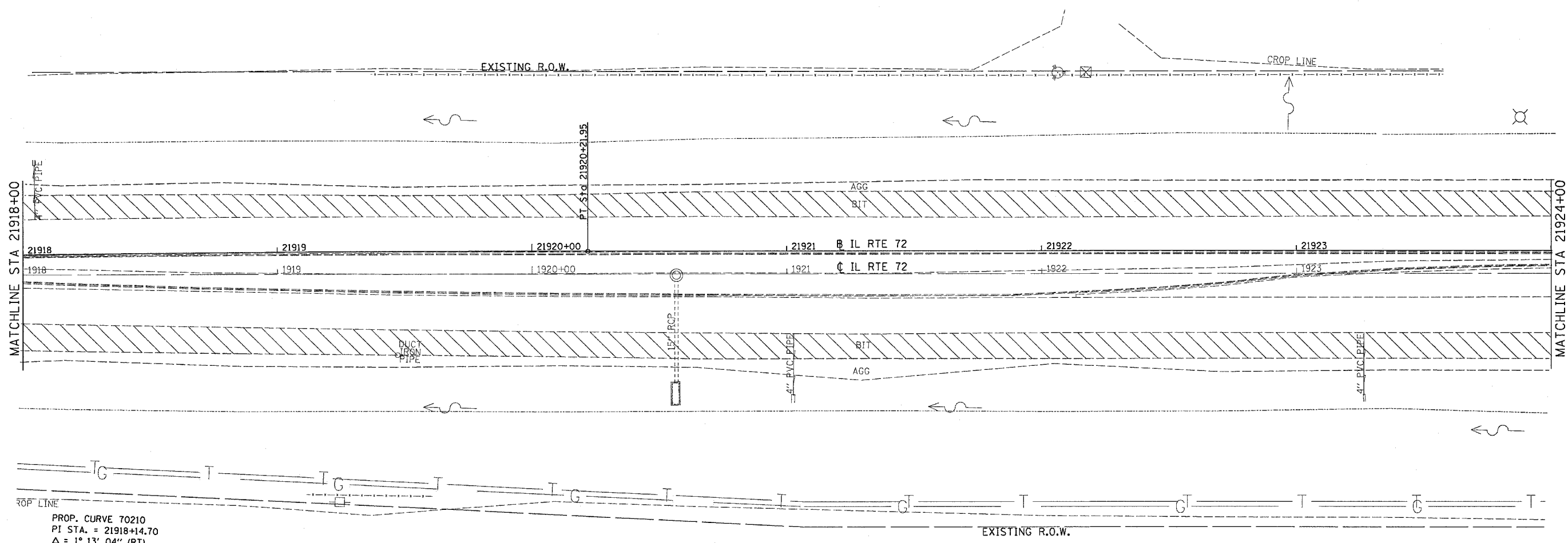

PROP. CURVE 70210  
 PI STA. = 21918+14.70  
 $\Delta = 1^\circ 13' 04''$  (RT)  
 $D = 0^\circ 17' 38''$   
 $R = 19,501.72'$   
 $T = 207.26'$   
 $L = 414.51'$   
 $E = 1.10'$   
 $e = \text{-----}$   
 $T.R. = \text{-----}$   
 $S.E. RUN = \text{-----}$   
 $P.C. STA = 21916+07.44$   
 $P.T. STA = 21920+21.95$

PLOT DATE = Mon, Mar 28 14:28:26 2005  
 FILE NAME = s:\proje\mass\021828\018280+ga.dgn  
 PLOT SCALE = 20.0000' / IN.