

F.A.P. RTE.	SECTION	COUNTY	TOTAL SHEETS	SHEET NO.
553	120RS-3	OGLE	145	56
STA.		TO STA.		
FED. ROAD DIST. NO.		ILLINOIS	FED. AID PROJECT	

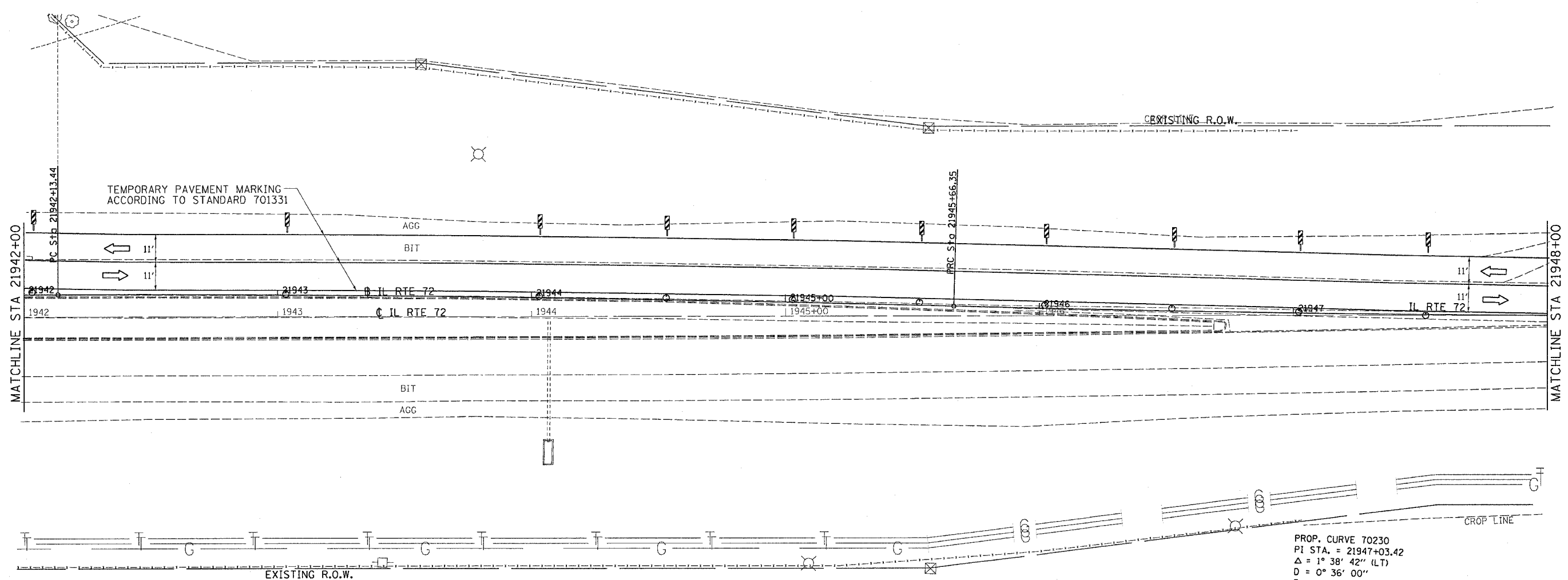

PROP. CURVE 70220  
 PI STA. = 21943+89.91  
 $\Delta = 1^\circ 38' 42''$  (RT)  
 $D = 0^\circ 27' 58''$   
 $R = 12,292.70'$   
 $T = 176.47'$   
 $L = 352.91'$   
 $E = 1.27'$   
 $e = \text{-----}$   
 $T.R. = \text{-----}$   
 $S.E. RUN = \text{-----}$   
 P.C. STA = 21942+13.44  
 P.T. STA = 21945+66.35

PROP. CURVE 70230  
 PI STA. = 21947+03.42  
 $\Delta = 1^\circ 38' 42''$  (LT)  
 $D = 0^\circ 36' 00''$   
 $R = 9,548.23'$   
 $T = 137.07'$   
 $L = 274.12'$   
 $E = 0.98'$   
 $e = \text{-----}$   
 $T.R. = \text{-----}$   
 $S.E. RUN = \text{-----}$   
 P.C. STA = 21945+66.35  
 P.T. STA = 21948+40.47

	WORK AREA
	SIGN
	VERTICLE PANEL
	TYPE III BARRICADE
	BARRICADE OR DRUM WITH MONODIRECTIONAL STEADY BURN LIGHT

**NOTE:**  
 THIS TRAFFIC CONTROL AND PROTECTION SHALL BE SET UP AND PAID FOR ACCORDING TO STANDARD 701331

PLOT DATE = Mon, Nov 28 14:08:17 2005  
 FILE NAME = c:\p12\6220\64634\64634.dgn  
 PLOT SCALE = 20.0000' = 1"