

F.A.S. RTE.	SECTION	COUNTY	TOTAL SHEETS	SHEET NO.
1279	10,E,F,P11-3	LASALLE	19	10
STA. 23+51		TO STA. 35+09		
FED. ROAD DIST. NO.	ILLINOIS	NON-FED. AID PROJECT		

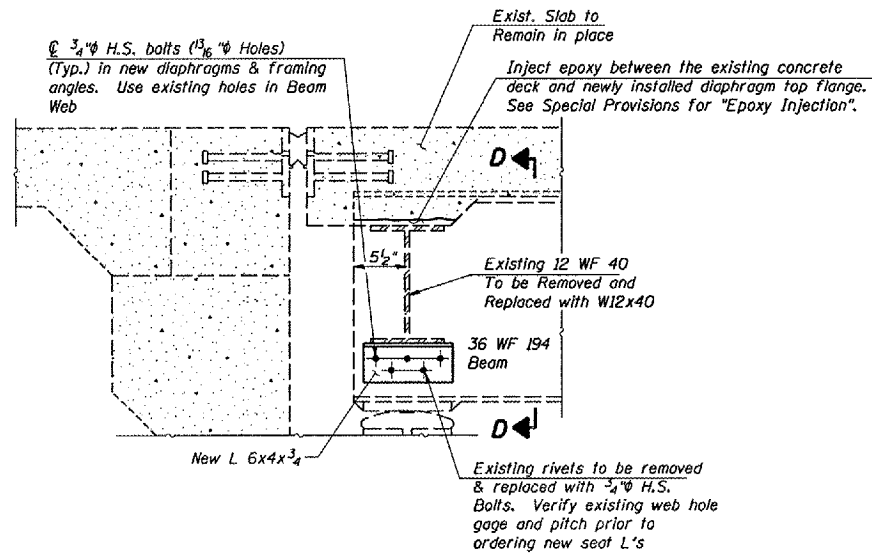

SECTION SOUTH ABUTMENT
Diaphragm D Replacement (Stage 1 Construction)

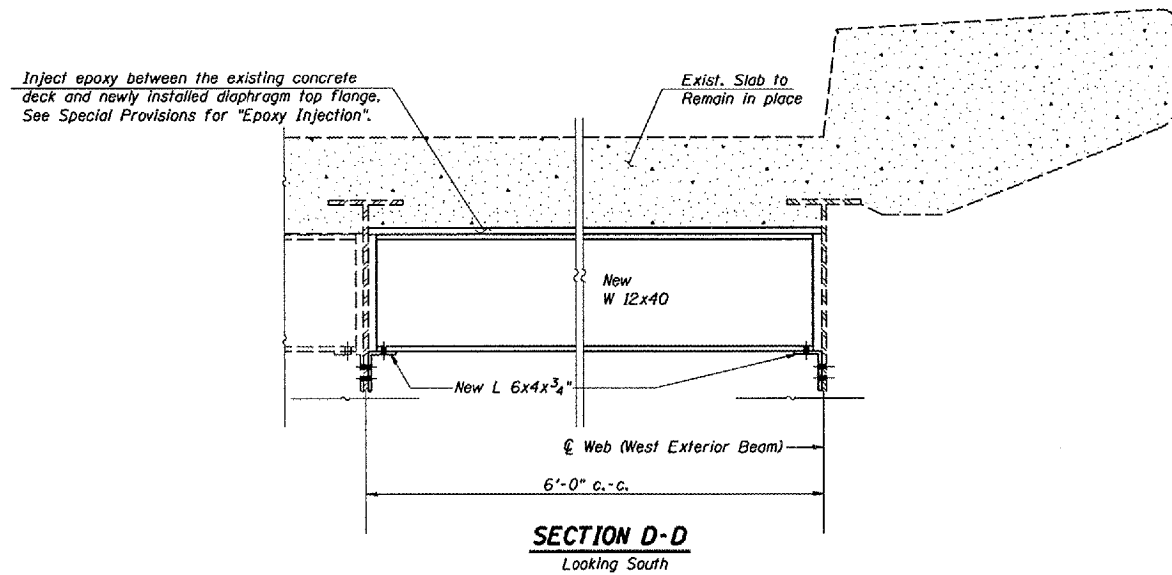

SECTION D-D
Looking South

cmain05/cm326/details.dgn

REVISIONS	
NAME	DATE

ILLINOIS DEPARTMENT OF TRANSPORTATION
SOUTH ABUTMENT SECTION
EXISTING S.N. 050-0088
IL 178 OVER ILLINOIS RIVER
STATION 29+30
SCALE: VERT. _____
 HORIZ. _____
DATE: 12/08/04
DRAWN BY: RLV
CHECKED BY: _____