

F.A. RTE.	SECTION	COUNTY	TOTAL SHEETS	SHEET NO.
74	(72-7)R-3	PEORIA	1360	112
STA. 142+670.000 TO STA. 143+385.000				
FED. ROAD DIST. NO.			ILLINOIS FED. AID PROJECT	

CURVE NO.	110	120	121	131	132	253	254
ALIGNMENT	RAMP A-1	RAMP A-2	RAMP A-2	RAMP A-3	RAMP A-3	RAMP B-5	RAMP B-5
DESIGN SPEED	80 KM/H	80 KM/H	80 KM/H	60 KM/H	60 KM/H	50 KM/H	110 KM/H
P.I. STA	10+330.000	10+286.352	10+424.256	10+441.205	10+658.633	10+815.184	11+147.717
R	3100.000m	414.778m	1151.902m	605.000m	1205.001m	88.000m	1183.526m
T	30.367m	45.568m	92.699m	63.526m	154.365m	133.370m	210.524
L	60.732m	90.773m	185.000m	126.588m	307.062m	173.809m	416.689m
E	0.149m	2.496m	3.724m	3.326m	9.847m	71.786m	18.578m
S.E.	N.C.	6.500%	4.300%	-3.400%	-1.500%	7.900%	-4.300%
TRANSITION IN	N/A	10+208-10+257	10+332-10+452	N/A	10+504-10+515	10+650-10+698	10+899-10+956
TRANSITION OUT	N/A	10+292-10+332	ENT. TERMINAL	10+499-10+504	N/A	10+840-10+888	ENT. TERMINAL
P.C. STA	10+299.633	10+240.784	10+331.557	10+377.679	10+504.266	10+681.815	10+937.193
P.T. STA	10+360.365	10+331.557	10+516.557	10+504.266	10+811.328	10+855.624	11+353.882

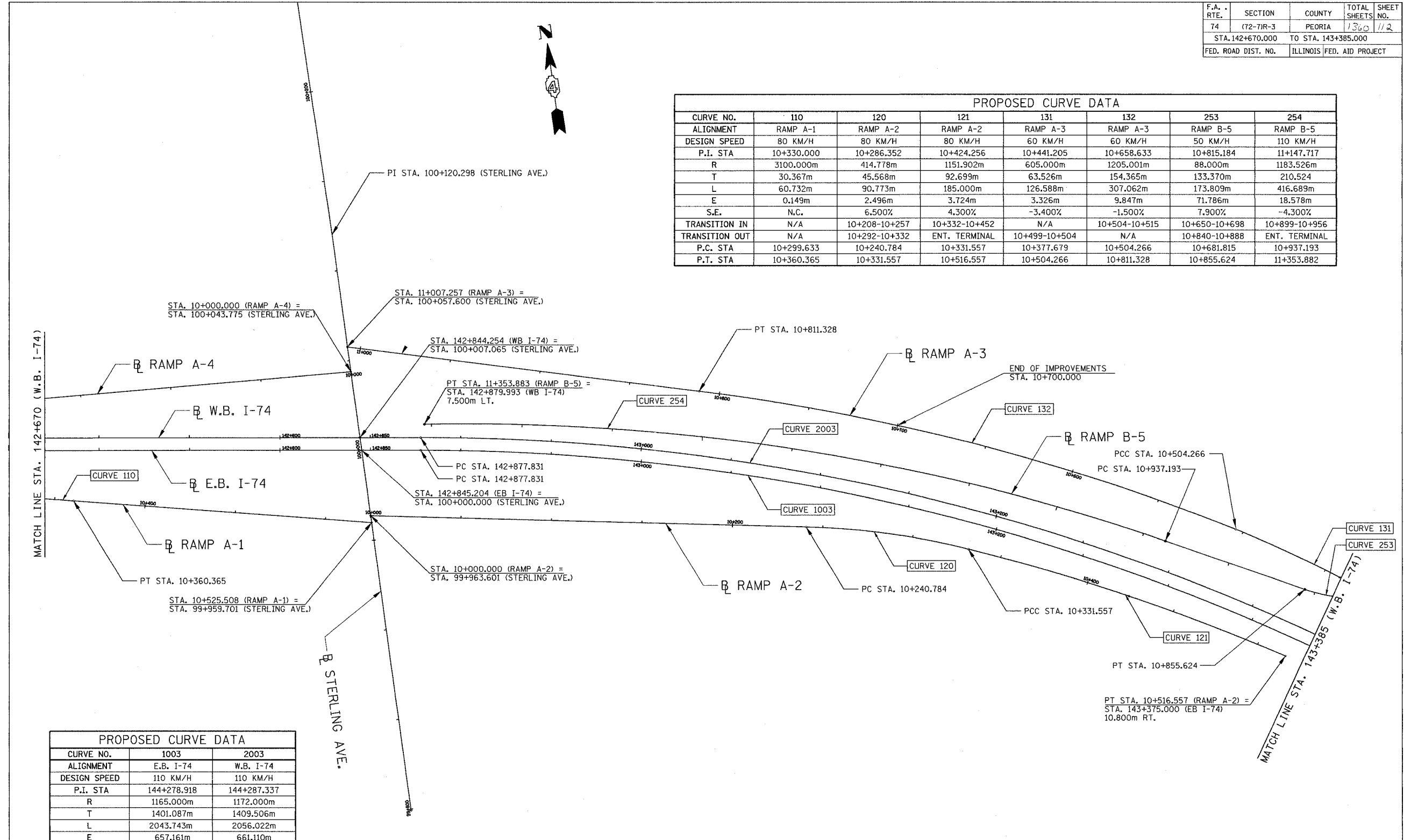

CURVE NO.	1003	2003
ALIGNMENT	E.B. I-74	W.B. I-74
DESIGN SPEED	110 KM/H	110 KM/H
P.I. STA	144+278.918	144+287.337
R	1165.000m	1172.000m
T	1401.087m	1409.506m
L	2043.743m	2056.022m
E	657.161m	661.110m
S.E.	4.300%	4.300%
TRANSITION IN	142+821-142+900	142+821-142+900
TRANSITION OUT	144+906-144+988	144+906-144+988
P.C. STA	142+877.831	142+877.831
P.T. STA	144+921.574	144+933.853

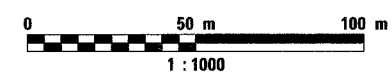

NAME	DATE

ILLINOIS DEPARTMENT OF TRANSPORTATION
 SCHEMATIC DRAWING
 FAI ROUTE 74 (I-74) (WB)
 STA. 142+670 TO STA. 143+385
 DRAWN BY CADD
 CHECKED BY KJW
 DATE 11/12/04