

F.A. RTE.	SECTION	COUNTY	TOTAL SHEETS	SHEET NO.
74	(72-7)R-3	PEORIA	1360	140
STA. 39+150.000 TO STA. 39+500.000		ILLINOIS FED. AID PROJECT		

LEGEND

- CONSTRUCTED THIS STAGE
- TEMPORARY PAVEMENT
- DIRECTION OF TRAFFIC
- TEMPORARY CONCRETE BARRIER
- PLASTIC DRUM
- TYPE III BARRICADE WITH FLASHING LIGHTS (ROAD CLOSED)
- SIGN
- LANE(S) CLOSED
- ARROW BOARD

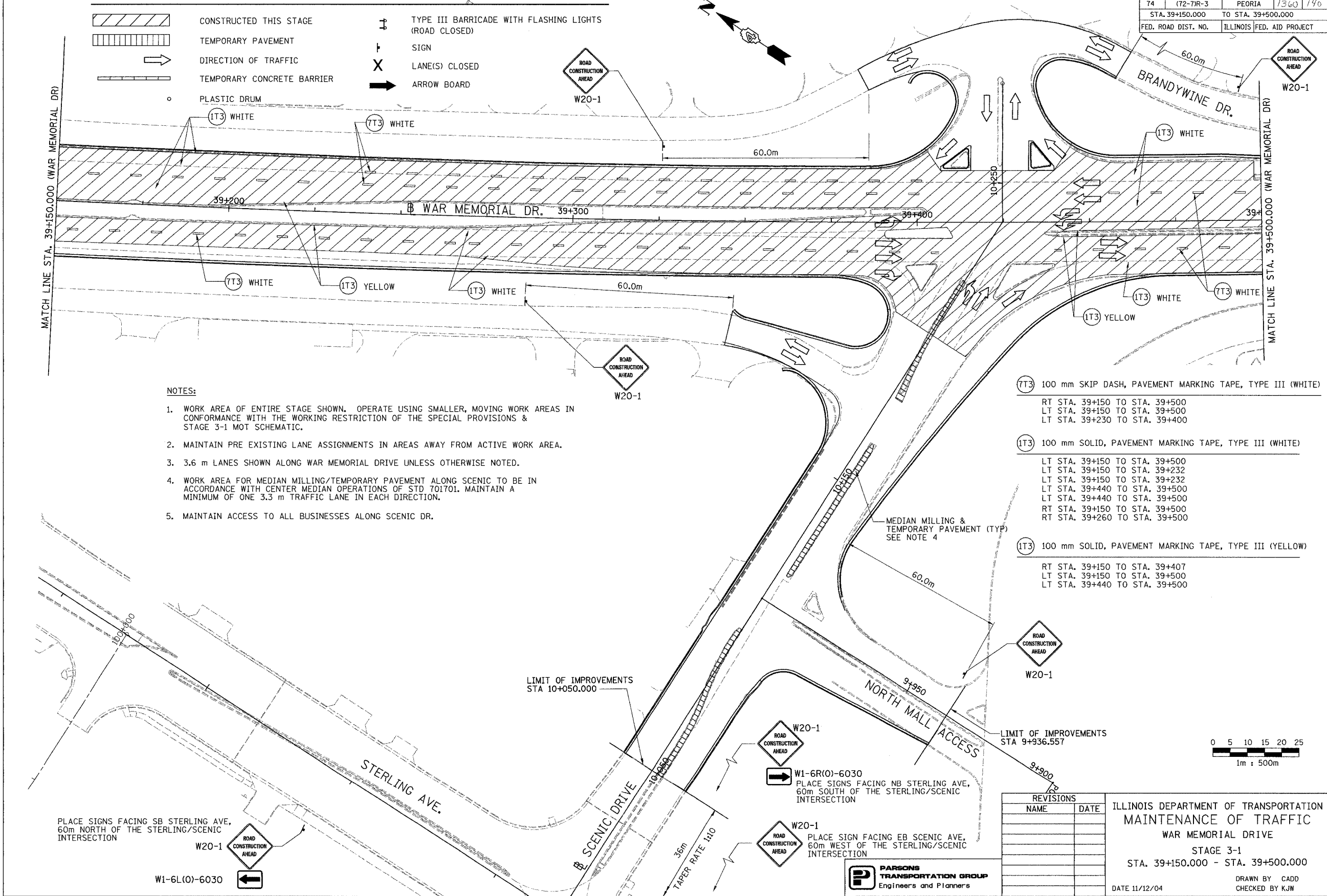

NOTES:

1. WORK AREA OF ENTIRE STAGE SHOWN. OPERATE USING SMALLER, MOVING WORK AREAS IN CONFORMANCE WITH THE WORKING RESTRICTION OF THE SPECIAL PROVISIONS & STAGE 3-1 MOT SCHEMATIC.
2. MAINTAIN PRE EXISTING LANE ASSIGNMENTS IN AREAS AWAY FROM ACTIVE WORK AREA.
3. 3.6 m LANES SHOWN ALONG WAR MEMORIAL DRIVE UNLESS OTHERWISE NOTED.
4. WORK AREA FOR MEDIAN MILLING/TEMPORARY PAVEMENT ALONG SCENIC TO BE IN ACCORDANCE WITH CENTER MEDIAN OPERATIONS OF STD 70170L. MAINTAIN A MINIMUM OF ONE 3.3 m TRAFFIC LANE IN EACH DIRECTION.
5. MAINTAIN ACCESS TO ALL BUSINESSES ALONG SCENIC DR.

- (TT3) 100 mm SKIP DASH, PAVEMENT MARKING TAPE, TYPE III (WHITE)
 RT STA. 39+150 TO STA. 39+500
 LT STA. 39+150 TO STA. 39+500
 LT STA. 39+230 TO STA. 39+400
- (IT3) 100 mm SOLID, PAVEMENT MARKING TAPE, TYPE III (WHITE)
 LT STA. 39+150 TO STA. 39+500
 LT STA. 39+150 TO STA. 39+232
 LT STA. 39+150 TO STA. 39+232
 LT STA. 39+440 TO STA. 39+500
 LT STA. 39+440 TO STA. 39+500
 RT STA. 39+150 TO STA. 39+500
 RT STA. 39+260 TO STA. 39+500
- (IT3) 100 mm SOLID, PAVEMENT MARKING TAPE, TYPE III (YELLOW)
 RT STA. 39+150 TO STA. 39+407
 LT STA. 39+150 TO STA. 39+500
 LT STA. 39+440 TO STA. 39+500

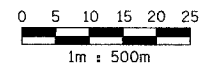

REVISIONS	
NAME	DATE

ILLINOIS DEPARTMENT OF TRANSPORTATION
 MAINTENANCE OF TRAFFIC
 WAR MEMORIAL DRIVE
 STAGE 3-1
 STA. 39+150.000 - STA. 39+500.000
 DATE 11/12/04
 DRAWN BY CADD
 CHECKED BY KJW

PARSONS
 TRANSPORTATION GROUP
 Engineers and Planners

P:\643996\CIVIL\sh+wb\MT00310-IAWM.dgn