

F.A. RTE.	SECTION	COUNTY	TOTAL SHEETS	SHEET NO.
74	(72-7)R-3	PEORIA	1360	177
STA.		TO STA.		
FED. ROAD DIST. NO.	ILLINOIS	FED. AID PROJECT		

MAINTENANCE OF TRAFFIC STAGES

- STAGE 3-1
- STAGE 3-2
- STAGE 3-3
- STAGE 3-4 ← THIS STAGE

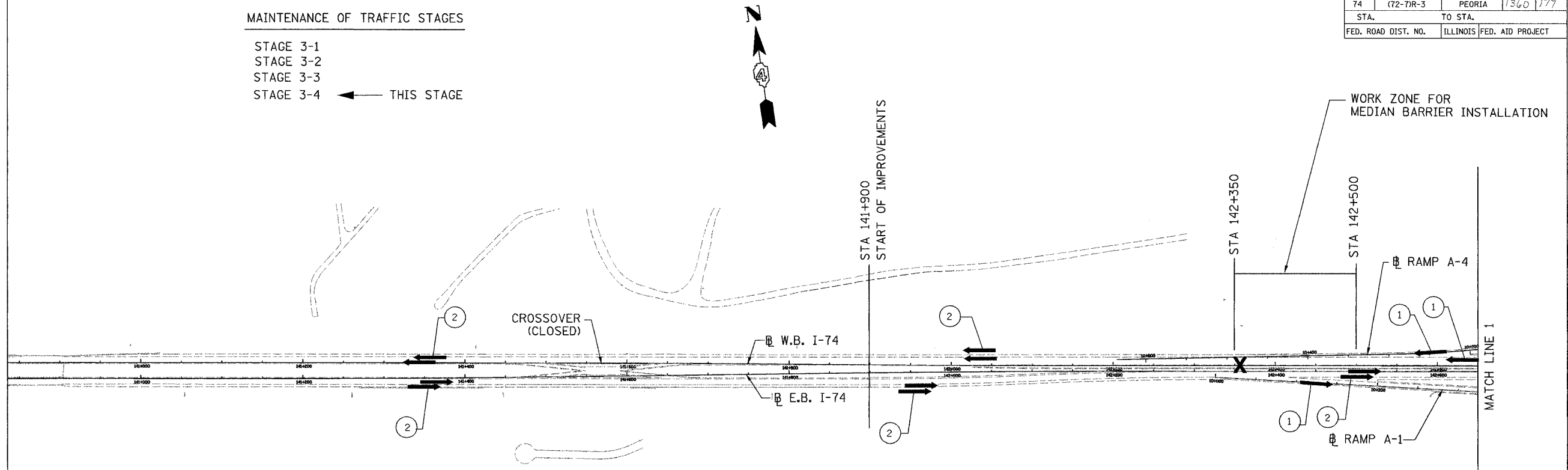

STAGE 3 - I-74 MAINLINE:
STAGE 3-4 WESTBOUND LANES-RECONSTRUCTION

CONSTRUCTION:

Construct/perform the following during this Stage

1. Proposed Westbound Roadway and Shoulder pavements near Sta 143+150 (the A-3 Gap)
2. Proposed Median Barrier between Sta 142+350 WB to Sta 142+500 WB and between Sta 143+101 WB to Sta 143+235 WB (adjacent to the A-3 Gap).
3. Remove remaining temporary pavement (crossover, along the outside shoulder of the EB pavement-between Ramps B-1 & B-4, the temporary crash investigation site and other locations as determined by the Engineer).
4. Proposed Slopewall adjacent to Abutment at Sterling Ave.

MAINTENANCE OF TRAFFIC:

LANES CLOSED:

-Ramp B-5 (I-74 WB Entrance Ramp from EB War Memorial Drive).

LANES OPEN:

- All lanes on Eastbound and Westbound, as well as all I-74 Ramps (except B-5 as mentioned above). Intermittent partial lane & shoulder closings are needed to complete the CONSTRUCTION of this Stager 3-4.
- 1. MOT for Installing roadway and shoulder pavement shall be in accordance with I74 Project Standard 701404-I74 and as indicated on the Stage 3-4 MOT Plans. Substage as needed to maintain a minimum of one lane for WB traffic (two substages are shown in the Stage 3-4 MOT Plans).
- 2. MOT for median barrier construction to be in accordance with IDOT Standards 701401 & 701406. Lane closures adjacent to this work will not be permitted during non-working hours.
- 3. MOT for Slope wall construction to be in accordance with IDOT Standard 701423 and 701101.
- 4. MOT for temporary pavement and TCIS removal to be in accordance with IDOT Standards 701401 & 701406. Lane closures adjacent to this work will not be permitted during non-working hours.

LEGEND

- TEMPORARY PAVEMENT
- CONSTRUCTION THIS STAGE
- CONSTRUCTED IN PRECEDING STAGES
- NUMBER OF TRAFFIC LANES DURING THIS STAGE
- DIRECTION OF TRAFFIC
- LANE CLOSED

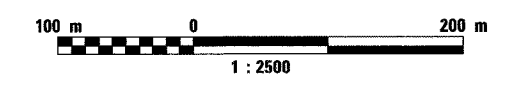

REVISIONS	
NAME	DATE

ILLINOIS DEPARTMENT OF TRANSPORTATION
MAINTENANCE OF TRAFFIC
 FAI ROUTE 74 (I-74 WB)
SCHEMATIC
 STAGE 3-4
 DATE 11/12/04
 DRAWN BY CADD
 CHECKED BY KJW

