

STATE OF ILLINOIS
DEPARTMENT OF PUBLIC WORKS & BUILDINGS
DIVISION OF HIGHWAYS

ROUTE NO.	DIS.	COUNTY	POST MILE	SHEET NO.
FA 31	117-3HB	PEORIA	29	15
PROJ. ROAD DEPT. NO. 17	ILLINOIS	PROJECT	U-107(12)	

1360 443

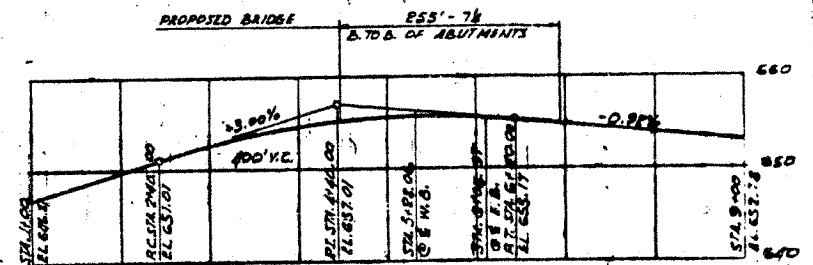
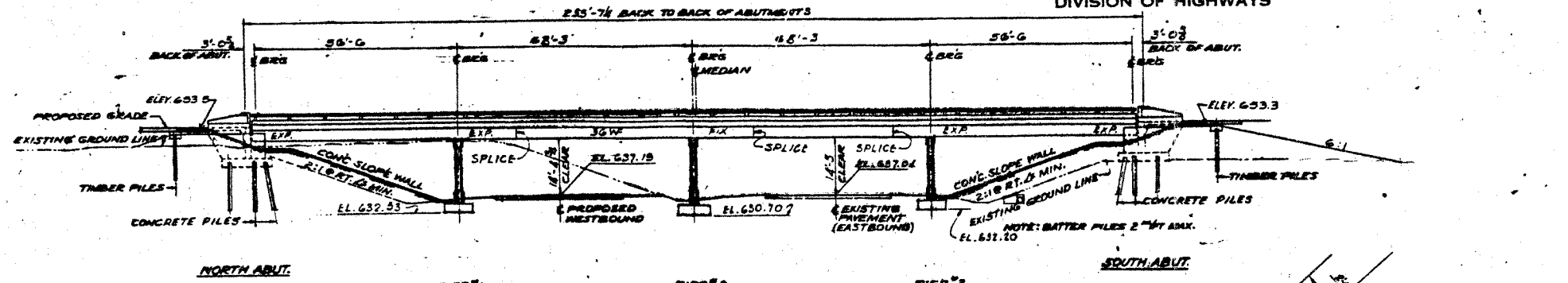

F.A. ROUTE 31 CONNECTION - PROFILE
SCALE: 1" = 100'-0" VERT.
1" = 10'-0" HORIZ.

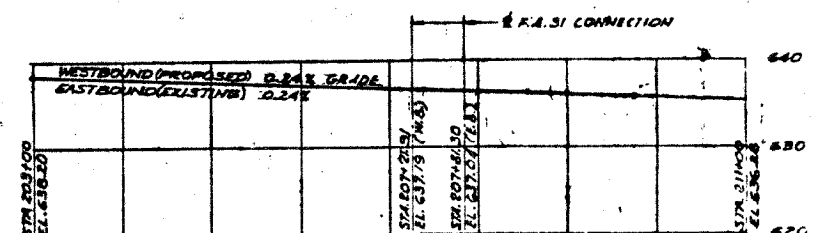
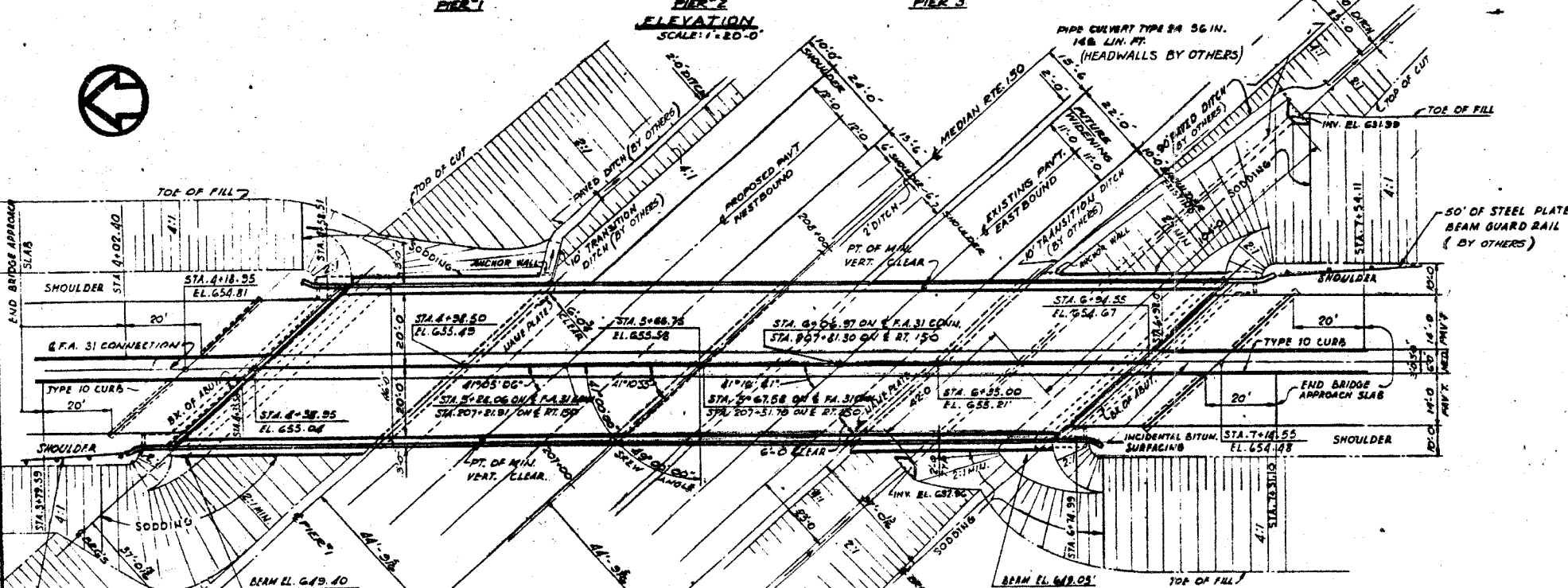

F.A. 31 (U.S. ROUTE 150) - PROFILE
SCALE: 1" = 100'-0" VERT.
1" = 10'-0" HORIZ.

GENERAL NOTES:

1. ALL CONCRETE SHALL BE CLASS A.
2. BRIDGE DESIGNED FOR FUTURE TRAFFIC WEARING SURFACE @ 20 P.S.F.
3. THE CONCRETE FLOOR SLAB SHALL BE FINISHED IN ACCORDANCE WITH ARTICLE 51.13 OF THE STANDARD SPECIFICATIONS. THE CURBS AND SLAB OUTSIDE OF LONGITUDINAL CONSTRUCTION JOINTS SHOWN ON CROSS SECTION SHALL BE POURED INDIVIDUALLY.
4. NO TRANSVERSE CONSTRUCTION JOINTS SHALL BE MADE EXCEPT BY WRITTEN PERMISSION OF THE ENGINEER.
5. THE ROADWAY EXPANSION PLATE SHALL BE FABRICATED AND ERECTED IN ACCORDANCE WITH ART. 51.13(d) OF THE STANDARD SPECIFICATIONS AND SHALL FIT THE CROWN OF THE ROADWAY.
6. ALL ROLLERS, ROCKERS, BEARING PLATES, LEAD PLATES, PINTLES, BOLT PLATES AND ANKOR BOLTS SHALL BE FABRICATED AND SET IN ACCORDANCE WITH ART. 51.15 OF THE STANDARD SPECIFICATIONS AND ARE INCLUDED IN WEIGHT OF STRUCTURAL STEEL. ANCHOR BOLTS SHALL BE SET BEFORE BOLTING DIAPHRAGMS OVER SUPPORTS.
7. EXPANSION JOINTS ARE INCLUDED IN WEIGHT OF STRUCTURAL STEEL.
8. EXCEPT AS OTHERWISE PROVIDED ALL STRUCTURAL STEEL SHALL RECEIVE ONE SHOP COAT OF RED LEAD PAINT AND TWO FIELD COATS OF ALUMINUM PAINT. SEE ARTICLE 56.1 TO 56.5 INCLUSIVE OF THE STANDARD SPECIFICATIONS.
9. STRUCTURE DESIGNED IN ACCORDANCE WITH AASHTO STANDARD SPECIFICATIONS FOR HIGHWAY BRIDGES 1957 EDITION.
10. THE CONTRACTOR SHALL DRIVE TEST PILES IN A PERMANENT LOCATION, AS SHOWN ON PLANS, BEFORE ORDERING THE REMAINDER OF PILES.
11. REINFORCING BARS SHALL BE LAPPED A MINIMUM OF 20 BAR DIAMETERS UNLESS OTHERWISE NOTED.
12. LIVE LOADING: HS-20-SIG-44 AND ALTERNATE.
13. COARSE AGGREGATE WHICH IS TO BE USED IN PARAPET HANDRAIL AND END POSTS MUST BE ABSOLUTELY FREE FROM GHEFT, FLINT, LIMONITE AND SOFT SANDSTONE.
14. WHEREVER IN THESE PLANS REFERENCE IS MADE TO THE "STANDARD SPECIFICATIONS" IT IS UNDERSTOOD TO INCLUDE THE "SUPPLEMENTAL SPECIFICATION" EFFECTIVE JULY 1, 1961.

DESIGN STRESSES:

- 15. 18,000 P.S.I. - STRUCTURAL STEEL.
- 16. 30,000 P.S.I. - REINFORCING STEEL.
- 17. 4,000 P.S.I. - CONCRETE.
- 18. 90 P.S.I. - SUPERSTRUCTURE.
- 19. 75 P.S.I. - FOOTINGS.
- 20. 10.

SECTION 117-3HB

SUMMARY OF QUANTITIES - SHEET 1 THRU 13

ITEM	UNIT	QUANTITY
CLASS A EXCAVATION FOR STRUCTURES	CU. YDS.	439
ERECTING STRUCTURAL STEEL	LBS.	356,800
ALUMINUM HANDRAIL	LIN. FT.	505
PIPE CULVERT TYPE 24 36 IN.	LIN. FT.	146
REINFORCEMENT BARS	LBS.	187,500
FURNISHING CROSDOTTED PILES UP TO 20'	LIN. FT.	300
DRIVING TIMBER PILES	LIN. FT.	300
FURNISHING CONCRETE PILES	LIN. FT.	1,150
DRIVING CONCRETE PILES	LIN. FT.	1,150

PLAN

SCALE: 1" = 20'

BRIDGE APPROACH SLABS - STD. 1909-3 METHOD II (BY OTHERS)

STA. TO STA.	P.C.C. PAVEMENT (10'-10" - 10'-10")	REINF. BARS
RT. 4+18.95 TO 4+55.00	75.2 SQ. YDS.	2353 LBS.
LT. 4+18.95 TO 4+55.00	75.2 SQ. YDS.	2353 LBS.
RT. 4+74.95 TO 4+51.10	75.2 SQ. YDS.	2353 LBS.
LT. 4+74.95 TO 4+51.10	75.2 SQ. YDS.	2353 LBS.
TOTALS:	300.8 SQ. YDS.	9412 LBS.

R.C. PILE CAP (BY OTHERS)

STATION	CLASS X CONC.	REINF. BARS
RT. 4+18.95	1.51 CU. YDS.	516 LBS.
LT. 4+18.95	1.51 CU. YDS.	516 LBS.
RT. 4+74.95	1.51 CU. YDS.	516 LBS.
LT. 4+74.95	1.51 CU. YDS.	516 LBS.
TOTALS	6.04 CU. YDS.	2064 LBS.

DESIGNED G. BEYKOVICH & K.M.	EXAMINED
CHECKED K. MATSEVICH	APPROVED
DRAWN G. BEYKOVICH & K.M.	APPROVED
CHECKED T. WADA	APPROVED

ITEM	UNIT	QUANTITY
SODDING	SQ. YDS.	700
TEST PILES (CONCRETE)	EACH	2
NAME PLATES	EACH	8
SLOPE WALL (4')	SQ. YDS.	300
SUPPLEMENTAL WATERING	UNIT	3.0
CLASS X CONCRETE	CU. YDS.	810.7

SECTION 117-3HF

FURNISHING STRUCTURAL STEEL

JOHN F. MEISSNER ENGINEERS
CHICAGO, ILLINOIS
DWG. NO. 56-197-6620

GENERAL PLAN & ELEVATION
F.A. ROUTE 31 SECTION 117(3HB) & (3HC)
PROJECT U-107 (12)
F.A. 31 CONNECTION - GRADE SEPARATION
PEORIA COUNTY - STATION 207+51.70