

ROUTE NO.	SECT.	COUNTY	SHEET NO.	TOTAL SHEETS
F.A.I. 74	(72-7) R-3	PEORIA	448	1360
FED. ROAD DIST. NO. 7	ILLINOIS	FED. AID PROJECT		

CONTRACT NO. 68200

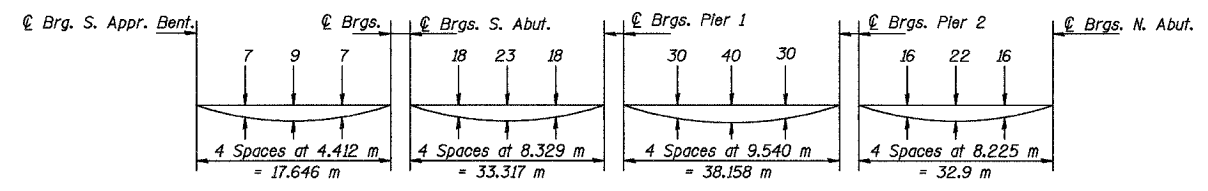

DEAD LOAD DEFLECTION DIAGRAM
(Includes weight of concrete, excluding beams).

Note: The above deflections are not to be used in the field if the engineer is working from the grade elevations adjusted for dead load deflections as shown below and on sheets 6 and 7.

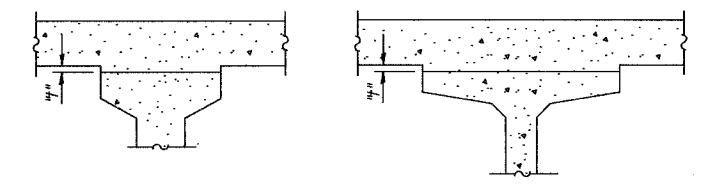

To determine "h": After all precast prestressed beams have been erected, elevations of the top flanges of the beams shall be taken at intervals shown below and on sheets 6 and 7. These elevations subtracted from the "Theoretical Grade Elevations Adjusted For Dead Load Deflections" minus slab thickness, equals the fillet heights "h" above top flanges of beams.

FILLET HEIGHTS

BEAM 1					BEAM 2					BEAM 3					BEAM 4				
Location	Station	Offset (m)	Theoretical Grade Elevations	Theoretical Grade Elevations Adjusted For Dead Load Deflection	Location	Station	Offset (m)	Theoretical Grade Elevations	Theoretical Grade Elevations Adjusted For Dead Load Deflection	Location	Station	Offset (m)	Theoretical Grade Elevations	Theoretical Grade Elevations Adjusted For Dead Load Deflection	Location	Station	Offset (m)	Theoretical Grade Elevations	Theoretical Grade Elevations Adjusted For Dead Load Deflection
Bk. S. Appr. Bent	10+729.858	-14.643	197.067	197.067	Bk. S. Appr. Bent	10+728.087	-12.743	197.043	197.043	Bk. S. Appr. Bent	10+726.315	-10.843	197.017	197.017	Bk. S. Appr. Bent	10+724.543	-8.943	196.981	196.981
€ Brg.	10+730.503	-14.643	197.087	197.087	€ Brg.	10+728.732	-12.743	197.063	197.063	€ Brg.	10+726.960	-10.843	197.037	197.037	€ Brg.	10+725.188	-8.943	197.001	197.001
A1	10+733.503	-14.643	197.181	197.186	A1	10+731.732	-12.743	197.157	197.162	A1	10+729.960	-10.843	197.130	197.135	A1	10+728.188	-8.943	197.095	197.100
B1	10+736.503	-14.643	197.275	197.283	B1	10+734.732	-12.743	197.251	197.259	B1	10+732.960	-10.843	197.224	197.232	B1	10+731.188	-8.943	197.189	197.197
C1	10+739.503	-14.643	197.368	197.378	C1	10+737.732	-12.743	197.344	197.354	C1	10+735.960	-10.843	197.318	197.328	C1	10+734.188	-8.943	197.282	197.292
D1	10+742.503	-14.643	197.460	197.469	D1	10+740.732	-12.743	197.438	197.446	D1	10+738.960	-10.843	197.411	197.419	D1	10+737.188	-8.943	197.376	197.384
E1	10+745.503	-14.643	197.548	197.552	E1	10+743.732	-12.743	197.528	197.533	E1	10+741.960	-10.843	197.504	197.508	E1	10+740.188	-8.943	197.470	197.474
€ Brg.	10+748.149	-14.643	197.621	197.621	€ Brg.	10+746.378	-12.743	197.604	197.604	€ Brg.	10+744.606	-10.843	197.582	197.582	€ Brg.	10+742.834	-8.943	197.550	197.550
Bk. S. Abut.	10+748.589	-14.643	197.633	197.633	Bk. S. Abut.	10+746.818	-12.743	197.616	197.616	Bk. S. Abut.	10+745.046	-10.843	197.595	197.595	Bk. S. Abut.	10+743.274	-8.943	197.563	197.563

BEAM 5					BEAM 6					BEAM 7					BEAM 8				
Location	Station	Offset (m)	Theoretical Grade Elevations	Theoretical Grade Elevations Adjusted For Dead Load Deflection	Location	Station	Offset (m)	Theoretical Grade Elevations	Theoretical Grade Elevations Adjusted For Dead Load Deflection	Location	Station	Offset (m)	Theoretical Grade Elevations	Theoretical Grade Elevations Adjusted For Dead Load Deflection	Location	Station	Offset (m)	Theoretical Grade Elevations	Theoretical Grade Elevations Adjusted For Dead Load Deflection
Bk. S. Appr. Bent	10+722.772	-7.043	196.888	196.888	Bk. S. Appr. Bent	10+721.000	-5.143	196.871	196.871	Bk. S. Appr. Bent	10+719.228	-3.243	196.795	196.795	Bk. S. Appr. Bent	10+717.456	-1.343	196.711	196.711
€ Brg.	10+723.417	-7.043	196.908	196.908	€ Brg.	10+721.645	-5.143	196.891	196.891	€ Brg.	10+719.873	-3.243	196.815	196.815	€ Brg.	10+718.101	-1.343	196.732	196.732
A1	10+726.417	-7.043	197.002	197.007	A1	10+724.645	-5.143	196.984	196.989	A1	10+722.873	-3.243	196.909	196.914	A1	10+721.101	-1.343	196.825	196.830
B1	10+729.417	-7.043	197.095	197.104	B1	10+727.645	-5.143	197.078	197.086	B1	10+725.873	-3.243	197.003	197.011	B1	10+724.101	-1.343	196.919	196.927
C1	10+732.417	-7.043	197.189	197.199	C1	10+730.645	-5.143	197.172	197.182	C1	10+728.873	-3.243	197.096	197.106	C1	10+727.101	-1.343	197.013	197.022
D1	10+735.417	-7.043	197.283	197.291	D1	10+733.645	-5.143	197.265	197.274	D1	10+731.873	-3.243	197.190	197.198	D1	10+730.101	-1.343	197.106	197.114
E1	10+738.417	-7.043	197.376	197.381	E1	10+736.645	-5.143	197.359	197.363	E1	10+734.873	-3.243	197.284	197.288	E1	10+733.101	-1.343	197.200	197.204
€ Brg.	10+741.062	-7.043	197.459	197.459	€ Brg.	10+739.290	-5.143	197.442	197.442	€ Brg.	10+737.518	-3.243	197.366	197.366	€ Brg.	10+735.747	-1.343	197.282	197.282
Bk. S. Abut.	10+741.503	-7.043	197.472	197.472	Bk. S. Abut.	10+739.731	-5.143	197.455	197.455	Bk. S. Abut.	10+737.959	-3.243	197.380	197.380	Bk. S. Abut.	10+736.187	-1.343	197.296	197.296

@ RAMP B-1					BEAM 9				
Location	Station	Offset (m)	Theoretical Grade Elevations	Theoretical Grade Elevations Adjusted For Dead Load Deflection	Location	Station	Offset (m)	Theoretical Grade Elevations	Theoretical Grade Elevations Adjusted For Dead Load Deflection
Bk. S. Appr. Bent	10+716.204	0.000	196.652	196.652	Bk. S. Appr. Bent	10+715.684	0.557	196.625	196.625
€ Brg.	10+716.849	0.000	196.672	196.672	€ Brg.	10+716.330	0.557	196.645	196.645
A1	10+719.849	0.000	196.766	196.771	A1	10+719.330	0.557	196.739	196.744
B1	10+722.849	0.000	196.860	196.868	B1	10+722.330	0.557	196.832	196.841
C1	10+725.849	0.000	196.953	196.963	C1	10+725.330	0.557	196.926	196.936
D1	10+728.849	0.000	197.047	197.055	D1	10+728.330	0.557	197.020	197.028
E1	10+731.849	0.000	197.141	197.145	E1	10+731.330	0.557	197.113	197.118
€ Brg.	10+734.495	0.000	197.223	197.223	€ Brg.	10+733.975	0.557	197.196	197.196
Bk. S. Abut.	10+734.935	0.000	197.237	197.237	Bk. S. Abut.	10+734.415	0.557	197.210	197.210

Notes:
Work this Sheet with Sheet 4.
All elevations and offsets are in meters.
All elevations are at top of slab.
All stations are based on @ Ramp B-1.
All dimensions are in millimeters (mm) except as noted.

REVISION	DATE	DESCRIPTION
STATE OF ILLINOIS DEPARTMENT OF TRANSPORTATION		
TOP OF SLAB ELEVATIONS - SPAN 1		
RAMPS B-1 AND B-4 OVER F.A.I. ROUTE 74 (I-74) RAMPS A-3 AND B-3 F.A.I. ROUTE 74 SECTION (72-7) R-3 PEORIA COUNTY STATION 10+779.03 STRUCTURE NUMBER 072-0183		
PARSONS TRANSPORTATION GROUP CHICAGO, ILLINOIS		
DRAWING NO. 5	SCALE N.T.S.	DATE 2-18-03
		SHEET NO. 5

Time: 09:37:19 AM Date: 1/19/2004 File: c:\p43996\structure\rd\072-0183\Sheet\Tracings\SH0002-10720183.dgn

Designed by: DL
Checked by: AK
Drafted by: FTE
Checked by: AK