

STATE OF ILLINOIS  
DEPARTMENT OF PUBLIC WORKS & BUILDINGS  
DIVISION OF HIGHWAYS

PROJECT NO.	ENC.	COUNTY	SECTION	SHEET NO.
FAI 74-7	7	PEORIA	26	13 SHEETS
FOR ROAD DIST. NO. 7				1300 499

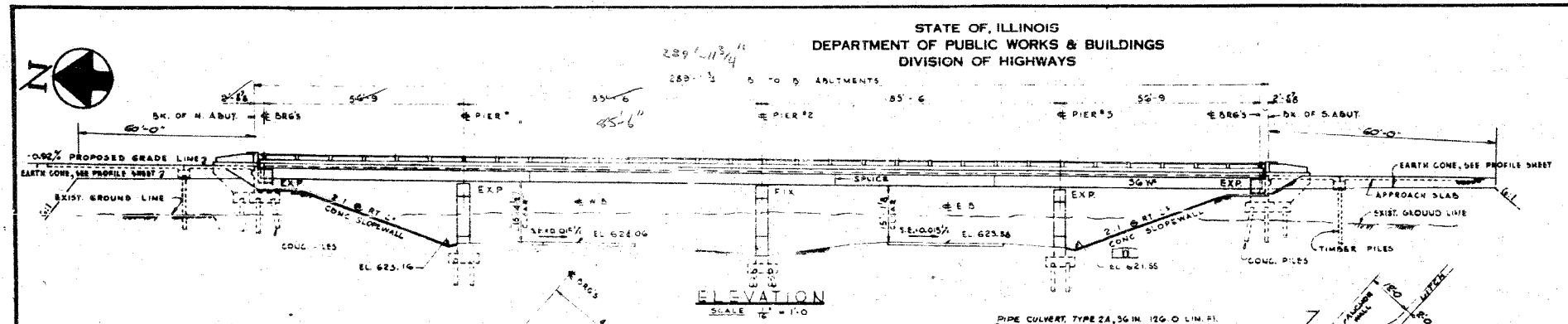

ELEVATION  
SCALE: 1" = 1'-0"

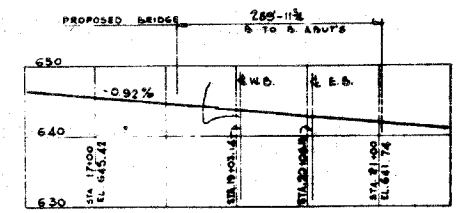

F.A. 31 CONNECTION PROFILE  
SCALE: VERT. 1" = 10'  
HOR. 1" = 100'

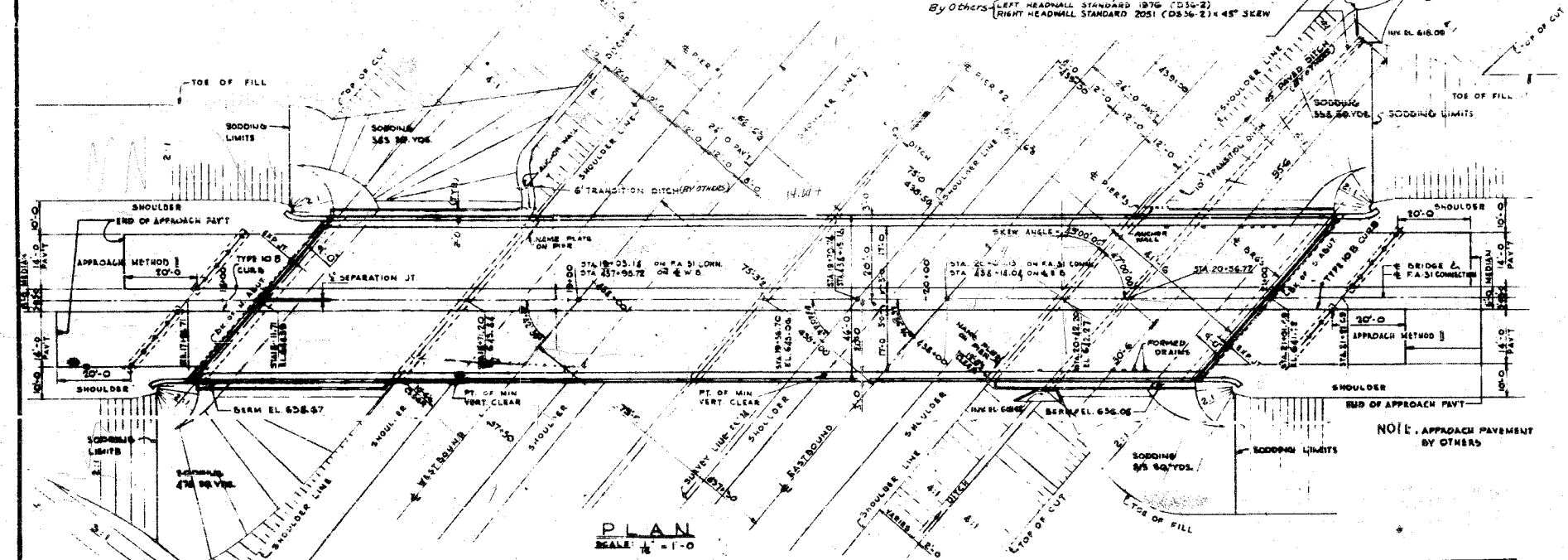

PLAN  
SCALE: 1" = 1'-0"

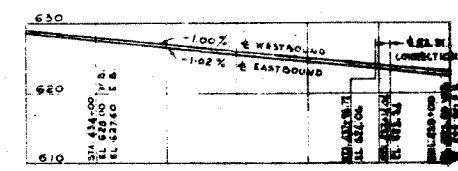

F.A. 174 & PROFILES  
SCALE: VERT. 1" = 10'  
HOR. 1" = 100'

GENERAL NOTES:

- ALL CONCRETE SHALL BE CLASS "X"
- BRIDGE DESIGNED FOR FUTURE 12' WEARING SURFACE @ 20 R.S.P.
- THE CONCRETE FLOOR SLAB SHALL BE FINISHED IN ACCORDANCE WITH ARTICLE 51.10 OF THE STANDARD SPECIFICATIONS. THE CURBS AND SLAB OUTSIDE OF COMPLETIONAL CONSTRUCTION JOINTS, SHOWING ON CROSS SECTION SHALL BE FINISHED MONOLITHICALLY.
- NO TRANSVERSE CONSTRUCTION JOINTS SHALL BE MADE EXCEPT BY WRITTEN PERMISSION OF THE ENGINEER.
- RIVETS 3/4" Ø, OPEN HOLES 1/2" Ø, UNLESS NOTED.
- ALL ROLLERS, ROGERS, BEARING PLATES, LEAD PLATES, PINTLES, SOLE PLATES AND ANCHOR BOLTS SHALL BE FABRICATED AND SET IN ACCORDANCE WITH ART. 51.10 OF THE STANDARD SPECIFICATIONS AND ARE INCLUDED IN WEIGHT OF STRUCTURAL STEEL. ANCHOR BOLTS SHALL BE SET BEFORE DRIVING DIAPHRAGMS OVER SUPPORTS.
- EROSION GUARDS ARE INCLUDED IN WEIGHT OF STRUCTURAL STEEL.
- EXCEPT AS OTHERWISE PROVIDED ALL STRUCTURAL STEEL SHALL RECEIVE ONE SHOP COAT OF RED LEAD PAINT AND TWO FIELD COATS OF ALUMINUM PAINT. SEE ARTICLES 56.1 TO 56.5 INCLUSIVE OF THE STANDARD SPECIFICATIONS. ALL PAINT SHALL BE FURNISHED & APPLIED BY THE CONTRACTOR INVOLVED.
- THE ROADWAY EROSION GUARDS SHALL BE FABRICATED AND BUILT IN ACCORDANCE WITH ART. 51.10 OF THE STANDARD SPECIFICATIONS AND SHALL FIT THE CROWN OF THE ROADWAY.
- THE CONTRACTOR SHALL DRIVE TEST PILES IN A PERMANENT LOCATION, AS SHOWN ON PLANS, BEFORE ORDERING THE REMAINDER OF PILES.
- REINFORCING BARS SHALL BE LAPPED A MINIMUM OF 20 BAR DIAMETERS UNLESS OTHERWISE NOTED.
- LIVE LOADING: 1400 - 810 - 44
- STRUCTURE DESIGNED BY CONTRACTOR WITH AASHTO STANDARD SPECIFICATIONS FOR HIGHWAY BRIDGES, 1951 EDITION.
- CONCRETE AGGREGATE WHICH IS TO BE USED IN END POSTS AND PARAPET WALL MUST BE ABSOLUTELY FREE OF CLAY, SILT, MAGNITE, LISITE AND SOFT SANDSTONE.

ITEM	UNIT	QUANTITY
FURNISHING STRUCTURAL STEEL	LBS	46,710

DESIGN STRESSES:

- $f_s = 18,000$  R.S.I. - STRUCTURAL STEEL
- $f_r = 20,000$  R.S.I. - REINFORCING STEEL
- $f_c = 1,400$  R.S.I. - CONCRETE
- $v = 90$  R.S.I. - SUPERSTRUCTURE
- $n = 10$
- IF THE PILES IN EACH ABUTMENT SHALL BE DRIVEN IN HOLES PRECEDED THROUGH THE EMBANKMENT TO THE NATURAL GROUND LINE, IN ACCORDANCE WITH ARTICLE 609 (C) OF THE STANDARD SPECIFICATIONS.
- WHENEVER IN THESE PLANS REFERENCE IS MADE TO THE "STANDARD SPECIFICATIONS", IT IS UNDERSTOOD TO INCLUDE THE "SUPPLEMENTAL SPECIFICATIONS", EFFECTIVE APRIL 2, 1942.
- SLOPE SHALL BE REINFORCED WITH WELDED WIRE FABRIC 6" X 6" MESH WEIGHING 50# PER 100 SQ. FT.

DESIGNED	M. KYEMAS	19
CHECKED	K. MATKOVICUS	PASSED
DRAWN	K. MATKOVICUS	APPROVED
CHECKED	A. MILLUMS	

BILL OF MATERIALS SECTION 72-7HB-1

ITEM	UNIT	QUANTITY
EARTH EXCAVATION	CU. YDS.	26,791
CLASS X EXCAVATION FOR STRUCTURES	CU. YDS.	523.0
CLASS X CONCRETE	CU. YDS.	898.9
ERECTING STRUCTURAL STEEL	LBS.	46,710
ALUMINUM HANDRAIL	LIN. FT.	574
PIPE CULVERTS, TYPE 2A, 36"	LIN. FT.	126
EXTENDED FLUENT PILES	LBS.	156,770
FURNISHING GROSSED PILES UP TO 20'	LIN. FT.	400
FURNISHING GROSSED PILES 20.1' TO 36'	LIN. FT.	4100
TEST PILES (TIMBER)	EACH	8
DRIVING TIMBER PILES	LIN. FT.	4088
DRIVING CONCRETE PILES	LIN. FT.	1900
FURNISHING CONCRETE PILES	LIN. FT.	1664
TEST PILES (CONCRETE)	EACH	8
NAME PLATES	EACH	8
SLOPE WALL, 4 INCH	SQ. YDS.	583
Protective Coat	Sq. Yds.	1675
SODDING	SQ. YDS.	1888

JOHN F. MEISSNER ENGINEERS  
CHICAGO, ILLINOIS  
ENR. NO. 56-107-1

GENERAL PLAN & ELEVATION  
F.A.I. ROUTE 74 SECTION 72-7-HB-1  
PROJECT 1-74-4 (63)88  
F.A. ROUTE 31 CONNECTION - GRADE SEPARATION  
PEORIA COUNTY - STATION 438 + 15.10

REVISION	NO.	DATE	DESCRIPTION