

STATE OF ILLINOIS
DEPARTMENT OF PUBLIC WORKS & BUILDINGS
DIVISION OF HIGHWAYS

ROUTE NO.	SEC.	COUNTY	TOTAL SHEETS	SHEET NO.	SHEET NO.
1A 31 1172	Peoria	Peoria	783	36	
PEORIA ROAD DIST. NO. 7					1360 551

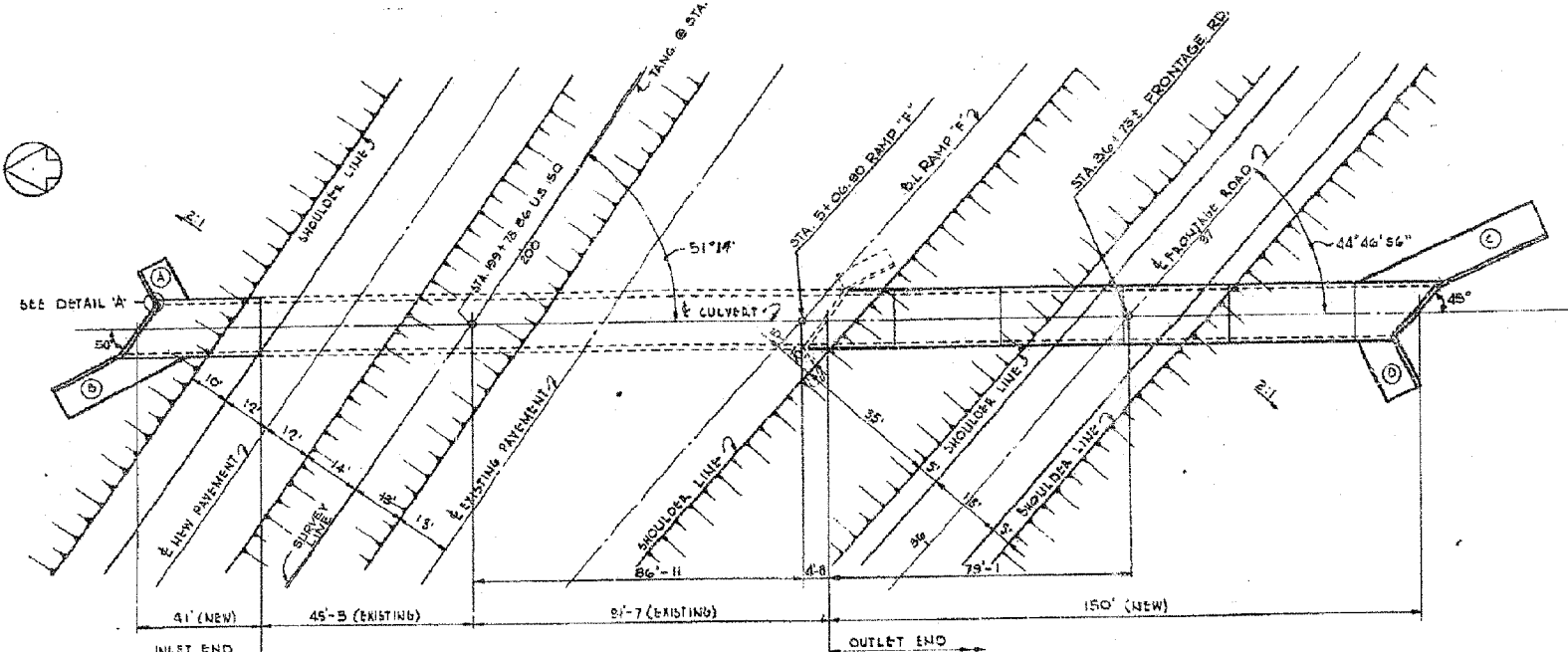

PLAN

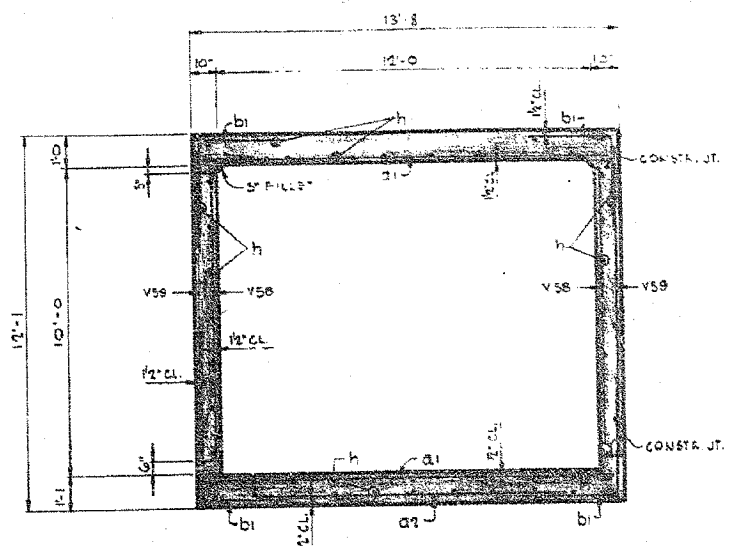

TYPICAL SECTION THRU BARREL

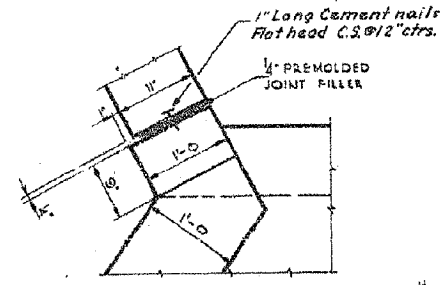

DETAIL A

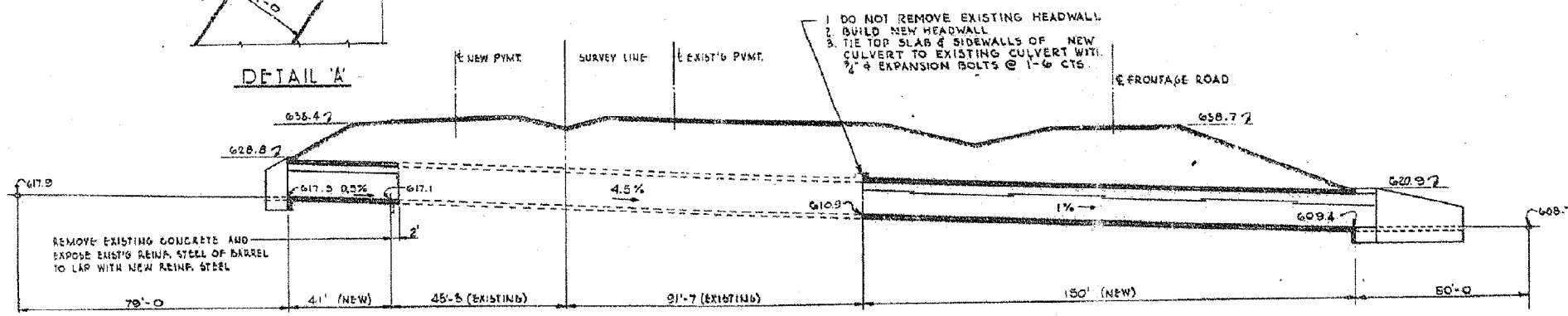

LONGITUDINAL SECTION

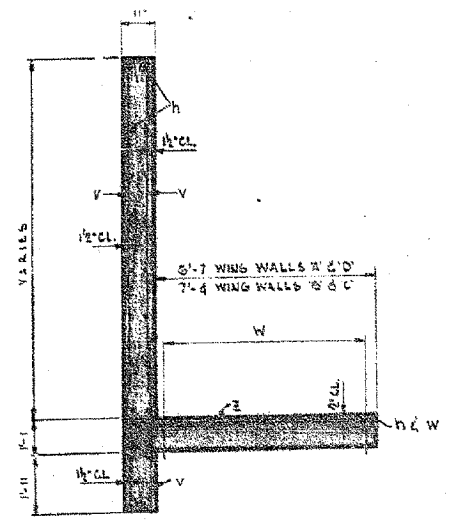

TYPICAL SECTION THRU WING WALLS A, B, C & D

JOHN F. MEISSNER ENGINEERS INC.
CHICAGO, ILLINOIS
DWG. NO. 55-102-L-8903

DESIGNED E.H.MAYO
CHECKED A.MILUNAS
DRAWN W.J.PAWLIKOWSKI
CHECKED A.MILUNAS

BILL OF MATERIAL (INLET & OUTLET ENDS)		
ITEM	UNIT	QUANT.
CLASS 'X' CONCRETE	CU. YDS.	375.4
REINFORCEMENT BARS	LBS.	98,170
EXPANSION BOLTS 3/4"	EACH	28

DESIGN STRESSES:
 $f_s = 20,000$ PSI
 $f_c = 1,000$ PSI FOR WING WALLS
 $f_c = 1,400$ PSI FOR BARREL
 $n = 10$
 NO LIVE LOADING

NOTES:
 CLASS 'X' CONCRETE SHALL BE USED THROUGH-OUT.
 EXPOSED EDGES SHALL BE BEVELLED 3/4"
 FOR BACKFILLING & EMBANKMENT SEE
 STANDARD SPECIFICATIONS.

DRAINAGE STRUCTURE
 AT STATION 199+78.86
 EXTENSION LEFT AND RIGHT
 PEORIA COUNTY

Rev. 5-6-63 105 Rev. Detail A. Rev. Design Stresses: f_c 1200 to 1000 PSI. Rev. Quant. Reinf. 34110# to 48170#