

F.A.I. RTE.	SECTION	COUNTY	TOTAL SHEETS	SHEET NO.
74	(72-7)R-3	PEORIA	7360	934
STA. 145+050		TO STA. 145+390		
FED. ROAD DIST. NO.	ILLINOIS	FED. AID PROJECT		

TRAFFIC CONTROL  
PROJECT STANDARD 701411-174

WORK ZONE	EX TEMPORARY CONCRETE BARRIER OR TEMPORARY CONCRETE BARRIER
TRAFFIC FLOW DIRECTION	VERTICAL PANEL
LANE(S) CLOSED	BARRICADE TYPE I OR TYPE II OR DRUM
ARROW BOARD	SIGN
DRUM WITH STEADY BURNING MONODIRECTIONAL LIGHT	CONSTRUCTION SPEED LIMIT SIGN
TYPE III BARRICADE WITH FLASHING LIGHT	FLAGGER WITH TRAFFIC CONTROL SIGN
TYPE III BARRICADE	BARRICADE OR DRUM WITH STEADY BURNING MONODIRECTIONAL LIGHT
	BARRICADE OR DRUM WITH FLASHING LIGHT

NOTES:  
1. ALL REQUIRED PAVEMENT MARKINGS MUST BE IN PLACE PRIOR TO SHIFTING TRAFFIC.

PROJECT STANDARD 701411-174 SHALL BE USED TO CLOSE RAMP C-3 AND RAMP C-4. IN ADDITION TYPE III BARRICADES, PER PROJECT STANDARD 701411-174, SHALL BE INSTALLED AT THE TOP OF RAMP C-3.

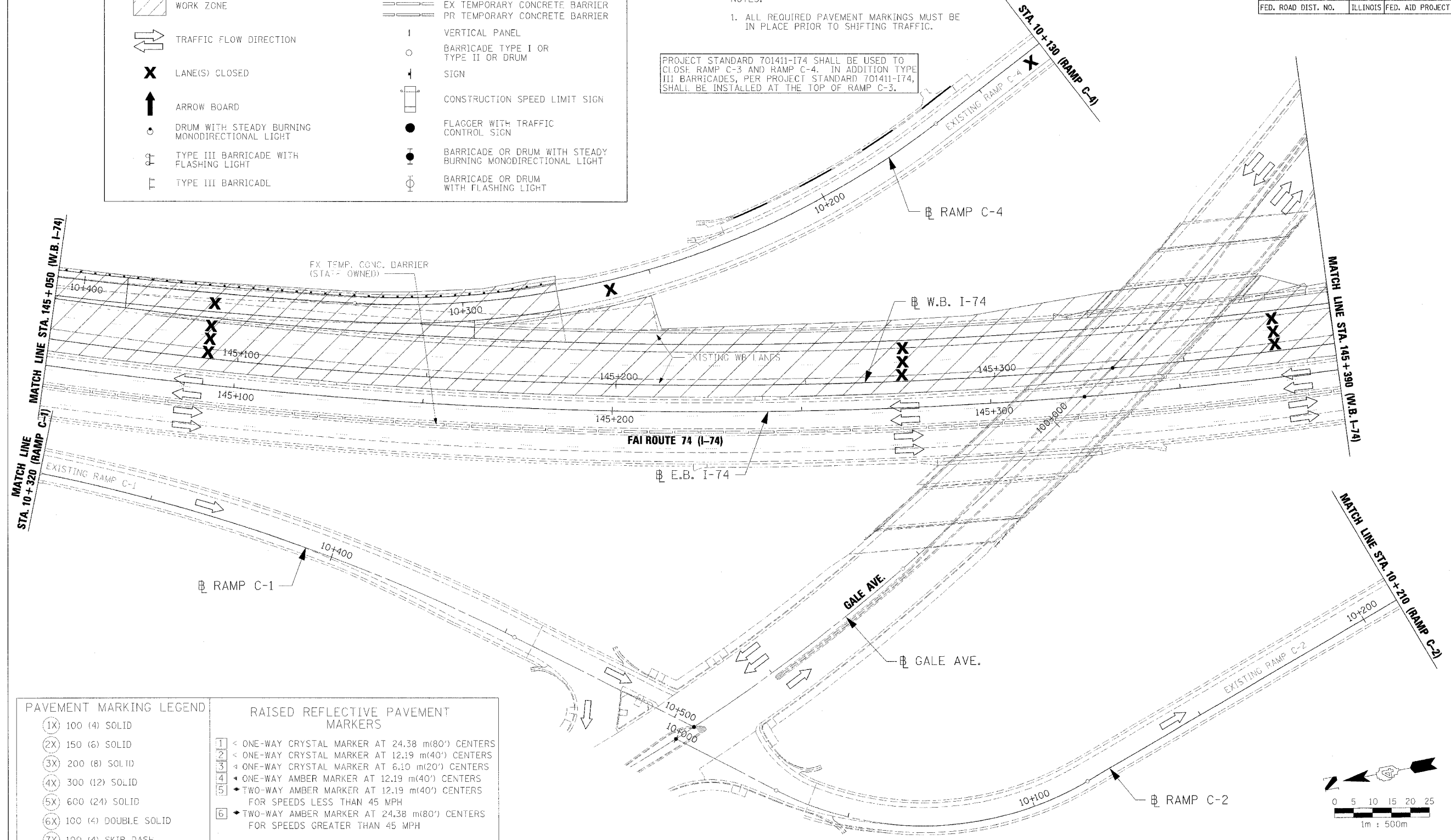

(1X)	100 (4) SOLID
(2X)	150 (6) SOLID
(3X)	200 (8) SOLID
(4X)	300 (12) SOLID
(5X)	600 (24) SOLID
(6X)	100 (4) DOUBLE SOLID
(7X)	100 (4) SKIP DASH
(8X)	150 (6) SKIP DASH
(9X)	200 (8) SKIP DASH
(10X)	200 (8) DOTTED
(11X)	LETTERS AND ARROWS

1	< ONE-WAY CRYSTAL MARKER AT 24.38 m(80') CENTERS
2	< ONE-WAY CRYSTAL MARKER AT 12.19 m(40') CENTERS
3	< ONE-WAY CRYSTAL MARKER AT 6.10 m(20') CENTERS
4	< ONE-WAY AMBER MARKER AT 12.19 m(40') CENTERS
5	< TWO-WAY AMBER MARKER AT 12.19 m(40') CENTERS FOR SPEEDS LESS THAN 45 MPH
6	< TWO-WAY AMBER MARKER AT 24.38 m(80') CENTERS FOR SPEEDS GREATER THAN 45 MPH

WHERE "X" DESIGNATES:  
E = EPOXY  
P = PAINT  
T = THERMOPLASTIC  
U = POLYUREA  
TP = TEMPORARY PAVEMENT MARKING  
T3 = PAVEMENT MARKING TAPE, TYPE III  
W3 = WET TEMPORARY PAVEMENT MARKING TAPE, TYPE III  
All dimensions are in millimeters (inches) unless otherwise shown.

—	WHITE
—	YELLOW

NAME	DATE

ILLINOIS DEPARTMENT OF TRANSPORTATION  
MAINTENANCE OF TRAFFIC  
STAGE 3-2  
WB STA. 145+050 - STA. 145+390  
DATE 11/23/04  
DRAWN BY ROY  
CHECKED BY LSA

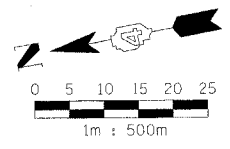

11/23/04 10:58:23 AM C:\PROJECTS\74\74-7\74-7R-3\74-7R-3-934.dwg