

TRAFFIC CONTROL  
PROJECT STANDARD 701411-174

F.A.I. RTE.	SECTION	COUNTY	TOTAL SHEETS	SHEET NO.
74	72-TR-3	PEORIA	136	940
STA. 145+390		TO STA. 145+730		
FED. ROAD DIST. NO.		ILLINOIS FED. AID PROJECT		

NOTES:  
1. ALL REQUIRED PAVEMENT MARKINGS MUST BE IN PLACE PRIOR TO SHIFTING TRAFFIC.

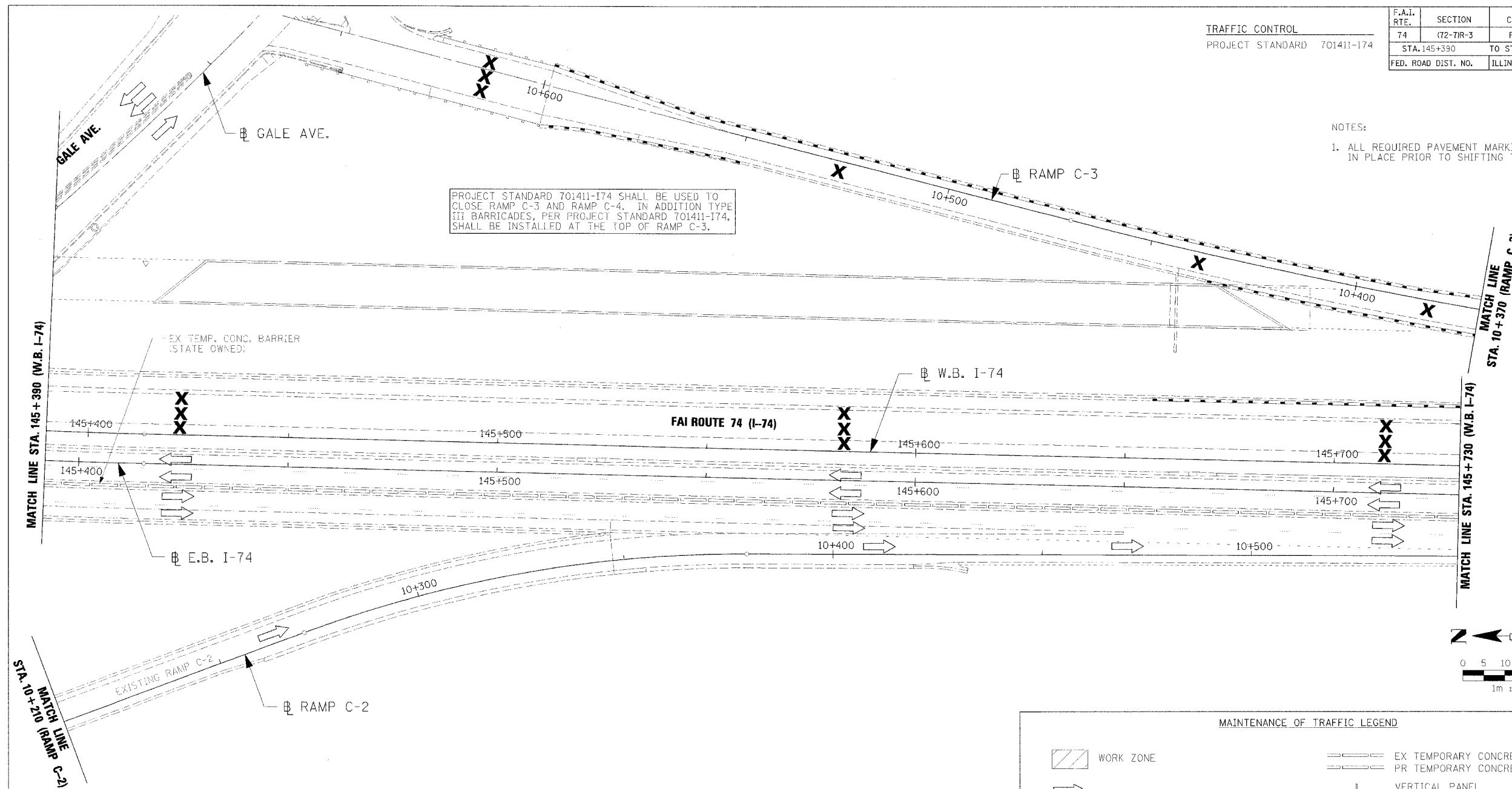

PROJECT STANDARD 701411-174 SHALL BE USED TO CLOSE RAMP C-3 AND RAMP C-4. IN ADDITION TYPE III BARRICADES, PER PROJECT STANDARD 701411-174, SHALL BE INSTALLED AT THE TOP OF RAMP C-3.

PAVEMENT MARKING LEGEND

- 1X 100 (4) SOLID
- 2X 150 (6) SOLID
- 3X 200 (8) SOLID
- 4X 300 (12) SOLID
- 5X 600 (24) SOLID
- 6X 100 (4) DOUBLE SOLID
- 7X 100 (4) SKIP DASH
- 8X 150 (6) SKIP DASH
- 9X 200 (8) SKIP DASH
- 10X 200 (8) DOTTED
- 11X LETTERS AND ARROWS

RAISED REFLECTIVE PAVEMENT MARKERS

- 1 ONE-WAY CRYSTAL MARKER AT 24.38 m(80') CENTERS
- 2 ONE-WAY CRYSTAL MARKER AT 12.19 m(40') CENTERS
- 3 ONE-WAY CRYSTAL MARKER AT 6.10 m(20') CENTERS
- 4 ONE-WAY AMBER MARKER AT 12.19 m(40') CENTERS
- 5 TWO-WAY AMBER MARKER AT 12.19 m(40') CENTERS FOR SPEEDS LESS THAN 45 MPH
- 6 TWO-WAY AMBER MARKER AT 24.38 m(80') CENTERS FOR SPEEDS GREATER THAN 45 MPH

WHERE "X" DESIGNATES:

- E = EPOXY
- P = PAINT
- T = THERMOPLASTIC
- U = POLYUREA
- TP= TEMPORARY PAVEMENT MARKING
- T3= PAVEMENT MARKING TAPE, TYPE III
- W3= WET TEMPORARY PAVEMENT MARKING TAPE, TYPE III

- WHITE
- YELLOW

All dimensions are in millimeters (inches) unless otherwise shown.

MAINTENANCE OF TRAFFIC LEGEND

- WORK ZONE
- TRAFFIC FLOW DIRECTION
- LANE(S) CLOSED
- ARROW BOARD
- DRUM WITH STEADY BURNING MONODIRECTIONAL LIGHT
- TYPE III BARRICADE WITH FLASHING LIGHT
- TYPE III BARRICADE
- EX TEMPORARY CONCRETE BARRIER
- PR TEMPORARY CONCRETE BARRIER
- VERTICAL PANEL
- BARRICADE TYPE I OR TYPE II OR DRUM
- SIGN
- CONSTRUCTION SPEED LIMIT SIGN
- FLAGGER WITH TRAFFIC CONTROL SIGN
- BARRICADE OR DRUM WITH STEADY BURNING MONODIRECTIONAL LIGHT
- BARRICADE OR DRUM WITH FLASHING LIGHT

REVISIONS

NAME	DATE

ILLINOIS DEPARTMENT OF TRANSPORTATION

MAINTENANCE OF TRAFFIC  
STAGE 3-3  
WB STA. 145+390 - STA. 145+730

DRAWN BY RDY  
CHECKED BY LSA

DATE 11/23/04

