

F.A.I. RTE.	SECTION	COUNTY	TOTAL SHEETS	SHEET NO.
74	(72-7R-3)	PEORIA	1360	973
STA. 145+390		TO STA. 145+730		
FED. ROAD DIST. NO.		ILLINOIS FED. AID PROJECT		

- NOTES:
1. ALL STATIONS INDICATED ON PLANS ARE WESTBOUND EXCEPT WHERE NOTED OTHERWISE.
 2. SEE MAINTENANCE OF TRAFFIC SHEETS FOR REMOVAL, RELOCATION AND INSTALLATION OF TEMPORARY CONCRETE BARRIERS.

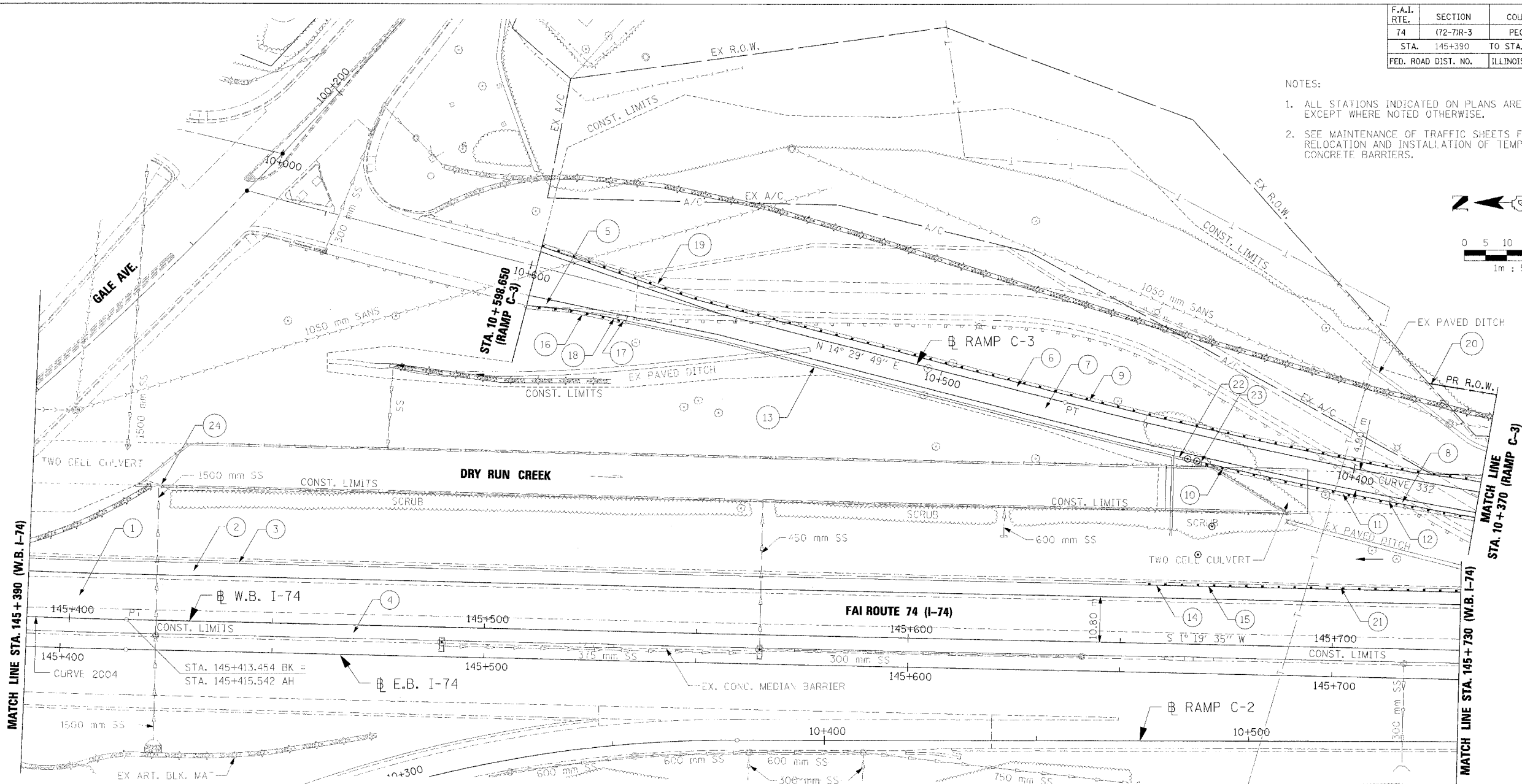
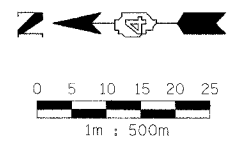

- ① CONT. REINF. PCC PYMI., 290 mm, BIT. CONC. BIND. CSE., 150 mm, AGG. SUB-BASE, 300 mm, WB LT. STA. 145+390.000 TO STA. 145+730.000
- ② PCC SHLD., 290 mm, BIT. CONC. BIND. CSE., 150 mm, AGG. SUB-BASE, 300 mm, WB RT. STA. 145+390.000 TO STA. 145+730.000
- ③ AGG. SHLD., TY. B, WB LT. STA. 145+390.000 TO STA. 145+655.430
- ④ PCC SHLD., 290 mm, BIT. CONC. BIND. CSE., 150 mm, AGG. SUB-BASE, 300 mm, WB RT. STA. 145+390.000 TO STA. 145+730.000
- ⑤ PCC SHLD., 250 mm, BIT. CONC. BIND. CSE., 100 mm, AGG. SUB-BASE, 300 mm, RAMP C-3 LT. STA. 10+575.000 TO STA. 10+598.650
- ⑥ PCC SHLD., 250 mm, BIT. CONC. BIND. CSE., 100 mm, AGG. SUB-BASE, 300 mm, RAMP C-3 RT. STA. 10+370.000 TO STA. 10+598.650
- ⑦ PCC PVMT. (JOINTED), 250 mm, BIT. CONC. BIND. CSE., 100 mm, AGG. SUB-BASE, 300 mm, RAMP C-3 STA. 10+370.000 TO STA. 10+598.650
- ⑧ PCC SHLD., 250 mm, BIT. CONC. BIND. CSE., 100 mm, AGG. SUB-BASE, 300 mm, RAMP C-3 LT. STA. 10+370.000 TO STA. 10+442.000
- ⑨ STEEL PLATE BEAM GUARDRAIL, TYPE A, RAMP C-3 RT. STA. 10+370.000 TO STA. 10+598.650
- ⑩ TRAFFIC BARRIER TERMINAL, TYPE 6, RAMP C-3 LT. STA. 10+431.342 TO STA. 10+435.380
- ⑪ GUARDRAIL AGG. EROSION CONTROL, RAMP C-3 LT. STA. 10+370.000 TO STA. 10+435.380

- ⑫ STEEL PLATE BEAM GUARDRAIL, TYPE A, RAMP C-3 LT. STA. 10+370.000 TO STA. 10+431.342
- ⑬ SEE RAMP C-3, MSE WALL NO. 18B, STRUCTURAL PLANS
- ⑭ TRAFFIC BARRIER TERMINAL, TYPE 2, WB LT. STA. 145+656.329 TO STA. 145+660.680
- ⑮ STEEL PLATE BEAM GUARDRAIL, TYPE A, WB LT. STA. 145+660.680 TO STA. 145+730.000
- ⑯ GUARDRAIL AGG. EROSION CONTROL, RAMP C-3 LT. STA. 10+575.000 TO STA. 10+598.650
- ⑰ TRAFFIC BARRIER TERMINAL, TYPE 6, RAMP C-3 LT. STA. 10+575.000 TO STA. 10+579.038
- ⑱ STEEL PLATE BEAM GUARDRAIL, TYPE A, RAMP C-3 LT. STA. 10+579.038 TO STA. 10+598.650
- ⑲ GUARDRAIL AGG. EROSION CONTROL, RAMP C-3 RT. STA. 10+370.000 TO STA. 10+598.650
- ⑳ CHAIN LINK FENCE, 1.2 m, RAMP C-3 RT. STA. 10+370.000 TO STA. 10+387.285
- ㉑ GUARDRAIL AGG. EROSION CONTROL, WB LT. STA. 145+655.430 TO STA. 145+730.000

- ㉒ TRANS. FROM MSE WALL TO CONC. BARRIER, SINGLE FACE (MOD.), TRANS. TO BE PAID FOR AS CONC. BARRIER, SINGLE FACE (MOD.), RAMP C-3 LT. STA. 10+440.000 TO STA. 10+442.000
- ㉓ CONC. BARRIER, SINGLE FACE (MOD.), RAMP C-3 LT. STA. 10+435.380 TO STA. 10+440.000
- ㉔ CHAIN LINK FENCE, 1.2 m, WB LT. STA. 145+416.847 TO STA. 145+422.500

* BITUMINOUS CONCRETE BINDER COURSE, SUPERPAVE, IL-19.3L (LOW ESAL)

REVISIONS	
NAME	DATE

ILLINOIS DEPARTMENT OF TRANSPORTATION
 PROPOSED ROADWAY PLAN
 FAI ROUTE 74 (I-74)
 WB STA. 145+390 - STA. 145+730
 DATE 11/23/04
 DRAWN BY CAM
 CHECKED BY LSA

