

F.A.I. RTE.	SECTION	COUNTY	TOTAL SHEETS	SHEET NO.
74	(72-7)R-3	PEORIA	1360	974
STA.	145+730	TO STA.	146+070	
FED. ROAD DIST. NO.	ILLINOIS FED. AID PROJECT			

NOTES:
 1. ALL STATIONS INDICATED ON PLANS ARE WESTBOUND EXCEPT WHERE NOTED OTHERWISE.
 2. SEE MAINTENANCE OF TRAFFIC SHEETS FOR REMOVAL, RELOCATION AND INSTALLATION OF TEMPORARY CONCRETE BARRIERS.

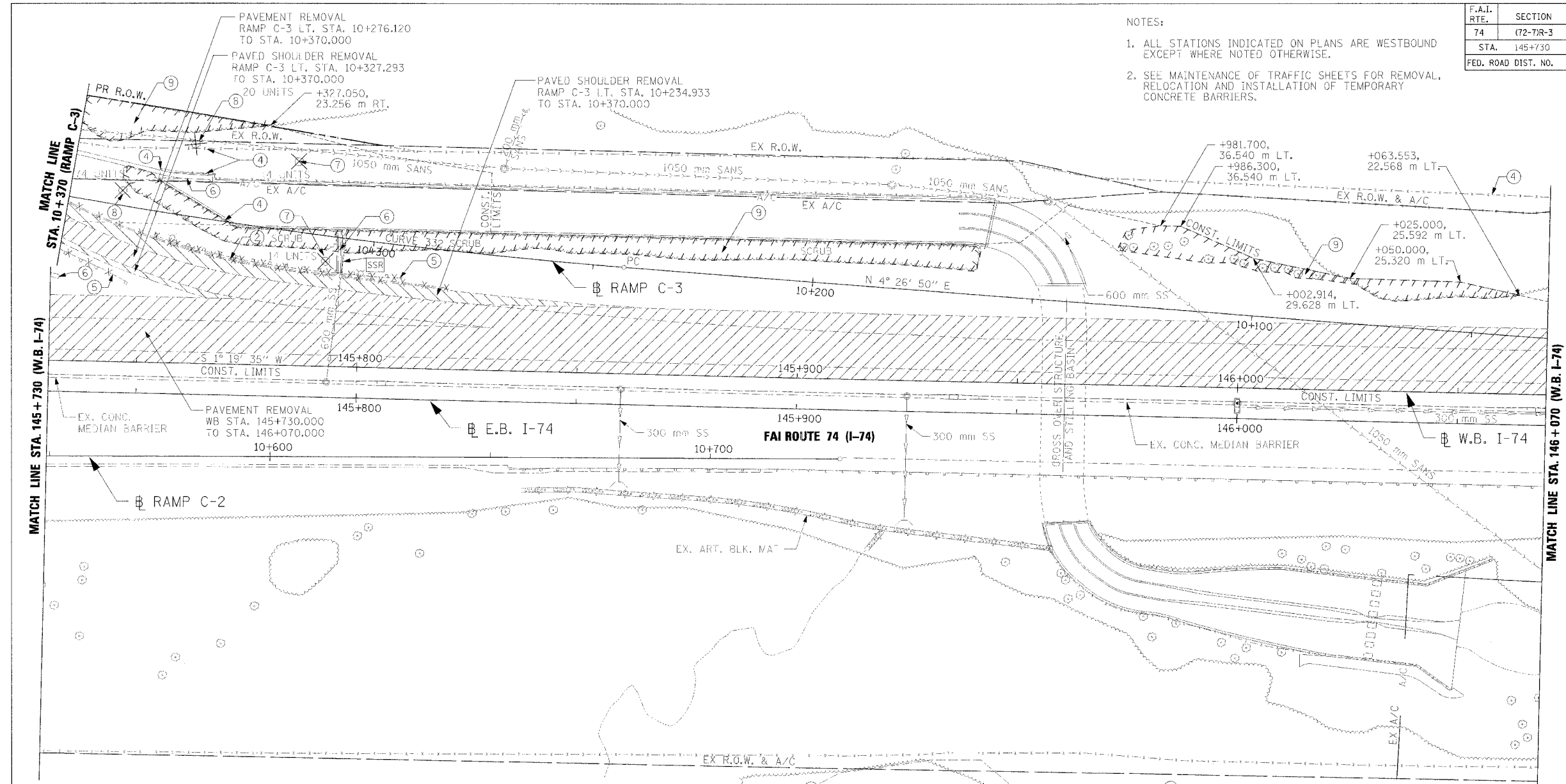

REMOVAL LEGEND AND KEY

	PAVEMENT REMOVAL	①	X LIGHTING FIXTURE & FOUNDATION REMOVAL	[A]	FRAME AND GRATE TO BE ADJUSTED	⑧	TREE REMOVAL (OVER 15 UNITS DIA.)
	SHOULDER REMOVAL	②	COMBINATION CONCRETE CURB AND GUTTER REMOVAL	[A]	FRAME AND LID TO BE ADJUSTED	⑨	TREE REMOVAL (HECTARES)
	DRIVEWAY PAVEMENT REMOVAL	③	BITUMINOUS SURFACE REMOVAL 300mm WIDTH x 40mm DEPTH	[Adj]	STRUCTURE TO BE ADJUSTED		
	SIDEWALK REMOVAL	④	FENCE REMOVAL	[AB]	ITEM TO BE ABANDONED		
	CURB & GUTTER REMOVAL	⑤	GUARDRAIL REMOVAL	[M]	ITEM TO BE MOVED		
	GUARDRAIL REMOVAL	⑥	PAVED DITCH REMOVAL	[C]	STRUCTURE TO BE CLEANED		
	BITUMINOUS SURFACE REMOVAL	⑦	TREE REMOVAL (6-15 UNITS DIA.)	[F]	STRUCTURE TO BE FILLED		
	BITUMINOUS TAPER (FOR BUTT JOINTS)	⑧	TREE REMOVAL (OVER 15 UNITS DIA.)	[R]	STRUCTURE TO BE REMOVED		
		⑨	TREE REMOVAL (HECTARES)	[REC]	STRUCTURE TO BE RECONSTRUCTED		
				[SSR]	STORM SEWER REMOVAL		
				[SP]	SPECIAL ADJUSTMENT		

- ② COMB. CONC. C&G REMOVAL
RAMP C-3 LT. STA. 10+282.120 TO STA. 10+370.000
- ④ FENCE REMOVAL
WB LT. STA. 145+967.506 TO STA. 146+070.000
RAMP C-3 RT. STA. 10+250.000 TO STA. 10+350.655
RAMP C-3 RT. STA. 10+275.000 TO STA. 10+350.400
RAMP C-3 RT. STA. 10+292.950 TO STA. 10+370.000
RAMP C-3 STA. 10+350.400, 9.750 m RT. TO STA. 10+350.655, 6.950 m RT.
- ⑤ GUARDRAIL REMOVAL
RAMP C-3 LT. STA. 10+292.555 TO STA. 10+349.540
RAMP C-3 LT. STA. 10+353.795 TO STA. 10+370.000
- ⑥ PAVED DITCH REMOVAL
WB LT. STA. 145+730.000 TO STA. 145+731.840
RAMP C-3 STA. 10+307.022, 7.937 m LT. TO STA. 10+308.031, 1.389 m RT.
RAMP C-3 RT. STA. 10+338.050 TO STA. 10+370.000
- ⑦ TREE REMOVAL (6-15 UNITS DIA.)
RAMP C-3 STA. 10+310.425, 5.710 m LT.
RAMP C-3 STA. 10+319.390, 15.995 m RT.
- ⑧ TREE REMOVAL (OVER 15 UNITS DIA.)
RAMP C-3 STA. 10+343.440, 16.485 m RT.
RAMP C-3 STA. 10+358.255, 3.435 m RT.
- ⑨ TREE REMOVAL (HECTARES)
WB LT. STA. 145+971.983 TO STA. 146+063.553
RAMP C-3 STA. 10+162.450 TO STA. 10+358.960
RAMP C-3 RT. STA. 10+327.050 TO STA. 10+370.000
- [SSR] STORM SEWER REMOVAL, 600 mm
WB STA. 145+793.097, 3.500 m RT. TO STA. 145+797.179, 31.904 m LT.

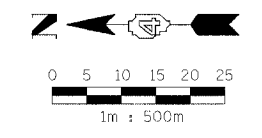

REVISIONS	
NAME	DATE



ILLINOIS DEPARTMENT OF TRANSPORTATION
 EXISTING ROADWAY PLAN
 FAI ROUTE 74 (I-74)
 WB STA. 145+730 - STA. 146+070
 DRAWN BY CAM
 CHECKED BY LSA
 DATE 11/23/04