

STRUCTURE SCHEDULE											
STR. NO.	STATION	OFFSET	TYPE	F&G	EB RIM EL.	WB RIM EL.	INV. N	INV. S	INV. E	INV. W	REMARKS
400	C3 10+300.000	17.367 m RT	MED. INLET (604106)			166.200	-	-	-	164.575	
401	145+984.000	11.688 m LT	MAN A 1.2D	T1F OL		169.601	S.V.D. pipe	-	167.885	-	
402	145+984.000	29.540 m LT	PRC FL-END SEC, 600						166.873	166.972	
411	C3 10+306.571	11.278 m LT	MAN A 1.2D	MI 604101		170.014		167.953	165.859	166.103	
412	C3 10+250.000	8.456 m LT	MED. INLET (604101)			169.890	168.235				
413	C3 10+186.795	2.400 m RT	DR STR T1A	T20 F&G		169.827		168.075			
414	C3 10+184.565	2.400 m RT	DR STR T1A	T20 F&G		169.808	168.058		165.730		

F.A.I. RTE.	SECTION	COUNTY	TOTAL SHEETS	SHEET NO.
74	(72-71R-3	PEORIA	136	99
STA. 145+730		TO STA. 146+070		
FED. ROAD DIST. NO.		ILLINOIS FED. AID PROJECT		

- NOTES:
- ALL STATIONS INDICATED ON PLANS ARE WESTBOUND EXCEPT WHERE NOTED OTHERWISE.
 - PIPE UNDERDRAINS TO BE OUTLETTED TO EACH DRAINAGE STRUCTURE. SEE SPECIAL PROVISIONS FOR ADDITIONAL INFORMATION.
 - ALL WESTBOUND RIM ELEVATIONS FOR THE MEDIAN STRUCTURES WERE SET BY OTHERS IN A PREVIOUS CONTRACT. RIM ELEVATION TO BE FIELD VERIFIED AND ADJUSTED AS REQUIRED. PAYMENT FOR ADJUSTMENTS SHALL BE PER ARTICLE 109.04 OF THE STANDARD SPECIFICATIONS FOR ROAD AND BRIDGE CONSTRUCTION.

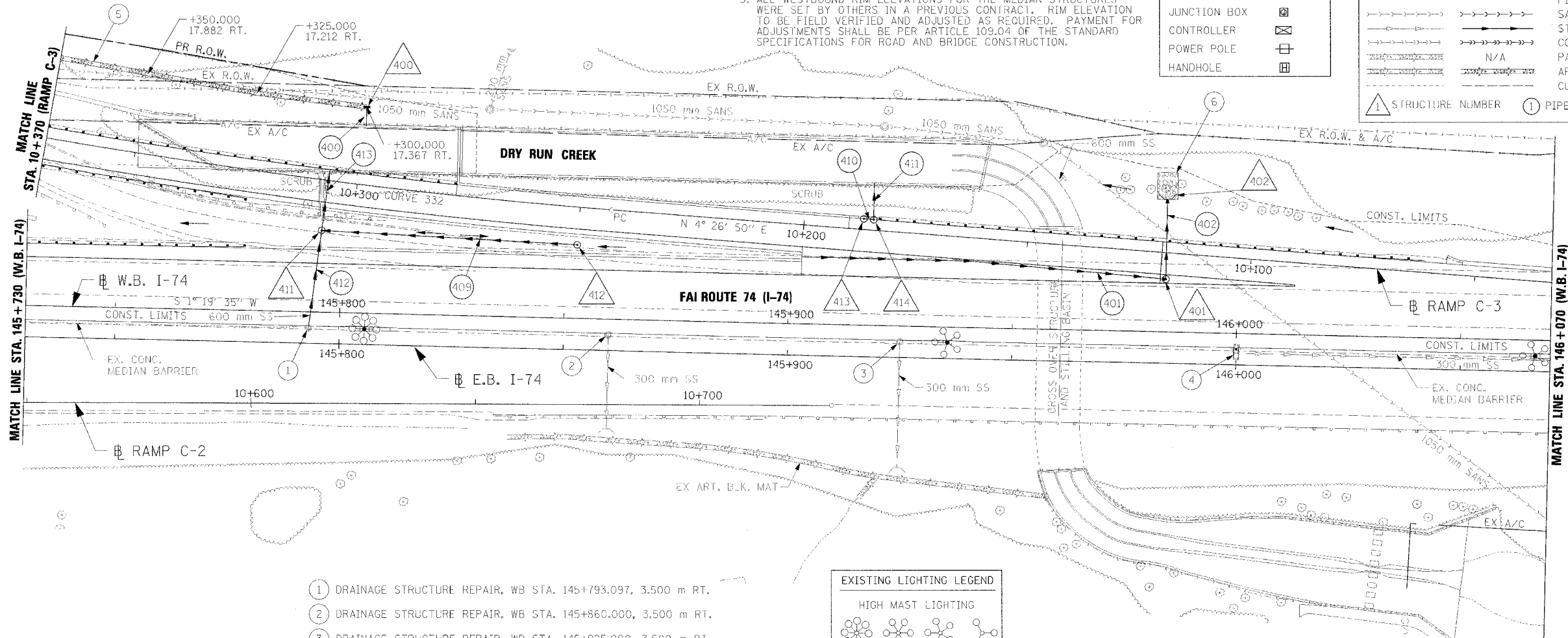
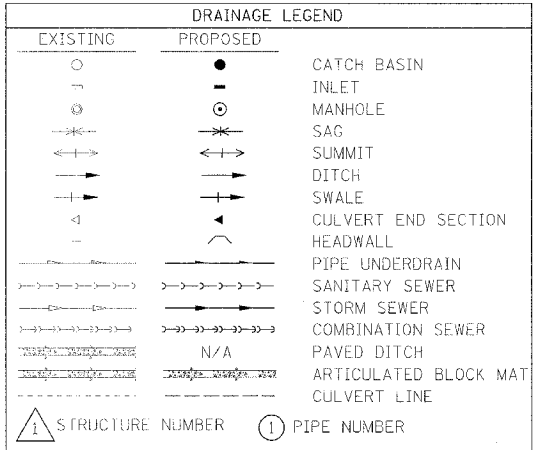
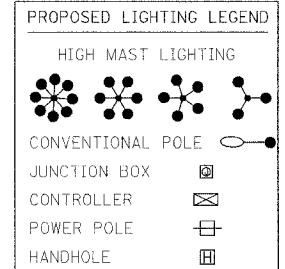

- DRAINAGE STRUCTURE REPAIR, WB STA. 145+793.097, 3.500 m RT.
- DRAINAGE STRUCTURE REPAIR, WB STA. 145+860.000, 3.500 m RT.
- DRAINAGE STRUCTURE REPAIR, WB STA. 145+925.000, 3.500 m RT.
- DRAINAGE STRUCTURE REPAIR, WB STA. 146+000.000, 3.500 m RT.
- ART. BLK. MAT, RAMP C-3 RT, STA. 10+300.000 TO STA. 10+370.000, LENGTH = 69.059 m
- STONE RIPRAP, CLASS A4, FILTER FABRIC FOR USE WITH RIPRAP, WB LT. STA. 145+981.700 TO STA. 145+986.300

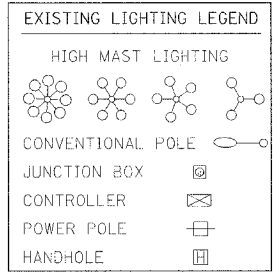

PIPE SCHEDULE									
PIPE NO.	U/S - D/S	LENGTH (m)	SIZE (mm)	CLASS/TYPE	U/S INV	D/S INV	SLOPE	T.B. SPL (cu. m)	REMARKS
400	400 - C3 10+300.000, 12.950 m RT	4.5	900	SS CL A 2	164.575	164.500	1.667%	-	SEE STRUCTURE PLANS FOR CULVERT PENETRATION DETAIL STANDARD 601701-D4
401	145+902.610, 13.754 m LT - 401	81.4	375	SLOTTED VANE DRAIN	-	-	-	-	
402	401 - 402	18.0	600	SS CL A 2	167.885	166.972	5.072%	3.162	
409	412 - 411	56.5	300	SS CL A 2	168.235	167.953	0.499%	-	
410	413 - 414	1.0	300	SS CL A 2	168.075	168.058	1.700%	0.747	
411	414 - C3 10+185.019, 10.638 m RT	8.0	300	SS CL A 3	165.730	165.200	6.625%	7.911	SEE STRUCTURE PLANS FOR FLUME PENETRATION DETAIL
412	145+793.097, 3.500 m RT - 411	20.5	600	SS CL A 4	167.840	166.103	7.498%	89.073	
413	411 - 145+797.140, 31.570 m LT	13.0	600	SS CL A 4	165.859	164.670	9.146%	100.071	SEE STRUCTURE PLANS FOR CULVERT PENETRATION DETAIL

REVISIONS	
NAME	DATE

ILLINOIS DEPARTMENT OF TRANSPORTATION

PROPOSED DRAINAGE & UTILITIES PLAN
FAI ROUTE 74 (I-74)
WB STA. 145+730 - STA. 146+070

DATE 11/23/04

DRAWN BY CAM
CHECKED BY KSD

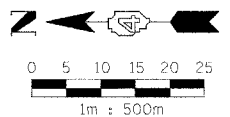

I:\Projects\2004\11-23-04\11-23-04.dwg 11/23/04 08:55:48 AM