

F.A.I. RTE.	SECTION	COUNTY	TOTAL SHEETS	SHEET NO.
74	(72-7)R-3	PEORIA	1360	1001
STA. 145+838.673		TO STA. 146+012.776		
FED. ROAD DIST. NO.		ILLINOIS	FED. AID PROJECT	

OFFSETS ARE BASED ON WB MAIN LINE 74

① 170.015, 16.674 m LT.	⑩ 169.927, 14.811 m LT.
② 169.933, 16.306 m LT.	⑪ 169.867, 14.789 m LT.
③ 169.910, 16.015 m LT.	⑫ 169.807, 14.767 m LT.
④ 169.941, 15.718 m LT.	⑬ 169.757, 14.066 m LT.
⑤ 169.966, 15.470 m LT.	⑭ 169.708, 13.365 m LT.
⑥ 169.994, 15.198 m LT.	⑮ 169.658, 12.663 m LT.
⑦ 170.022, 14.925 m LT.	⑯ 169.608, 11.962 m LT.
⑧ 170.030, 14.850 m LT.	⑰ 169.595, 11.775 m LT.
⑨ 169.987, 14.834 m LT.	

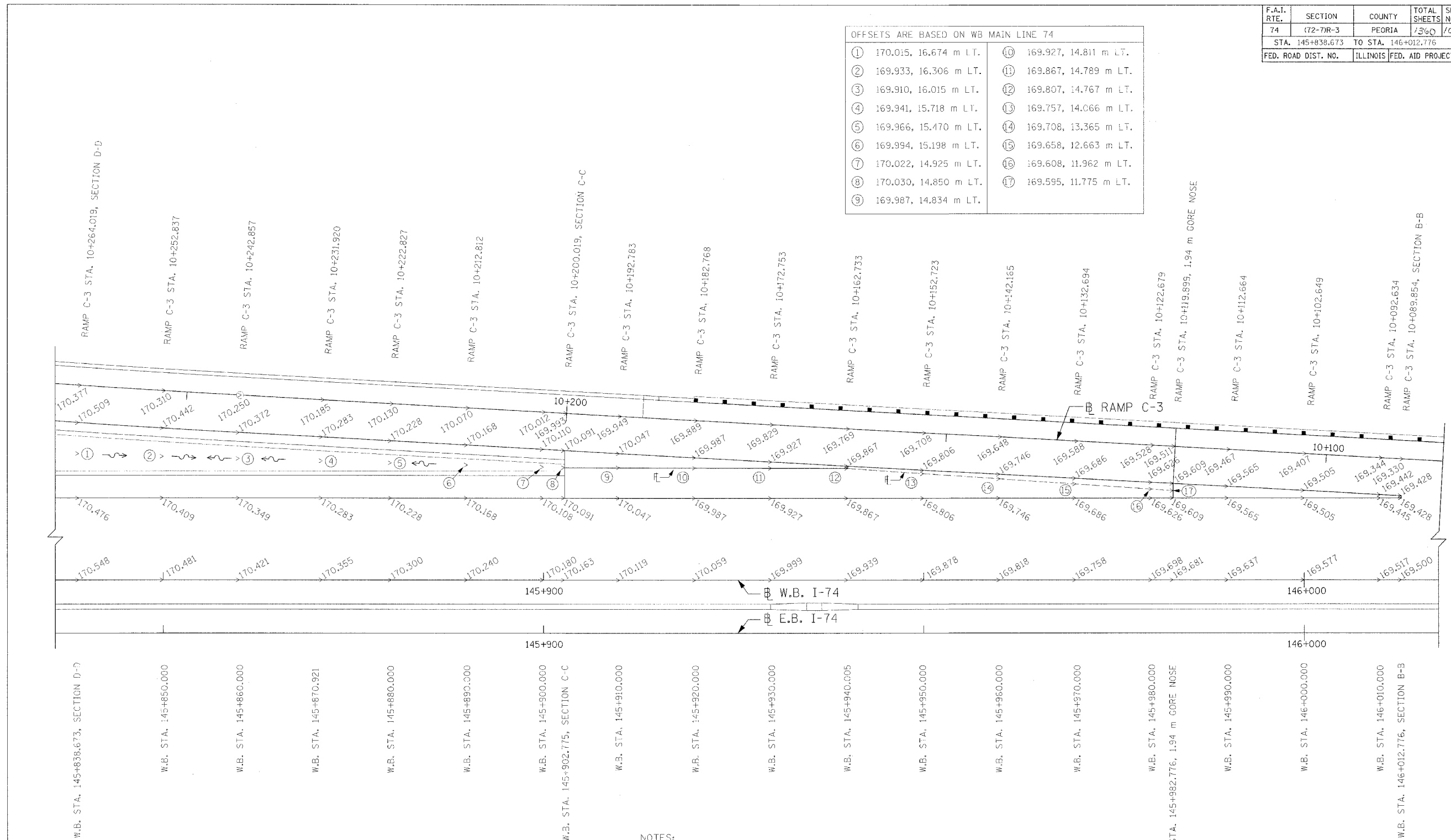

NOTES:

- SPOT ELEVATIONS ON MAINLINE SECTION ARE PERPENDICULAR TO MAINLINE. SPOT ELEVATIONS ON RAMP ARE PERPENDICULAR TO RAMP.
- SEE SUPERELEVATION TRANSITION DETAIL AND DATA SHEETS FOR ADDITIONAL INFORMATION.
- SEE STANDARD 420306-I74 FOR SECTIONS WITH MAINLINE ON TANGENT.
- SEE DRAINAGE SHEET FOR VANE DRAIN, MANHOLE AND OUTLET DETAILS FOR GORE DRAINAGE BETWEEN WB STA. 145+902.775 TO STA. 145+982.776.
- SEE DRAINAGE SHEET FOR INLET AT RAMP C-3 STA. 10+250.000, 8.456 m LT.

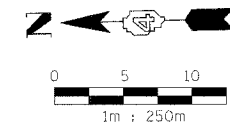

REVISIONS	
NAME	DATE

ILLINOIS DEPARTMENT OF TRANSPORTATION  
 RAMP C-3 GORE ELEVATION DETAIL  
 FAI ROUTE 74 (I-74)  
 STA. 145+838.673 - STA. 146+012.776  
 DATE 11/23/04  
 DRAWN BY IBT  
 CHECKED BY RBY