

F.A.I. RTE.	SECTION	COUNTY	TOTAL SHEETS	SHEET NO.
74	172-718-3	EEQB18	1340	1352
STA.		TO STA.		
FED. ROAD DIST. NO. 4		ILLINOIS FED. AID PROJECT		

68200 8

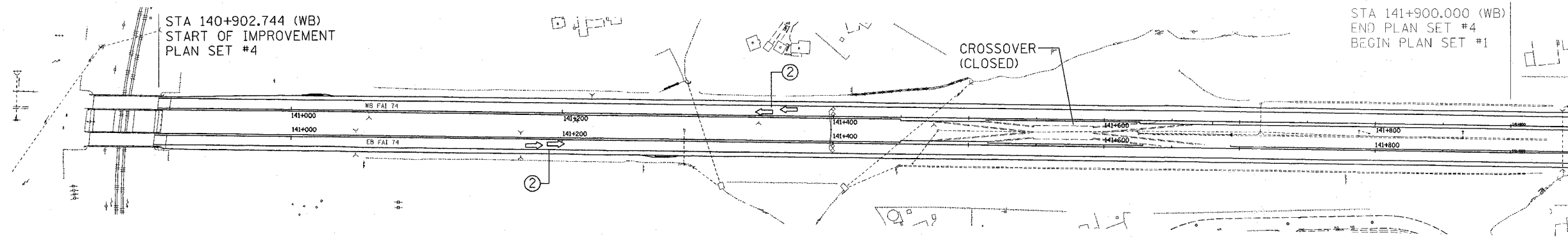

STAGE 3-4
CONSTRUCTION

1. BITUMINOUS SURFACE REMOVAL OF EB, WB MAINLINE ROADWAY, PAVEMENT PATCHING, BITUMINOUS OVERLAY OF MAINLINE PAVEMENT AND SHOULDERS, AGGREGATE SHOULDERS TY B, RAISED REFLECTIVE PAVEMENT MARKERS, POLYUREA PAVEMENT MARKING, GUARDRAIL ADJUSTMENT.

STAGE 3-4
MAINTENANCE OF TRAFFIC

ALL LANES ON EB WB I-74 ARE OPEN TO TRAFFIC ALONG THIS SECTION. INTERMITTENT LANE AND SHOULDER CLOSINGS ARE REQUIRED TO COMPLETE THE CONSTRUCTION. SEE WORKING RESTRICTIONS SPECIAL PROVISION FOR LANE AND SHOULDER CLOSING RESTRICTIONS.

1. MAINTENANCE OF TRAFFIC FOR CONSTRUCTION ACTIVITIES SHALL BE IN ACCORDANCE WITH THE APPLICABLE IDOT HIGHWAY STANDARDS 701101, 701400, 701401, 701406, 701426, AND 702001. ALL TRAFFIC CONTROL ITEMS WILL BE PAID FOR AS TRAFFIC CONTROL AND PROTECTION (EXPRESSWAYS). SEE SPECIAL PROVISION.
2. FOR TEMPORARY INFORMATIONAL SIGNING DURING CONSTRUCTION SEE THE CONCEPTUAL TEMPORARY SIGNING PLAN FOR STAGE 3-4 IN PLAN SET #1

REVISIONS		ILLINOIS DEPARTMENT OF TRANSPORTATION MAINTENANCE OF TRAFFIC FAI ROUTE 74 SCHEMATIC STAGE 3-4
NAME	DATE	
		DRAWN BY CEM CHECKED BY CEM DATE 08/03/04