

F.A.I. RTE.	SECTION	COUNTY	TOTAL SHEETS	SHEET NO.
74	(90-11)R-2; 90(13,14,14-1)R-1	TAZEWELL	1366	152
STA. 153+300		TO STA. 153+600		
FED. ROAD DIST. NO. 4		ILLINOIS FED. AID PROJECT		

NOTES: BEFORE SHIFTING WESTBOUND I-74 TRAFFIC TO THE EASTBOUND LANES, TEMPORARY CONCRETE BARRIER LOCATED IN THE MEDIAN FROM THE PREVIOUS CONTRACT MUST BE RELOCATED.

MAINLINE TRAFFIC CONTROL FOR I-74 SHALL BE IN ACCORDANCE WITH STANDARD 701101 AND 701406.

SEE TEMPORARY TRAFFIC CONTROL SCHEDULE TO VERIFY LOCATION OF TEMPORARY CONCRETE BARRIERS. BARRIER WALL REFLECTORS SHALL BE INSTALLED ON ALL TEMPORARY CONCRETE BARRIER IN ACCORDANCE WITH THE SPECIAL PROVISION FOR THESE BARRIERS

SEE MOT GENERAL NOTES SHEET FOR TEMPORARY SIGNING LEGEND.

THIS MAINTENANCE OF TRAFFIC PLAN SHOWS SPECIAL TRAFFIC CONTROL IN THIS AREA. IN ADDITION TO THE SPECIAL TRAFFIC CONTROL DETAILS SHOWN, IDOT TRAFFIC CONTROL HIGHWAY STANDARDS SHALL APPLY WHERE APPLICABLE AND AS DIRECTED BY THE ENGINEER. SEE TRAFFIC NOTES ON THE CONSTRUCTION SEQUENCING SHEET FOR STAGE 3A FOR APPLICABLE IDOT HIGHWAY STANDARDS.

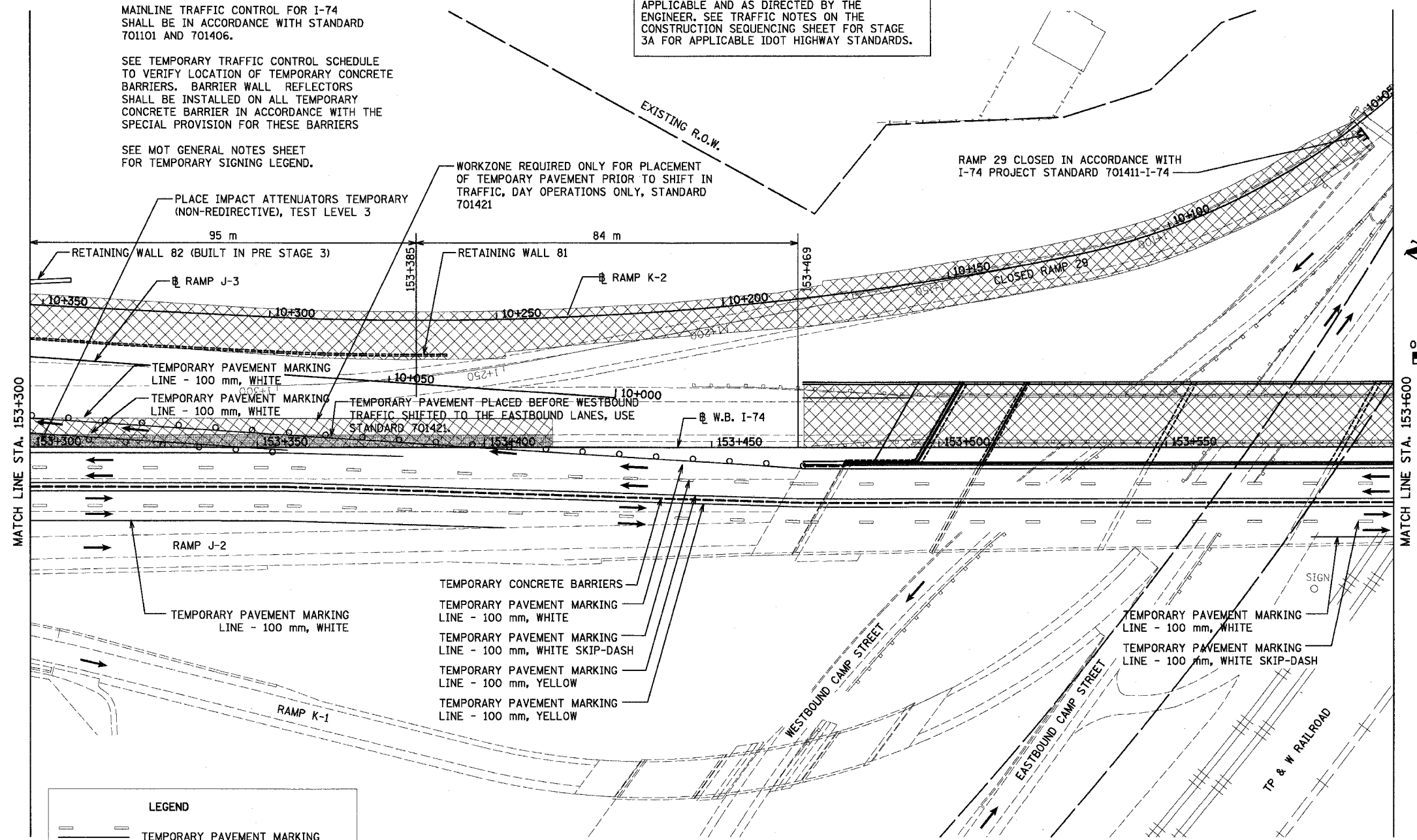

LEGEND	
	TEMPORARY PAVEMENT MARKING
	WORK ZONE
	TEMPORARY PAVEMENT
	TRAFFIC FLOW DIRECTION
	TYPE III BARRICADES
	DRUM WITH STEADY BURNING MONO-DIRECTIONAL LIGHT
	TEMPORARY CONCRETE BARRIER

REVISIONS		ILLINOIS DEPARTMENT OF TRANSPORTATION F.A.I. ROUTE 74 (I-74) MAINTENANCE OF TRAFFIC STAGE 3A STA. 153+300 TO STA. 153+600 I-74
NAME	DATE	
		DRAWN BY KMO CHECKED BY RTG DATE 12/20/2004

