

F.A.I. RTE.	SECTION	COUNTY	TOTAL SHEETS	SHEET NO.
74	(90-11)R-2; 90(13,14,14-1)R-1	TAZEWELL	1366	197
STA. 3+200		TO STA. 3+800		
FED. ROAD DIST. NO. 4		ILLINOIS FED. AID PROJECT		

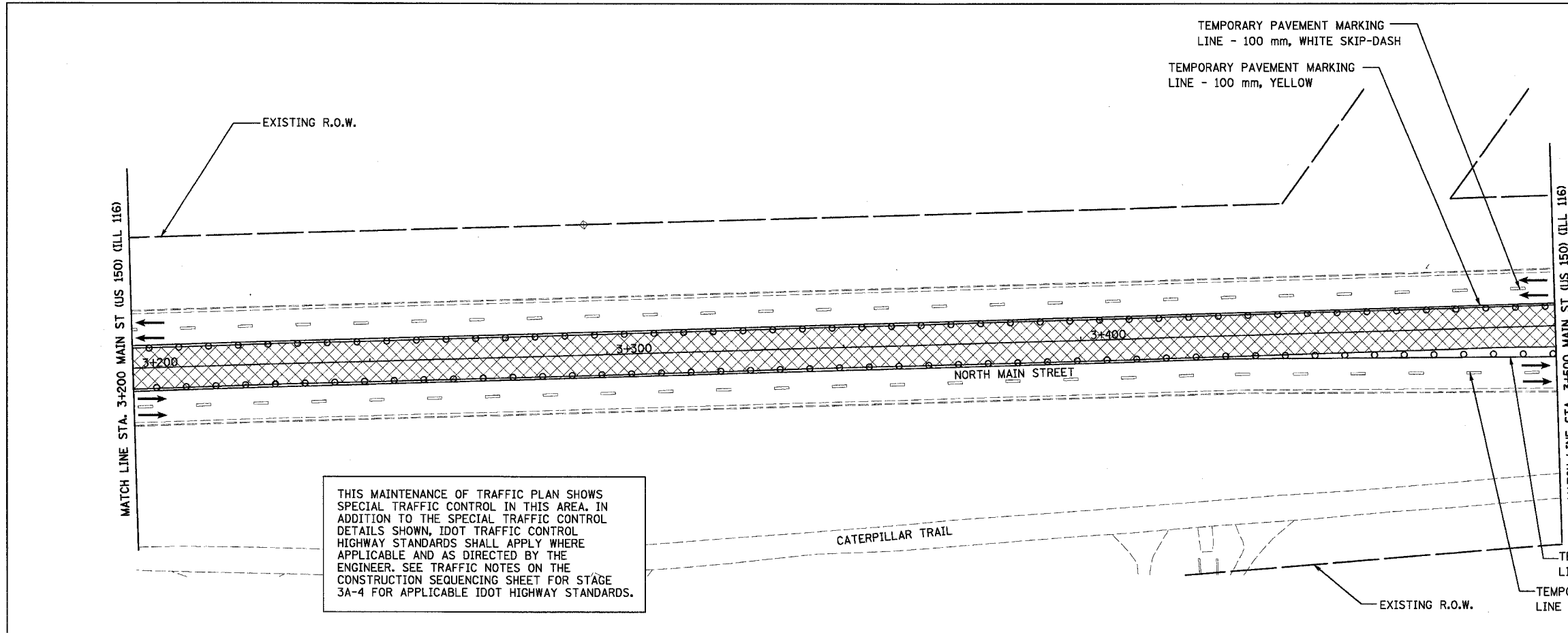

THIS MAINTENANCE OF TRAFFIC PLAN SHOWS SPECIAL TRAFFIC CONTROL IN THIS AREA. IN ADDITION TO THE SPECIAL TRAFFIC CONTROL DETAILS SHOWN, IDOT TRAFFIC CONTROL HIGHWAY STANDARDS SHALL APPLY WHERE APPLICABLE AND AS DIRECTED BY THE ENGINEER. SEE TRAFFIC NOTES ON THE CONSTRUCTION SEQUENCING SHEET FOR STAGE 3A-4 FOR APPLICABLE IDOT HIGHWAY STANDARDS.

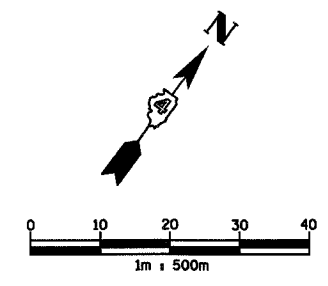
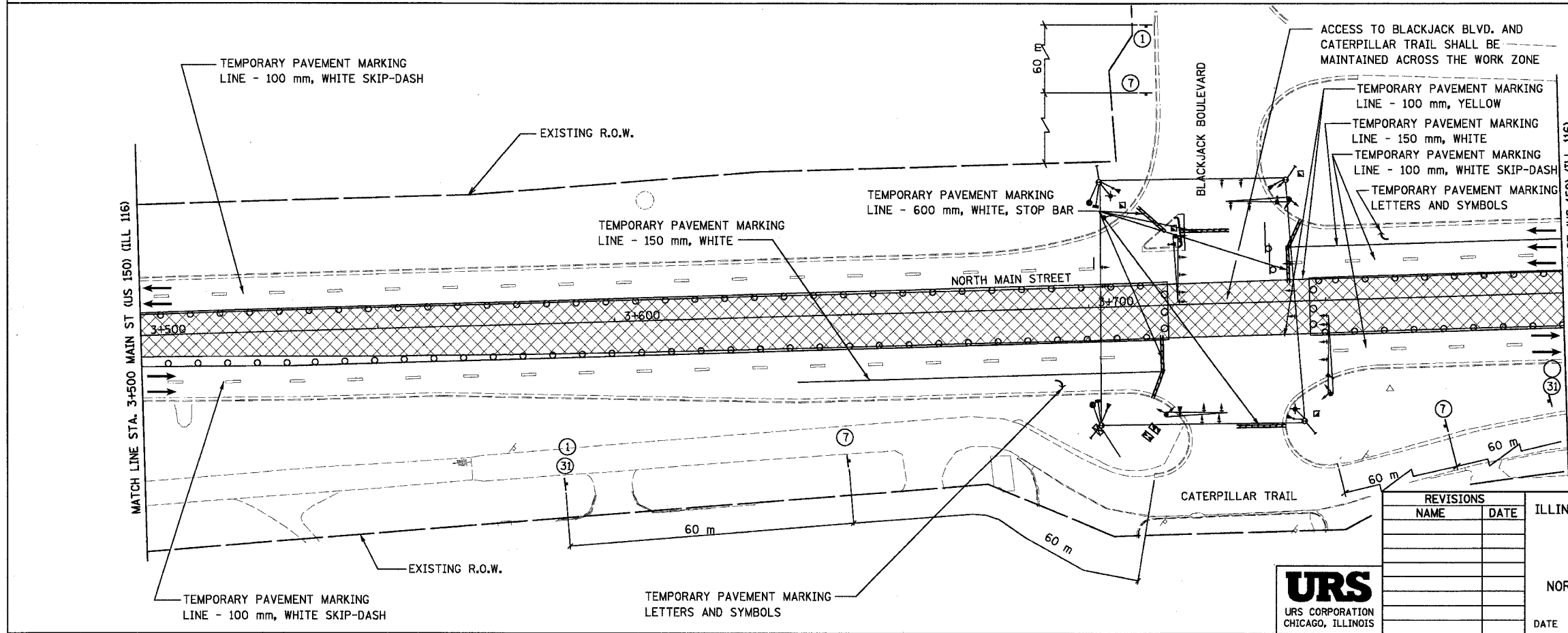

LEGEND

- TEMPORARY PAVEMENT MARKING
- WORK ZONE
- TRAFFIC FLOW DIRECTION
- SIGN, SEE GENERAL NOTES AND LEGEND SHEET FOR SIGN TYPE
- DRUM WITH STEADY BURNING MONO-DIRECTIONAL LIGHT

REVISIONS	
NAME	DATE

ILLINOIS DEPARTMENT OF TRANSPORTATION
 F.A.I. ROUTE 74 (I-74)
 MAINTENANCE OF TRAFFIC
 STAGE 3A-4
 NORTH MAIN STREET 3+200 TO 3+800
 DRAWN BY KMO
 CHECKED BY RTG
 DATE 12/20/2004

