

F.A.I. RTE.	SECTION	COUNTY	TOTAL SHEETS	SHEET NO.
74	90-11R-2; 90(13,14,14-1)R-1	TAZEWELL	1366	199
STA. 152+445.837 TO STA. 153+892.180		FED. ROAD DIST. NO. 4 ILLINOIS FED. AID PROJECT		

STAGE 3A-5 CONSTRUCTION:

- ① CONTINUE WORK ON WESTBOUND I-74
- ② SURFACE NORTH MAIN STREET FROM STATION 2+800.000 TO STATION 4+157.000.
- ③ PLACE ALL PERMANENT PAVEMENT MARKINGS AND REMOVE ALL CONSTRUCTION SIGNS, AS DIRECTED BY THE ENGINEER. TEMPORARY INFORMATION SIGNING MUST REMAIN UNTIL THE I-74 RECONSTRUCTED WESTBOUND LANES ARE REOPENED.

TRAFFIC:

1. THE EAST AND WEST BOUND LANES OF I-74 ARE OPEN AT ALL TIMES.
2. RAMP 21 FROM WEST BOUND I-74 TO NORTH MAIN STREET MUST REMAIN OPEN AT ALL TIMES. USE I-74 PROJECT STANDARD 701101-I74.
3. MAINTAIN TWO LANES OF TRAFFIC IN EACH DIRECTION ON I-74 DURING PEAK HOURS AND AT LEAST ONE LANE OF TRAFFIC IN EACH DIRECTION DURING OFF PEAK HOURS. LANE CLOSURES SHALL BE IN ACCORDANCE WITH STANDARD 701406.
4. MAINTAIN TWO LANES OF TRAFFIC IN EACH DIRECTION ON NORTH MAIN STREET DURING PEAK HOURS AND AT LEAST ONE LANE OF TRAFFIC IN EACH DIRECTION DURING OFF PEAK HOURS. LANE CLOSURES SHALL BE IN ACCORDANCE WITH STANDARD 701602.

RAILROAD:

- RI. RAILROAD TRAFFIC WILL BE MAINTAINED AT ALL TIMES AND RAILROAD FLAGGERS WILL BE ONSITE ANYTIME WORK WITHIN 25 FEET OF CENTERLINE OR OVER THE TRACKS.

GENERAL NOTES:

STAGE 3A REFERS TO MAINLINE CONSTRUCTION AND SUB-STAGE 5 REFERS TO CONSTRUCTION ON THE OFF SYSTEM ROADWAYS

SEE SIGNING PLAN FOR STAGED REMOVAL OF EXISTING SIGNS AND STAGED PLACEMENT OF PROPOSED INFORMATION AND GUIDE SIGNS.

THE STAGED CONSTRUCTION SHOWN HERE IS A GENERAL SEQUENCING SUGGESTION.

SEE PLAN SET 2 OF 4 FOR MAINTENANCE OF TRAFFIC FOR WASHINGTON STREET, RAMP L-3, AND L-4.

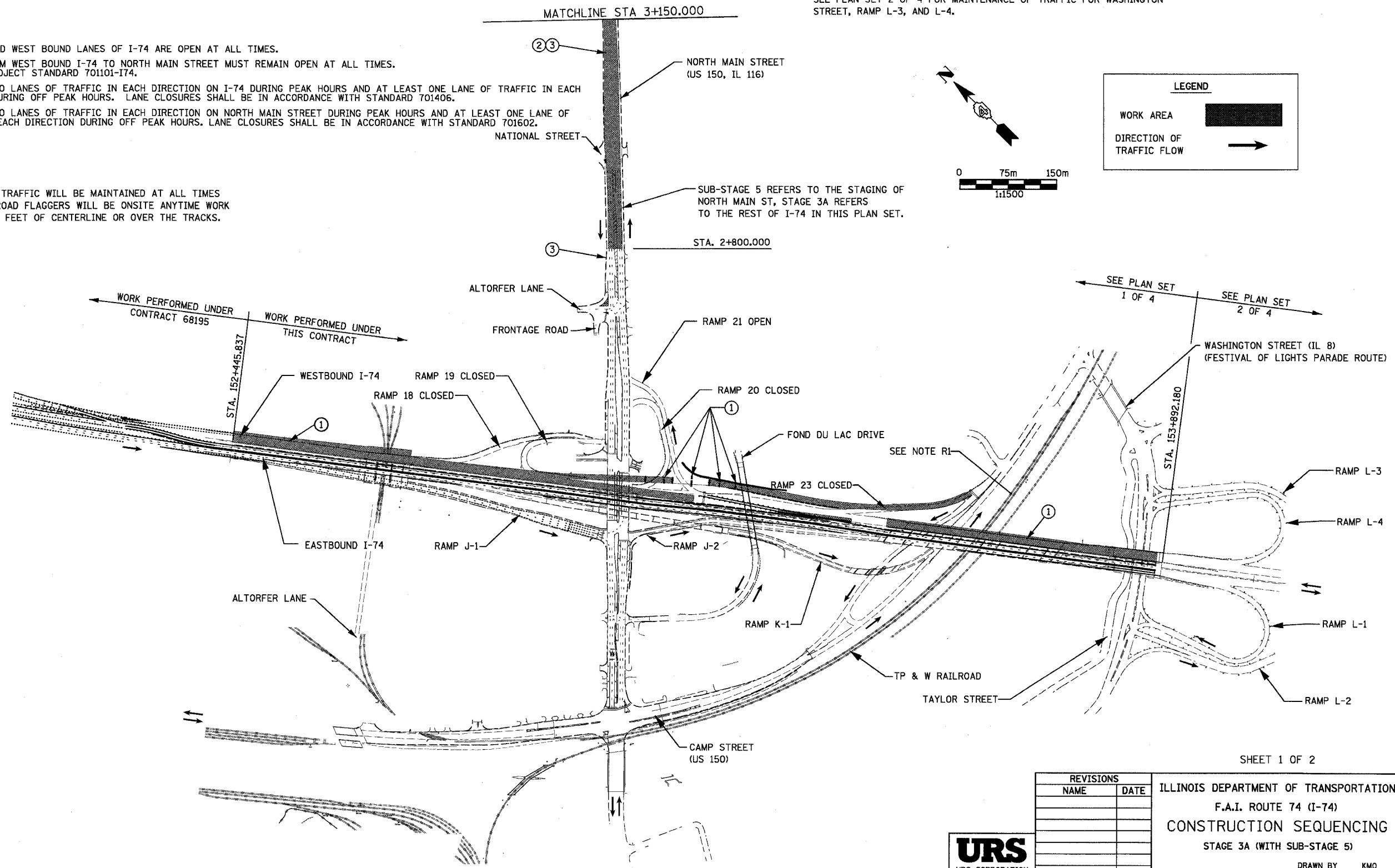

REVISIONS	
NAME	DATE

ILLINOIS DEPARTMENT OF TRANSPORTATION
 F.A.I. ROUTE 74 (I-74)
 CONSTRUCTION SEQUENCING
 STAGE 3A (WITH SUB-STAGE 5)
 DRAWN BY KMO
 CHECKED BY RTG
 DATE 12/20/2004

