

**STAGE 3A-5
CONSTRUCTION:**

- ② SURFACE NORTH MAIN STREET FROM STATION 2+800.000 TO STATION 4+157.000.
- ③ PLACE ALL PERMANENT PAVEMENT MARKINGS AND REMOVE ALL CONSTRUCTION SIGNS, AS DIRECTED BY THE ENGINEER.

TRAFFIC:

MAINTAIN TWO LANES OF TRAFFIC IN EACH DIRECTION ON NORTH MAIN STREET DURING PEAK HOURS AND AT LEAST ONE LANE OF TRAFFIC IN EACH DIRECTION DURING OFF PEAK HOURS. LANE CLOSURES SHALL BE IN ACCORDANCE WITH STANDARD 701602.

GENERAL NOTES:

STAGE 3A REFERS TO MAINLINE CONSTRUCTION AND SUB-STAGE 5 REFERS TO CONSTRUCTION ON THE OFF SYSTEM ROADWAYS

SEE SIGNING PLAN FOR STAGED REMOVAL OF EXISTING SIGNS AND STAGED PLACEMENT OF PROPOSED INFORMATION AND GUIDE SIGNS.

THE STAGED CONSTRUCTION SHOWN HERE IS A GENERAL SEQUENCING SUGGESTION.

F.A.I. RTE.	SECTION	COUNTY	TOTAL SHEETS	SHEET NO.
74	(90-11)R-2; 90(13,14,14-1)R-1	TAZEWELL	1366	200
STA. 152+445.837 TO STA. 153+892.180			FED. ROAD DIST. NO. 4 ILLINOIS FED. AID PROJECT	

LEGEND

WORK AREA 

DIRECTION OF TRAFFIC FLOW 

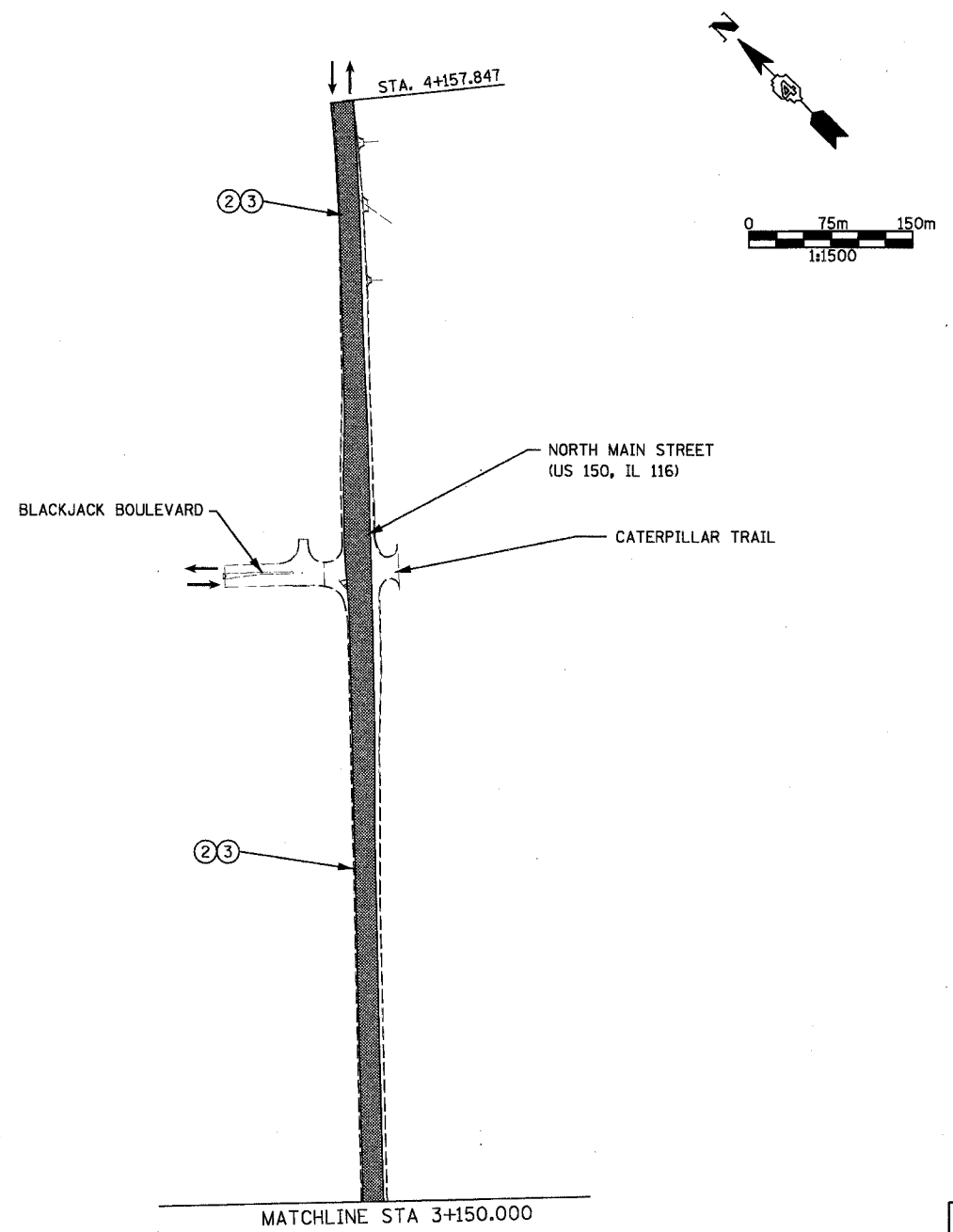

SHEET 2 OF 2

REVISIONS	
NAME	DATE

ILLINOIS DEPARTMENT OF TRANSPORTATION
 F.A.I. ROUTE 74 (I-74)
CONSTRUCTION SEQUENCING
 STAGE 3A (WITH SUB-STAGE 5)

DATE 12/20/2004

DRAWN BY KMO
 CHECKED BY RTG

