

F.A.I. RTE.	SECTION	COUNTY	TOTAL SHEETS	SHEET NO.
74	*	TAZEWELL	1366	226
STA. 2+750.000 TO STA. 2+900.000				
FED. ROAD DIST. NO.			ILLINOIS FED. AID PROJECT	

\*190-DR-2,901(3,4,14-DR-1

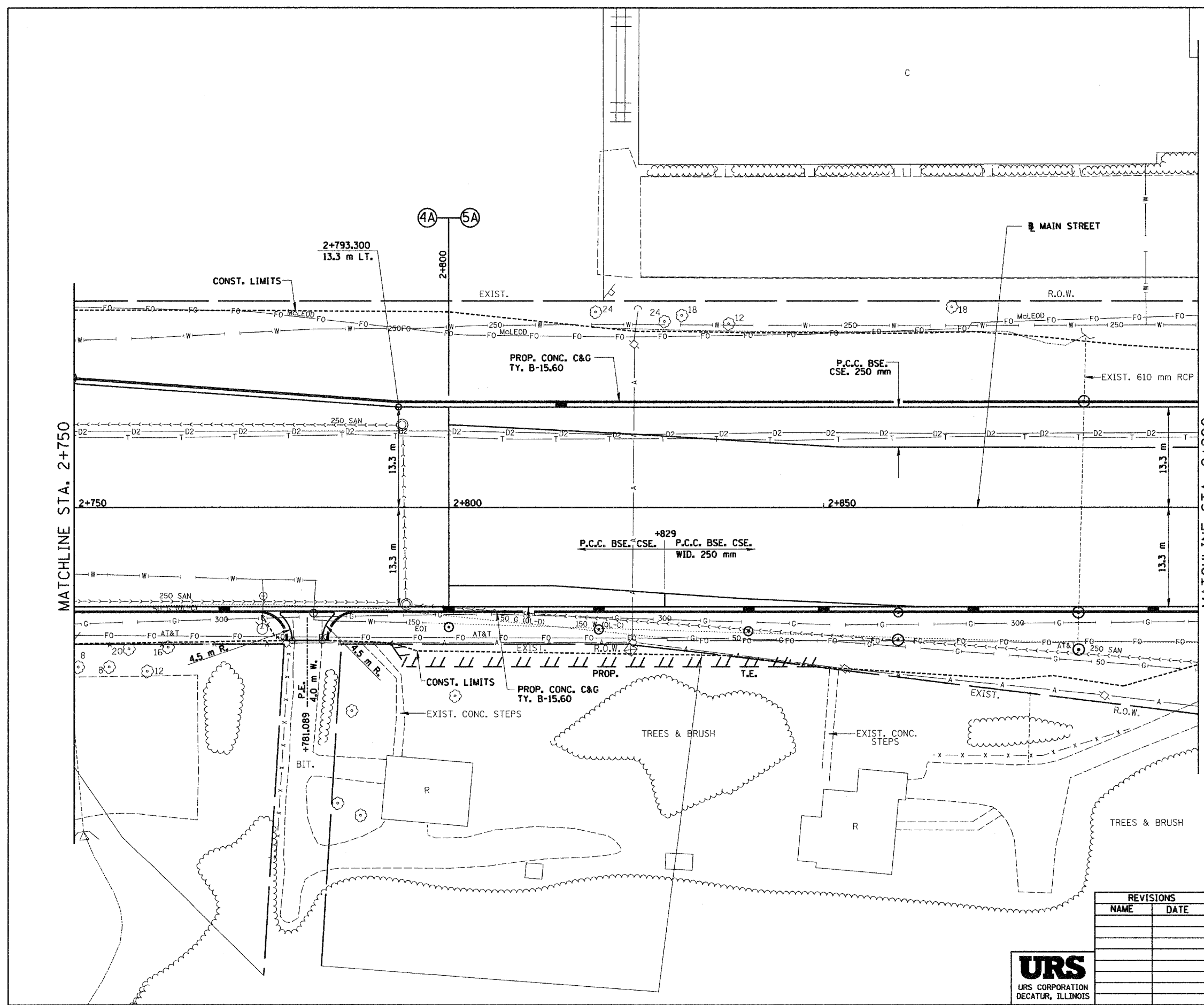
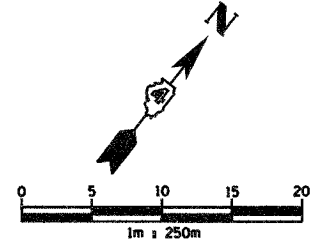

MATCHLINE STA. 2+750

MATCHLINE STA. 2+900

REVISIONS	
NAME	DATE



ILLINOIS DEPARTMENT OF TRANSPORTATION  
 PROPOSED ROADWAY PLAN  
 ILL. 116 - U.S. 150 - MAIN ST.  
 STA. 2+750 TO STA. 2+900  
 DRAWN BY SRS  
 CHECKED BY JJM  
 DATE 12-20-04

11/21/04 11:11:11 AM C:\pwork\116\116.dwg