

F.A.I. RTE.	SECTION	COUNTY	TOTAL SHEETS	SHEET NO.
74	*	TAZEWELL	1366	236
STA. 3+500.000 TO STA. 3+650.000				
FED. ROAD DIST. NO.		ILLINOIS FED. AID PROJECT		

\* (90-IDR-2) 9003J4, J4-DR-1

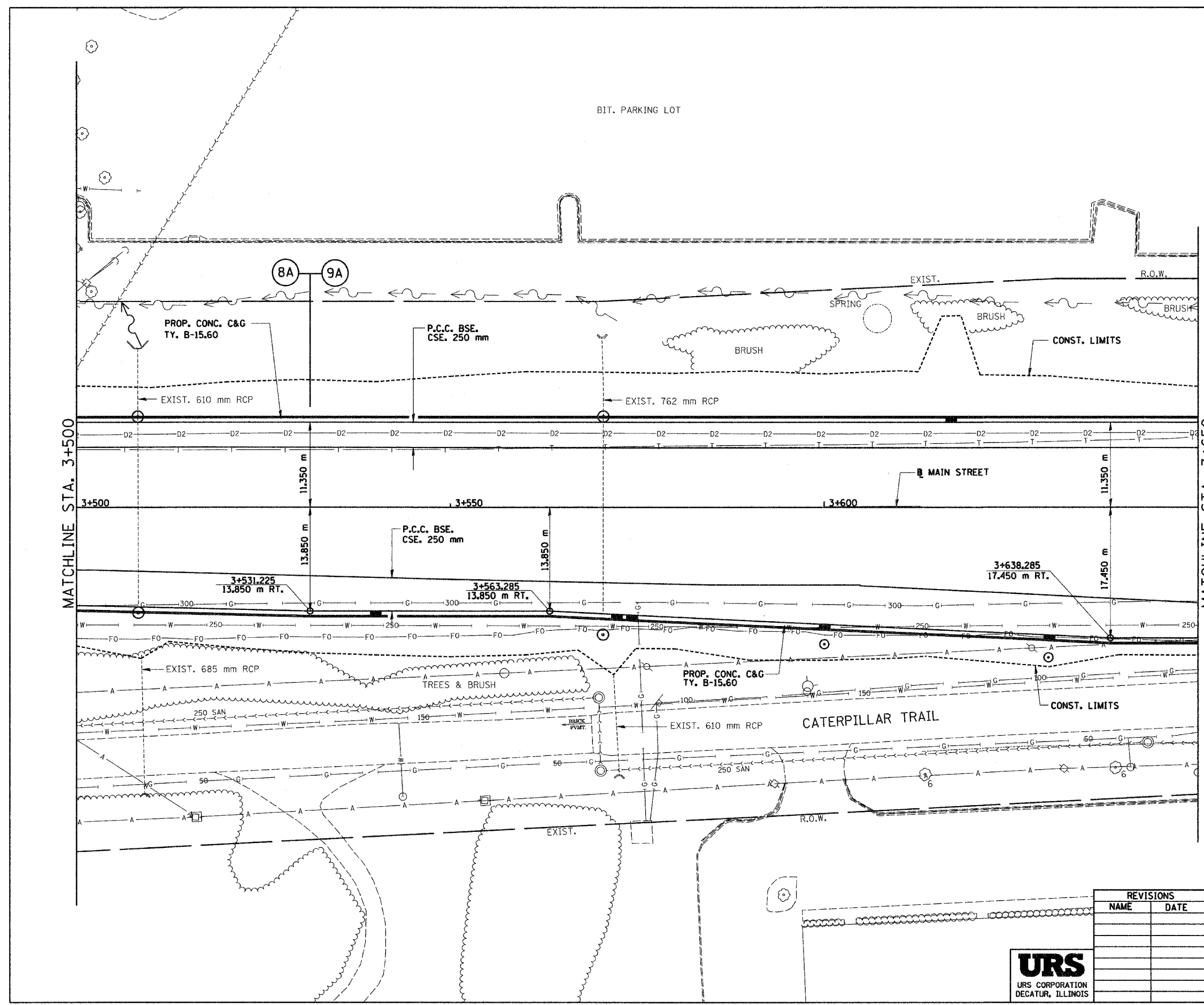
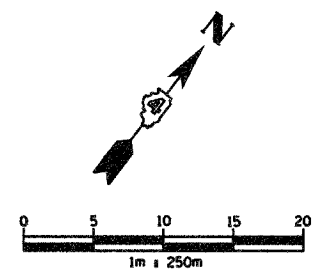

MATCHLINE STA. 3+500

MATCHLINE STA. 3+650

REVISIONS	
NAME	DATE



ILLINOIS DEPARTMENT OF TRANSPORTATION  
 PROPOSED ROADWAY PLAN  
 ILL. 116 - U.S. 150 - MAIN ST.  
 STA. 3+500 TO STA. 3+650  
 DRAWN BY SRS  
 CHECKED BY JJM  
 DATE 12-20-04

...:\pbase2\roadway\116-150-500-650.dwg 12/17/2004 9:38:23 AM