

STATE OF ILLINOIS  
DEPARTMENT OF TRANSPORTATION

|                       |          |                  |              |           |
|-----------------------|----------|------------------|--------------|-----------|
| ROUTE NO.             | SECTION  | COUNTY           | TOTAL SHEETS | SHEET NO. |
| S. B. I.              | *        | TAZEWELL         | 1366         | 427       |
| F.A. I-74             |          |                  |              |           |
| FED. ROAD DIST. NO. 7 | ILLINOIS | FED. AID PROJECT |              |           |

SHEET NO. 5  
25 SHEETS

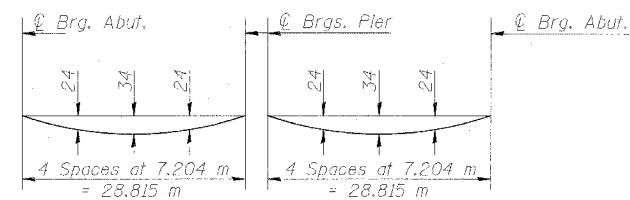

**DEAD LOAD DEFLECTION DIAGRAM**

(Includes weight of concrete, excluding beams).

Note: The above deflections are not to be used in the field if the engineer is working from the grade elevations adjusted for dead load deflections as shown below.

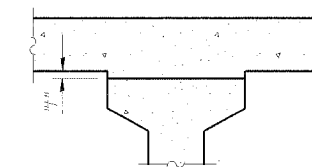

To determine "t": After all precast prestressed beams have been erected, elevations of the top flanges of the beams shall be taken at intervals shown below. These elevations subtracted from the "Theoretical Grade Elevations Adjusted for Dead Load Deflections" minus slab thickness, equals the fillet heights "t" above top flanges of beams.

**FILLET HEIGHTS**

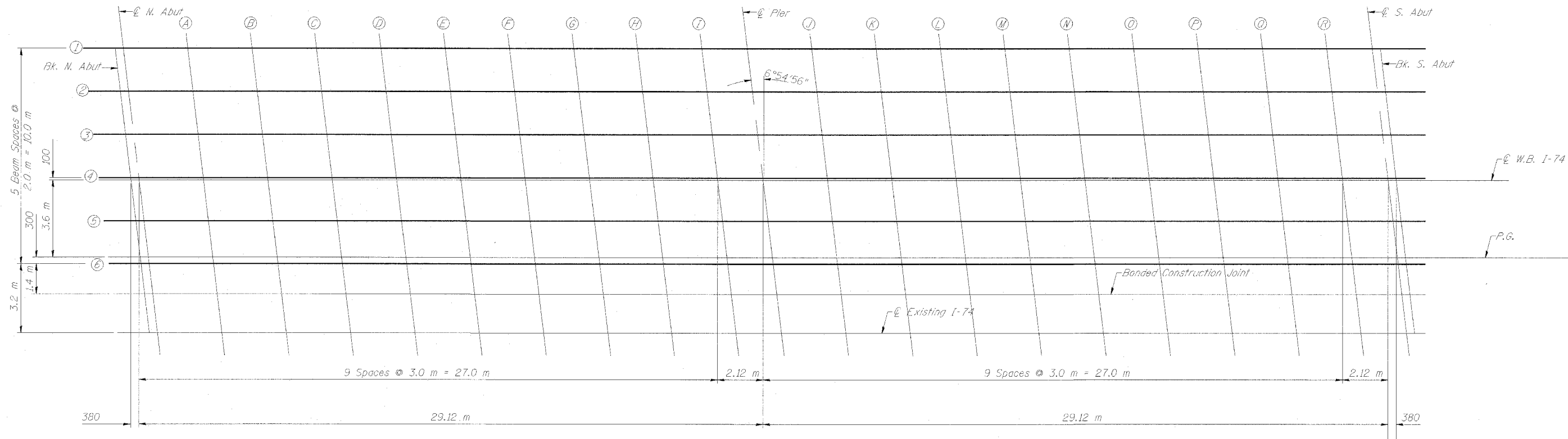

**PLAN**

|          |     |
|----------|-----|
| DESIGNED | KEF |
| CHECKED  | MJS |
| DRAWN    | DEM |
| CHECKED  | KEF |

TOP OF SLAB ELEVATIONS  
WB INTERSTATE 74 OVER  
MAIN STREET (IL RTE. 116)  
F.A.I. ROUTE 74-SEC. (90-11 HB)BR  
TAZEWELL COUNTY  
STATION 153+050.716  
STRUCTURE NO. 090-0160

