

STATE OF ILLINOIS  
DEPARTMENT OF TRANSPORTATION

ROUTE NO.	SECTION	COUNTY	TOTAL SHEETS	SHEET NO.
F.A.I. 74	90-13HVB	TAZEWELL	1366	453
FED. ROAD DIST. NO. 7	ILLINOIS	FED. AID PROJECT		

SHEET NO. 5  
68 SHEETS

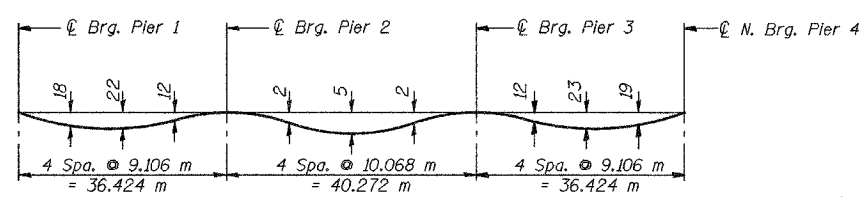

**SPANS 2, 3 & 4**

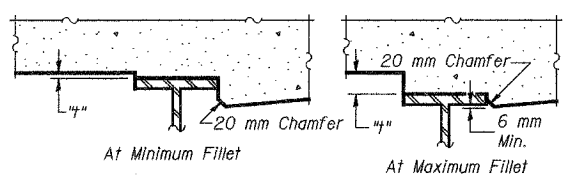

To determine "f": After all structural steel has been erected, elevations of the top flanges of the beams shall be taken at intervals shown below. These elevations subtracted from the "Theoretical Grade Elevations Adjusted for Dead Load Deflection" shown below, minus slab thickness, equals the fillet heights "f" above top flange of beams.

**FILLET HEIGHTS**

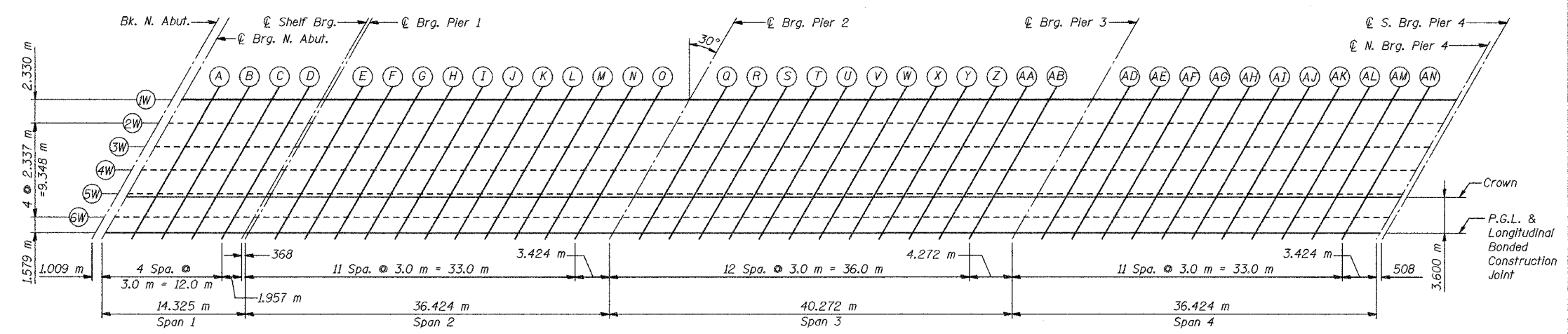

**PLAN-SPANS 1, 2, 3 & 4**

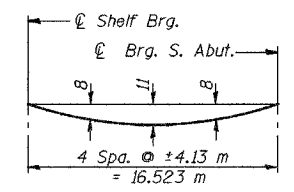

**SPAN 8**

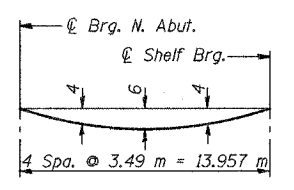

**SPAN 1**

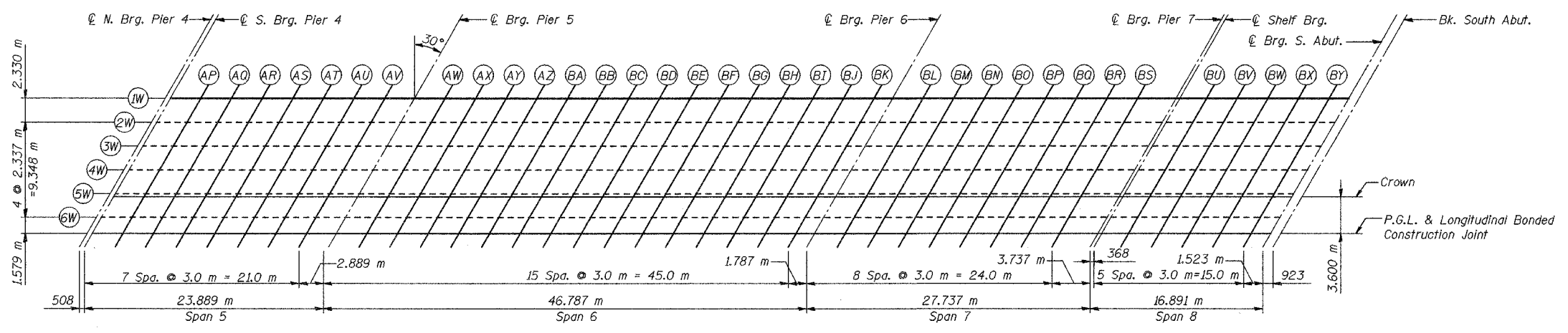

**PLAN-SPANS 5, 6, 7 & 8**

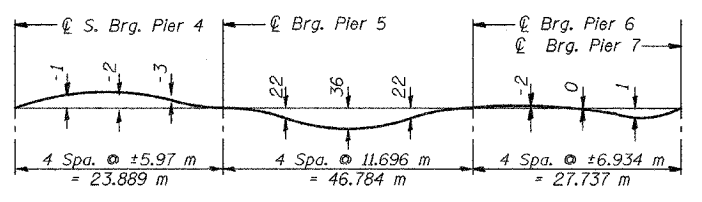

**SPANS 5, 6 & 7**

**DEAD LOAD DEFLECTION DIAGRAMS**

(Includes weight of concrete only)

- Notes:
- The above deflections are not to be used in the field if the Engineer is working from the grade elevations adjusted for dead load deflections as shown on sheets 6 thru 9.
  - All dimensions are in millimeters (mm) except as noted.

- Notes:
- The Shelf bearings are located on the cantilevered extension of girders beyond bearings at Pier 1 and Pier 7.

PLAN-TOP OF SLAB ELEVATIONS			
Date	Designed AEU	WESTBOUND F.A.I. ROUTE 74 OVER CAMP STREET, FARM CREEK, AND TP&W RR F.A.I. RTE. 74 SECTION (90-13HVB)BY TAZEWELL COUNTY STATION 153+625.193 STRUCTURE NO. 090-0009	Sheet No.
Revisions	Drawn AEU		5
	Checked NPP		of 68
	Approved NPP		
Prepared By:	BRW, Inc. A Division of URS	1701 Golf Rd., Suite 1000 Rolling Meadows, IL.	BRW Job No. 17049-071