

STATE OF ILLINOIS
DEPARTMENT OF TRANSPORTATION

ROUTE NO.	SECTION	COUNTY	TOTAL SHEETS	SHEET NO.
F.A.I. 74	90-13HVBY	TAZEWELL	1366	510
FED. ROAD DIST. NO. 7		ILLINOIS	FED. AID PROJECT	

SHEET NO. 62
68 SHEETS

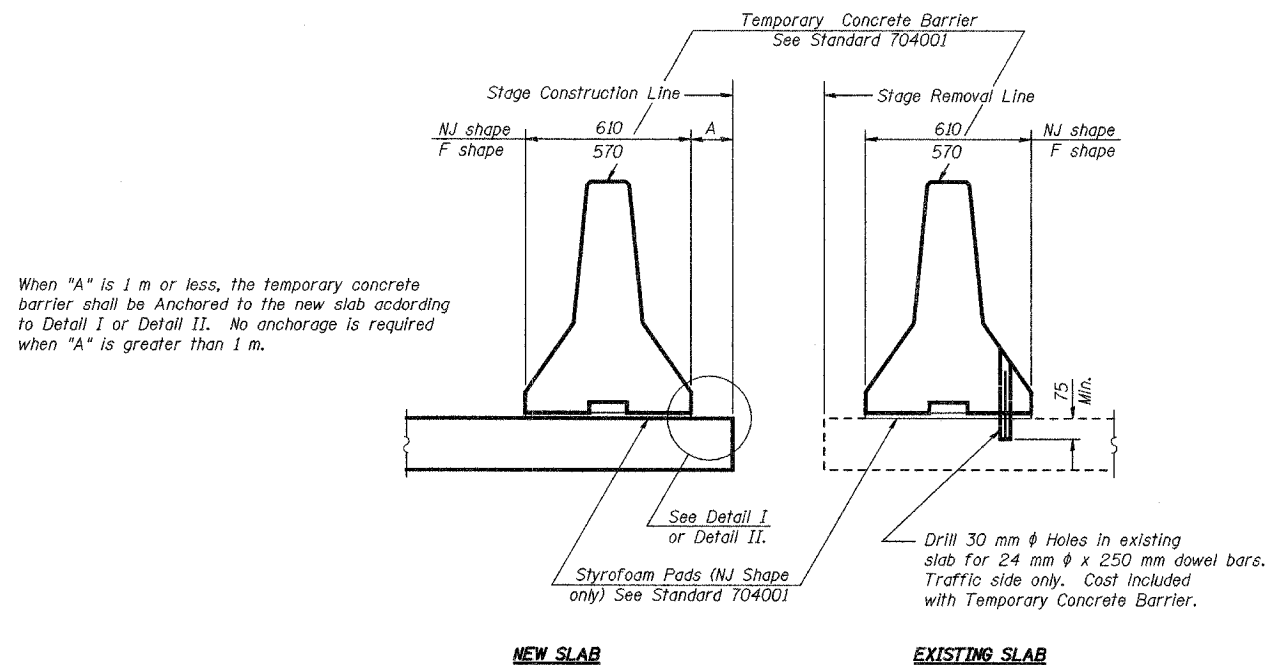

NOTES

- Detail I - With Bar Splicer or Couplers:
Connect one (1) 25x180x250 steel \bar{L} to the top layer of couplers with 2-16 mm ϕ bolts screwed to coupler at approximate \bar{C} of each 3 m barrier panel.
 - Detail II - With Extended Reinforcement Bars:
Connect one (1) 25x180x250 steel \bar{L} to the concrete slab with 2-16 mm ϕ Expansion Anchors or cast in place Inserts spaced between the top layer of reinforcement at approximate \bar{C} of each 3 m barrier panel.
- Cost of anchorage included with Temporary Concrete Barrier.
All dimensions are in millimeters (mm) except as noted.

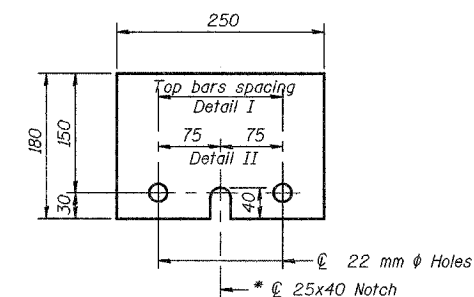
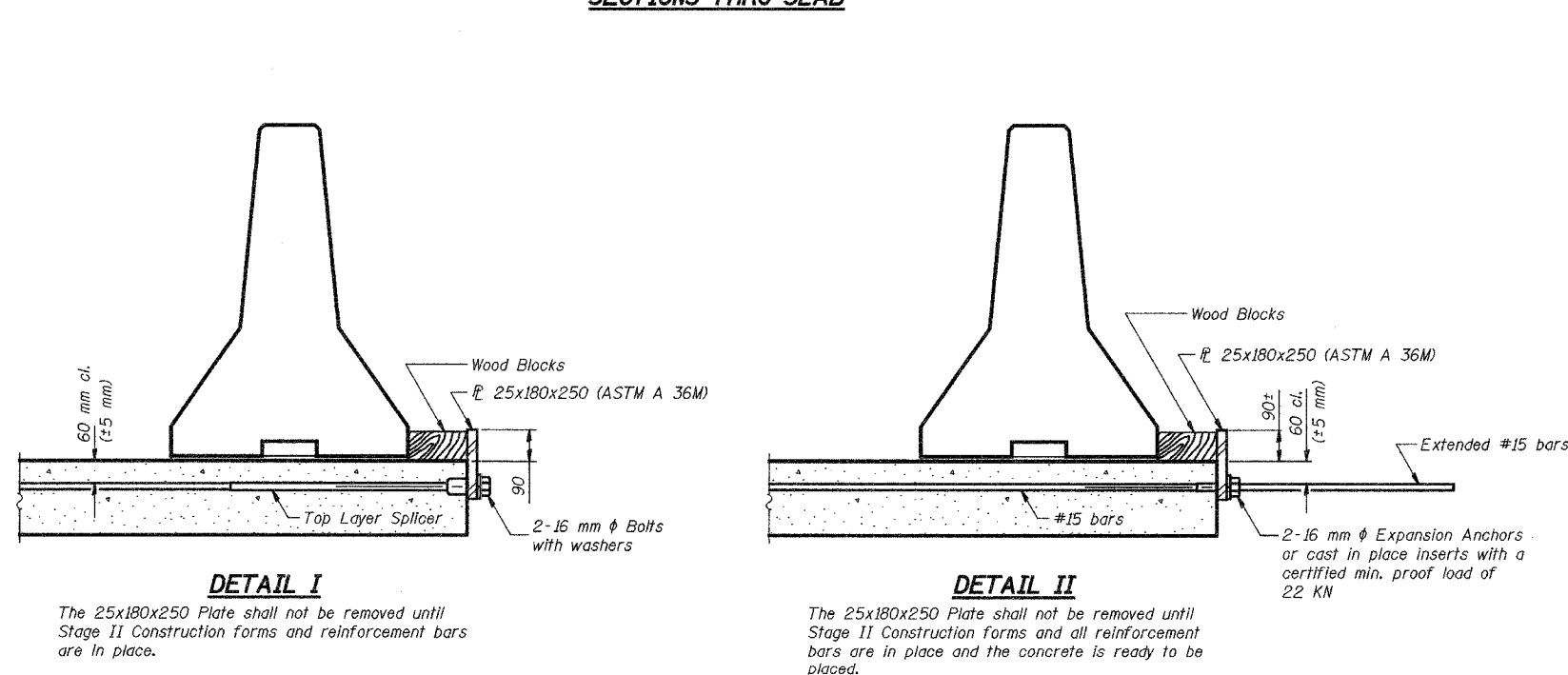

\bar{L} 25x180x250

* Required only with Detail II

R-27 10-31-02

TEMPORARY CONCRETE BARRIER			
Date	Designed EV	WESTBOUND F.A.I. ROUTE 74 OVER CAMP STREET, FARM CREEK, AND TP&W RR F.A.I. RTE. 74 SECTION (90-13HVBY)BY TAZEWELL COUNTY STATION 153+625.193 STRUCTURE NO. 090-0009	Sheet No.
Revisions	Drawn EV		62
	Checked NPP		of 68
	Approved NPP		
Prepared By: BRW, Inc. A Division of URS		1701 Golf Rd., Suite 1000 Rolling Meadows, IL.	BRW Job No. 17049-071