

STATE OF ILLINOIS
DEPARTMENT OF TRANSPORTATION

F.A.I. RTE.	SECTION	COUNTY	TOTAL SHEETS	SHEET NO.
I-74	*	TAZEWELL	1366	517
FED. ROAD DIST. NO. 7		ILLINOIS	FED. AID PROJECT-	

*90-11R-2,90(13,14,14-1R-1

STATE OF ILLINOIS
DEPARTMENT OF PUBLIC WORKS & BUILDINGS
DIVISION OF HIGHWAYS

DATE	BY	REVISION
	TAZEWELL	

8.14' NE CORNER S. HEADWALL: F.F. AT
STA. 240+30 ELEVATION 466.59

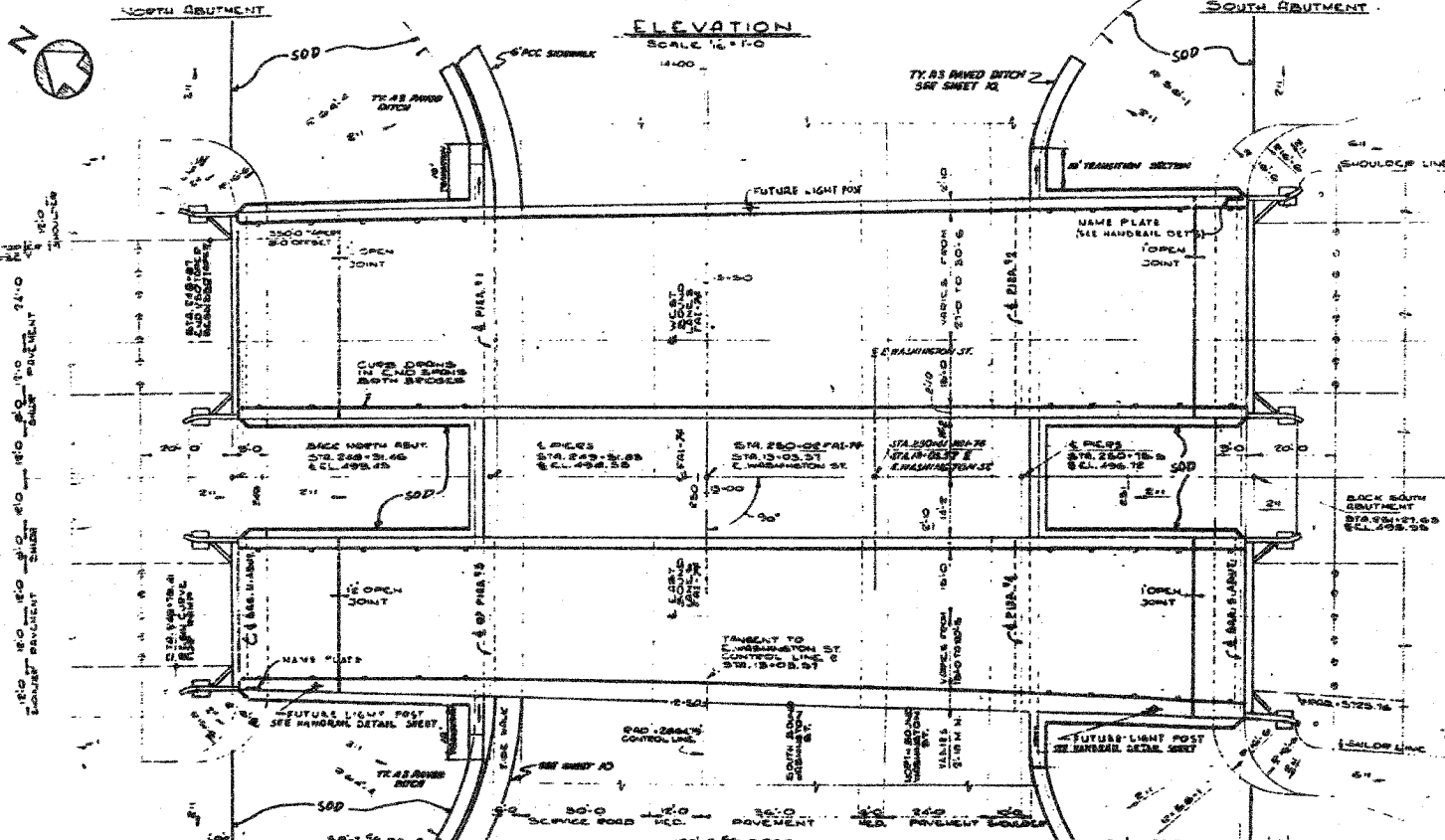
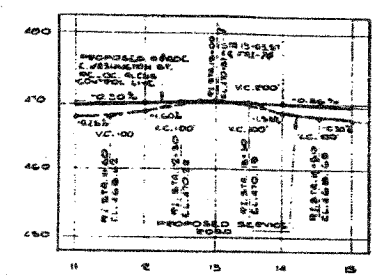
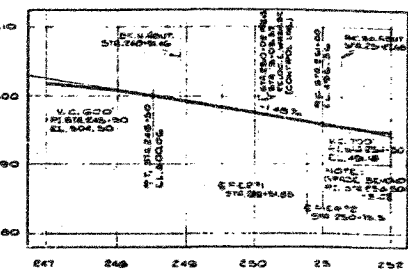
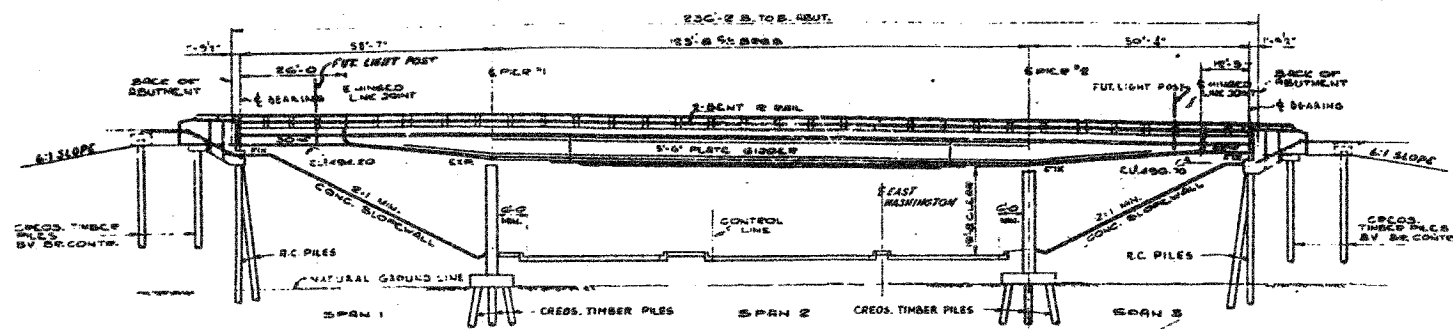

- GENERAL NOTES:**
- ALL CONCRETE SHALL BE CLASS 'C' AND FINISH TO BE SMOOTH SURFACE 2000 PSI.
 - REINFORCING BARS SHALL BE FINISHED IN ACCORDANCE WITH ARTICLE 5.1.4 OF THE STANDARD SPECIFICATIONS FOR STRUCTURAL CONSTRUCTION.
 - JOINTS SURFACE ON CROSS SECTION SHALL BE MADE MONOTONICALLY.
 - NO TOLERANCE CONSTRUCTION JOINTS SHALL BE MADE EXCEPT BY WRITTEN PERMISSION OF THE ENGINEER.
 - ALL BOLTERS, FORKERS, BEARING PLATES, LEAD PLATES, RIVETERS, WELD PLATES AND BRIDGE BARS SHALL BE FABRICATED AND SET IN ACCORDANCE WITH ART. 5.1.5 OF THE STANDARD SPECIFICATIONS.
 - COMBINATION GIRDERS ARE INCLUDED IN WEIGHT OF STRUCTURAL STEEL. SHALL RECEIVE ONE SHOP COAT OF PAINT LEAD PAINT AND TWO FIELD COATS OF ALUMINUM PAINT. SEE ARTICLES 5.1.1 TO 5.1.6 INCLUDING THE STANDARD SPECIFICATIONS.
 - ALL PAINT SHALL BE FURNISHED AND APPLIED BY THE CONTRACTOR IN ACCORDANCE WITH THE STANDARD SPECIFICATIONS.
 - THE ROADWAY EXPANSION JOINTS SHALL BE FABRICATED AND CEMENTED IN ACCORDANCE WITH ART. 5.1.11 (1) OF THE STANDARD SPECIFICATIONS AND SHALL FIT THE CROWN OF THE ROADWAY.
 - HIGH STRENGTH STEEL BOLTS MAY BE SUBSTITUTED FOR FIELD BOLTS IN ACCORDANCE WITH ART. 5.1.10 OF THE STANDARD SPECIFICATIONS BEFORE ORDERING THE REMAINDER OF PILES.
 - REINFORCING BARS SHALL BE LAPPED A MINIMUM OF 20 BAR DIA. UNLESS OTHERWISE NOTED.
 - ALL REINFORCING BARS SHALL BE FINISHED IN ACCORDANCE WITH ART. 5.1.4 OF THE STANDARD SPECIFICATIONS FOR REINFORCING BARS.
 - LIVE LOADS: HS-20-44 & MODIFIED
 - DESIGN STRESSES:
 - S - 10000 PSI - STRUCTURAL STEEL
 - S - 50000 PSI - REINFORCING STEEL
 - C - 1000 PSI - SUPERSTRUCTURE SUBSTRUCTURE
 - F - 1/2 PSI - FOOTINGS

SUMMARY OF QUANTITIES

ITEM	UNIT	QUANTITY
CLASS A EXCAVATION FOR STRUCTURES	CU. YDS.	570
CLASS B CONCRETE	CU. YDS.	798.8
ERECTING STRUCTURAL STEEL	LBS.	1054220
FURNISHING AND SETTING METAL HANDRAIL	LINE FT.	1,001
APPROXIMATE BARS	LBS.	153650
FURNISHING CHROSIOTED PILES (20" x 36")	LINE FT.	2,340
FURNISHING CHROSIOTED PILES OVER 36"	LINE FT.	1,700
DRIVING TIMBER PILES	LINE FT.	3,000
FURNISHING CONCRETE PILES	LINE FT.	1,515
DRIVING CONCRETE PILES	LINE FT.	1,515
TEST PILES (TIMBER)	PILES	1
TEST PILES (CONCRETE)	PILES	1
WALK PLATES	EACH	2
SLOPE WALL	SQ. YDS.	1,106
PAVED DITCH	LN. FT.	60

LIST OF DRAWINGS

NO.	TITLE
1	GENERAL PLAN & ELEVATION
2	SOIL BORINGS & FOUNDATION PLAN
3	STRUCTURAL STEEL FRAMING PLAN
4	STRUCTURAL STEEL DETAILS
5	BEARINGS & EXPANSION GUARD DETAILS
6	HANDRAIL DETAILS
7	BRIDGE FLOOR - WEST BOUND SLAB
8	BRIDGE FLOOR - EAST BOUND SLAB
9	PILES 18" x 18" - REINF. & DETAILS
10	PILES 24" x 24" - REINF. & DETAILS
11	ABUTMENTS - REINF. & DETAILS
12	ABUTMENTS - ELEVATIONS & DETAILS
13	MISC. CONCRETE DETAILS
14	ALTERNATE PILING DETAILS

DESIGNED: E.A. ANDREWS
CHECKED: E.A. ANDREWS
DRAWN: V.V. MADOCKE
CHECKED: E.A. ANDREWS

EXAMINED: _____
PASSED: _____
APPROVED: _____

PLAN
SCALE 1/8" = 1'-0"

FOR INFORMATION ONLY

Notes: For Scaling quantity of detail see 54.41.

GENERAL PLAN & ELEVATION
F.A.I. ROUTE 74 SECTION 90-14-HB
EAST WASHINGTON STREET
GRADE SEPARATION
TAZEWELL COUNTY - STATION 250+41

FOR INFORMATION ONLY



TAZEWELL COUNTY
EXISTING STRUCTURE PLAN AT
PROPOSED STRUCTURE NO. 090-0163