

68201	ROUTE No.	SECTION	COUNTY	TOTAL SHEETS	SHEET NO.
FA174	*	TAZEWELL	1366	558	
STA.			TO STA.		
F.H.W.A. REGION			ILLINOIS PROJECT		

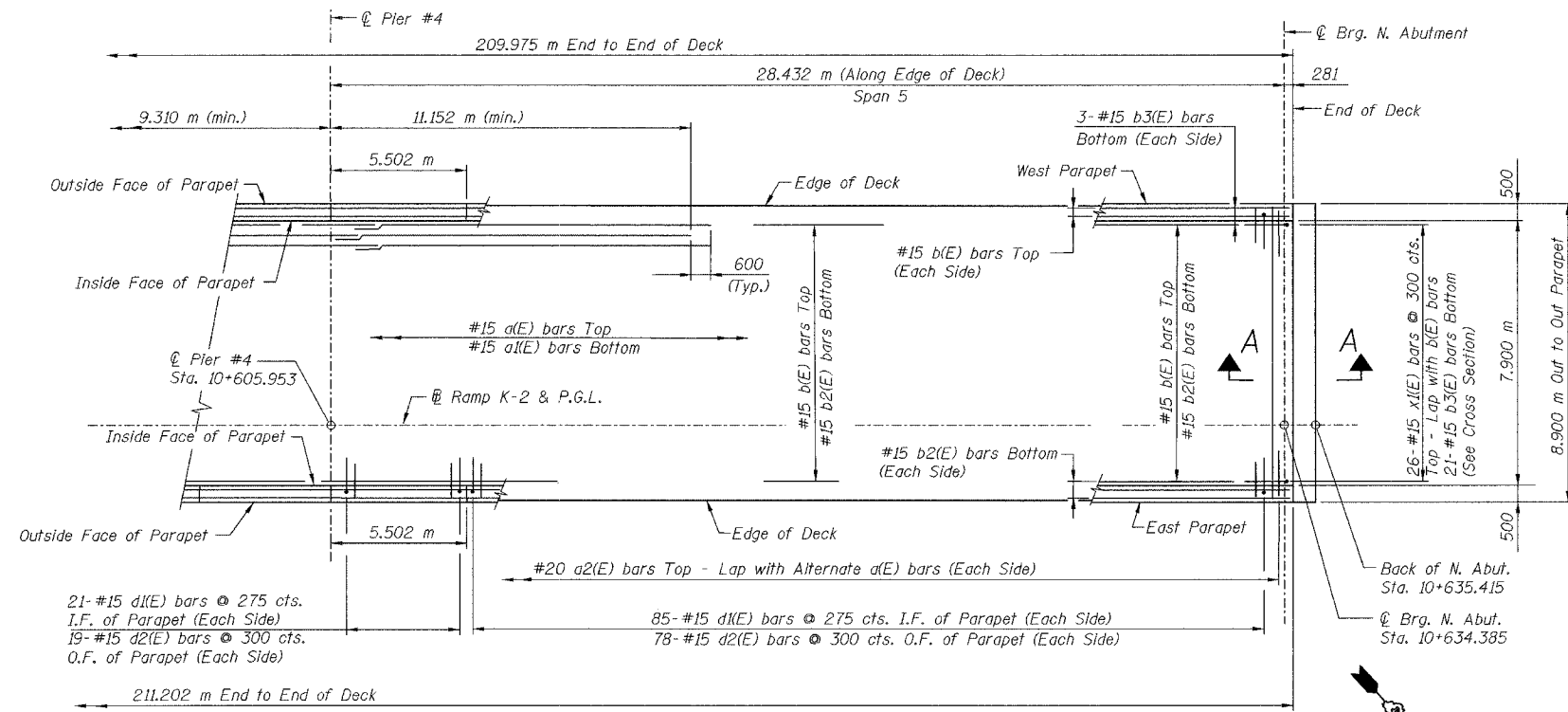

PARTIAL PLAN
(Span 5)

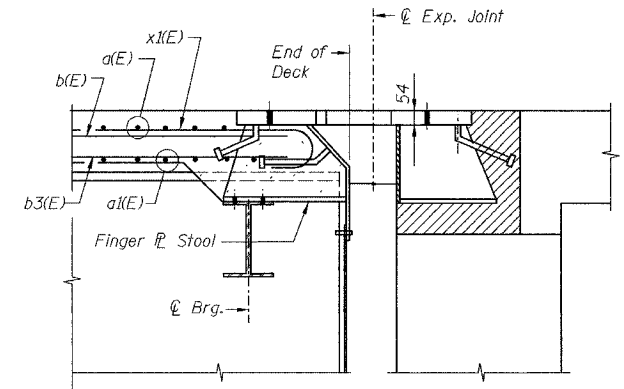

SECTION A-A

NOTES:

- All dimensions are in millimeters (mm) except as noted.
- Reinforcement bars designated "(E)" shall be epoxy coated.
- Bars indicated thus: 3x2-#15 etc. indicates 3 lines of bars with 2 lengths per line.
- Use the following minimum lap lengths unless otherwise noted:
#15 - 640 #25 - 1,320 mm
#20 - 790
- For Parapet Elevation, Details, and Reinforcement, see sheet 14.
- For Drainage Scupper Locations see sheet 32.
- I.F. denotes Inside Face
O.F. denotes Outside Face
- Work this sheet with sheets 10, 11 & 13.

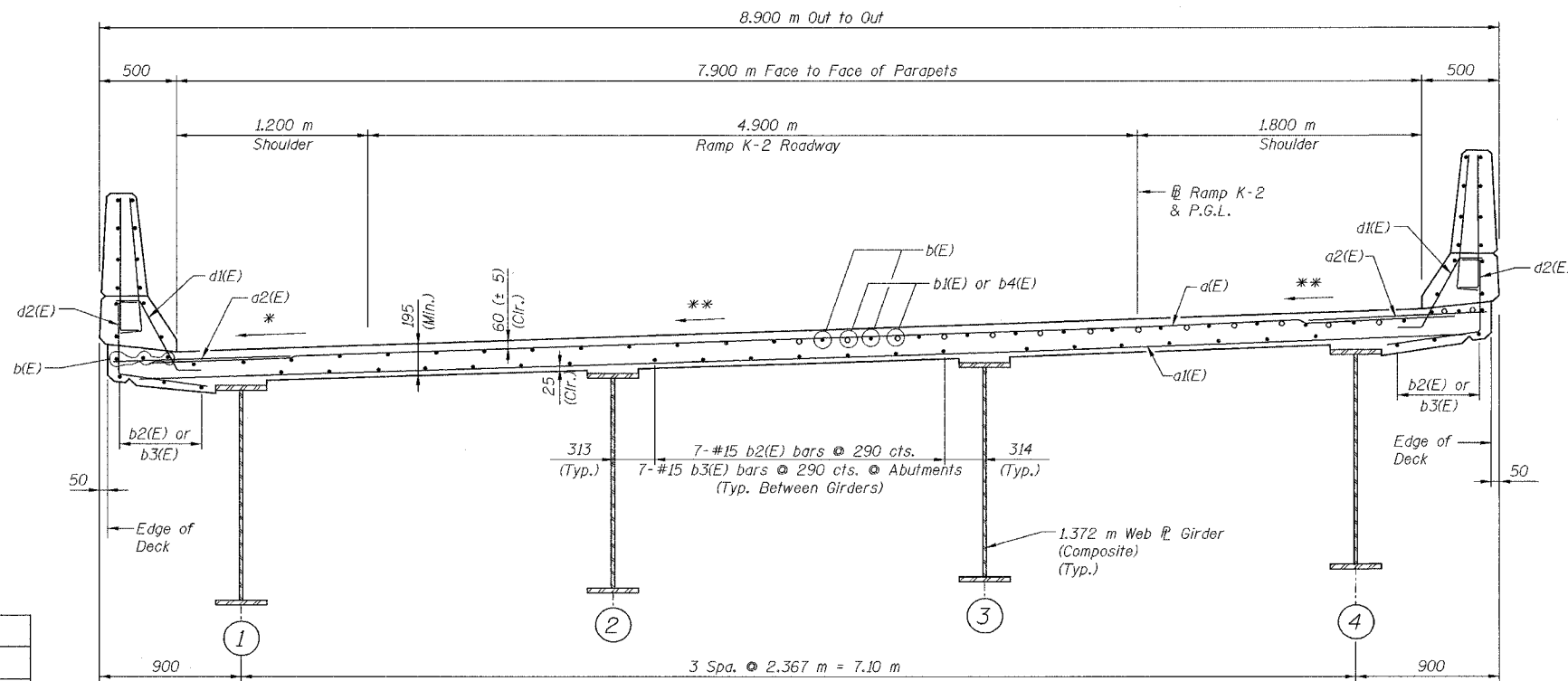

TYPICAL DECK CROSS SECTION
(Looking Upstation)

- * 4% up to Sta. 10+439.068
Linear Transition to 4.4% at Sta. 10+443
4.4% between Sta. 10+443 to Sta. 10+484
Linear Transition to -2% at Sta. 10+547
-2% beyond Sta. 10+547
- ** 2.38% at Sta. 10+423.179
Linear Transition to 4.4% at Sta. 10+443
4.4% between Sta. 10+443 at Sta. 10+484
Linear Transition to -2% at Sta. 10+547
-2% beyond Sta. 10+547

DESIGNED	HAA
CHECKED	KWS
DRAWN	VH
CHECKED	KJN

ILLINOIS DEPARTMENT OF TRANSPORTATION
RAMP K-2 OVER
MAIN ST & RAMP J-3
F.A.I. ROUTE 74 (I-74)
SECTION 90-IIB-5
**DECK PLAN SPAN 5
AND CROSS SECTION**

ab **alfred benesch & company**
CONSULTING ENGINEERS
205 NORTH MICHIGAN AVENUE, CHICAGO, ILLINOIS 60601
308 NO. 3573

SN: 090-0156
TAZEWELL CO., IL.
STA. 10+529.222
DATE: 12-23-04

2/3/2005

m:\p\03573\vr_emptk2_vr\tdp3-7a0900156.dgn