

\\p13852\mnt\1431101-5841.dgn 12/20/2004 4:07:50 PM

54 52 50 48 46 44 42 40 38 36 34 32 30 28 26 24 22 20 18 16 14 12 10 8 6 4 2 0 2 4 6 8 10 88201

| | | | | | |
|--|---------------------|-------------------------|----------|------------------|-----------|
| URS URS CORPORATION ST. LOUIS, MO | F.A.I. RTE. | SECTION | COUNTY | TOTAL SHEETS | SHEET NO. |
| | 74 | 190-11R-29003,1414-1R-1 | TAZEWELL | 1366 | 753 |
| | STA. | TO STA. | | | |
| | FED. ROAD DIST. NO. | ILLINOIS | | FED. AID PROJECT | |

| | |
|--------------|------|
| FINAL SURVEY | DATE |
| SURVEYED | |
| PLOTTED | |
| NOTE BOOK | |
| AREAS | |
| CHECKED | |
| NO. | |

| | |
|-----------------|------|
| ORIGINAL SURVEY | DATE |
| SURVEYED | |
| PLOTTED | |
| NOTE BOOK | |
| AREAS | |
| CHECKED | |
| NO. | |

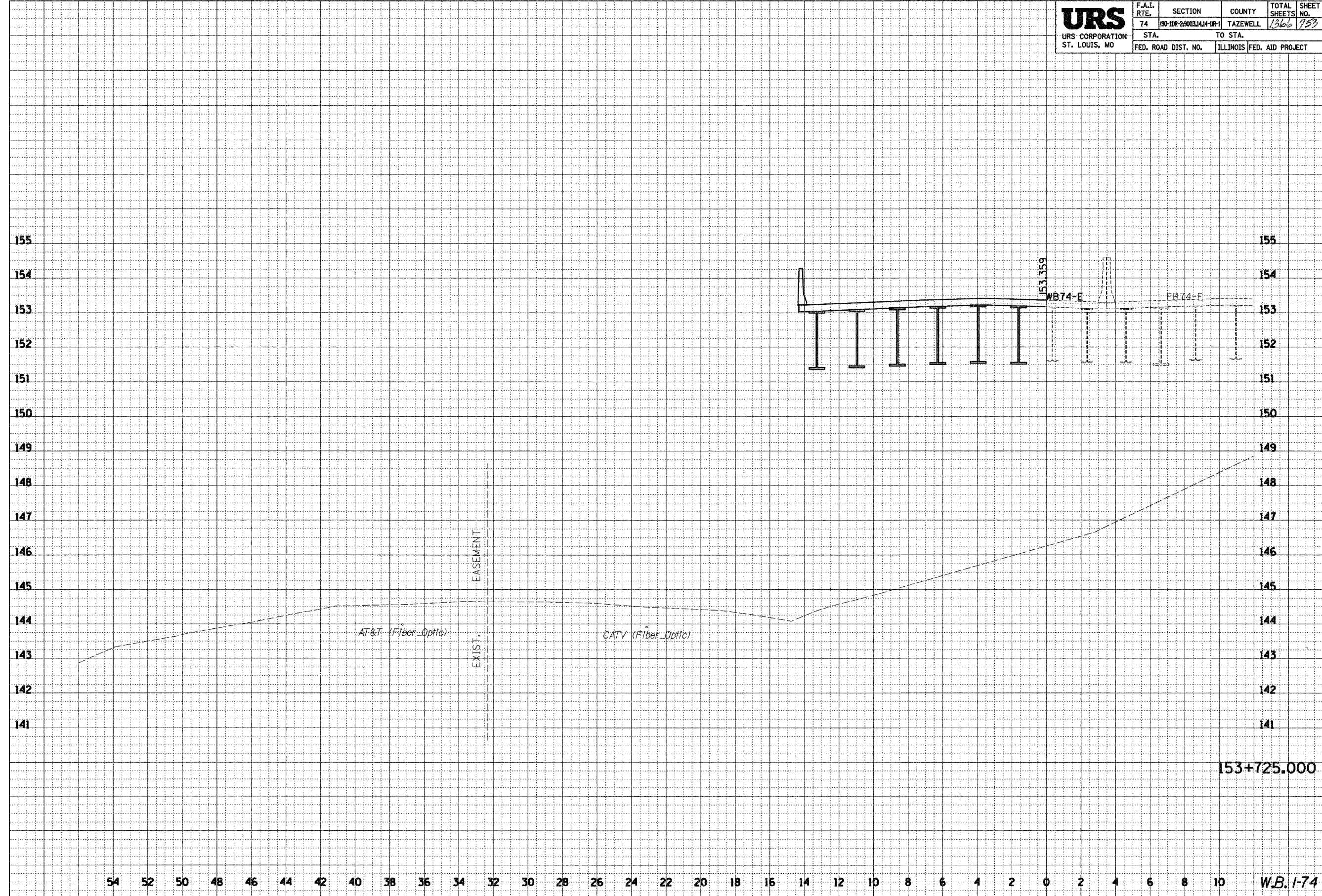

153+725.000

54 52 50 48 46 44 42 40 38 36 34 32 30 28 26 24 22 20 18 16 14 12 10 8 6 4 2 0 2 4 6 8 10 W.B. 1-74