

\\nas1101-5ana.dgn 12/16/2004 3:55:26 PM

F.A.I. SECTION		COUNTY	TOTAL SHEETS	SHEET NO.
74 *		TAZEWELL	1200	848
STA. TO STA.		ILLINOIS FED. AID PROJECT		
		*190-11R-2190(3,4,14)-1R-1		

FINAL SURVEY	BY	DATE
SURVEYED		
PLOTTED		
NOTED		
AREAS CHECKED		
NO.		

**URS**  
URS CORPORATION  
DECATUR, ILLINOIS

ORIGINAL SURVEY	BY	DATE
SURVEYED		
PLOTTED		
NOTED		
AREAS CHECKED		
NO.		

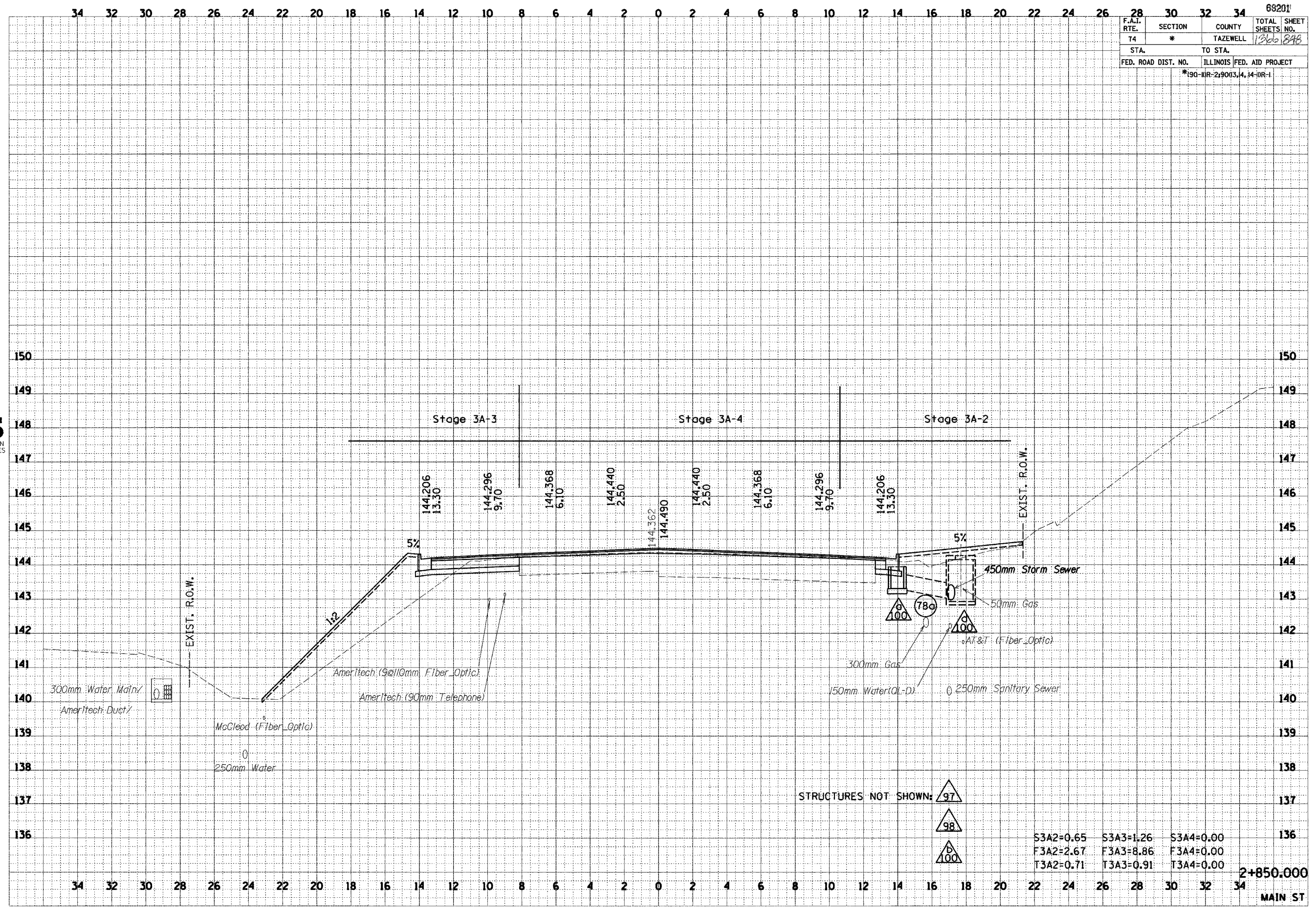

2+850.000  
MAIN ST