

J:\089821\101-589.dgn 12/16/2004 4:02:29 PM

F.A.I. RTE.	SECTION	COUNTY	TOTAL SHEETS	SHEET NO.
74	*	TAZEWELL	1360	895
STA.	TO STA.			
FED. ROAD DIST. NO.	ILLINOIS FED. AID PROJECT			
	*190-11R-2190(3,4,14-1)R-1	150		

BY	DATE
ORIGINAL SURVEY	PLOTTED
NOTE BOOK	AREAS CHECKED
NO.	

**URS**  
 URS CORPORATION  
 DECATUR, ILLINOIS

BY	DATE
ORIGINAL SURVEY	PLOTTED
NOTE BOOK	AREAS CHECKED
NO.	

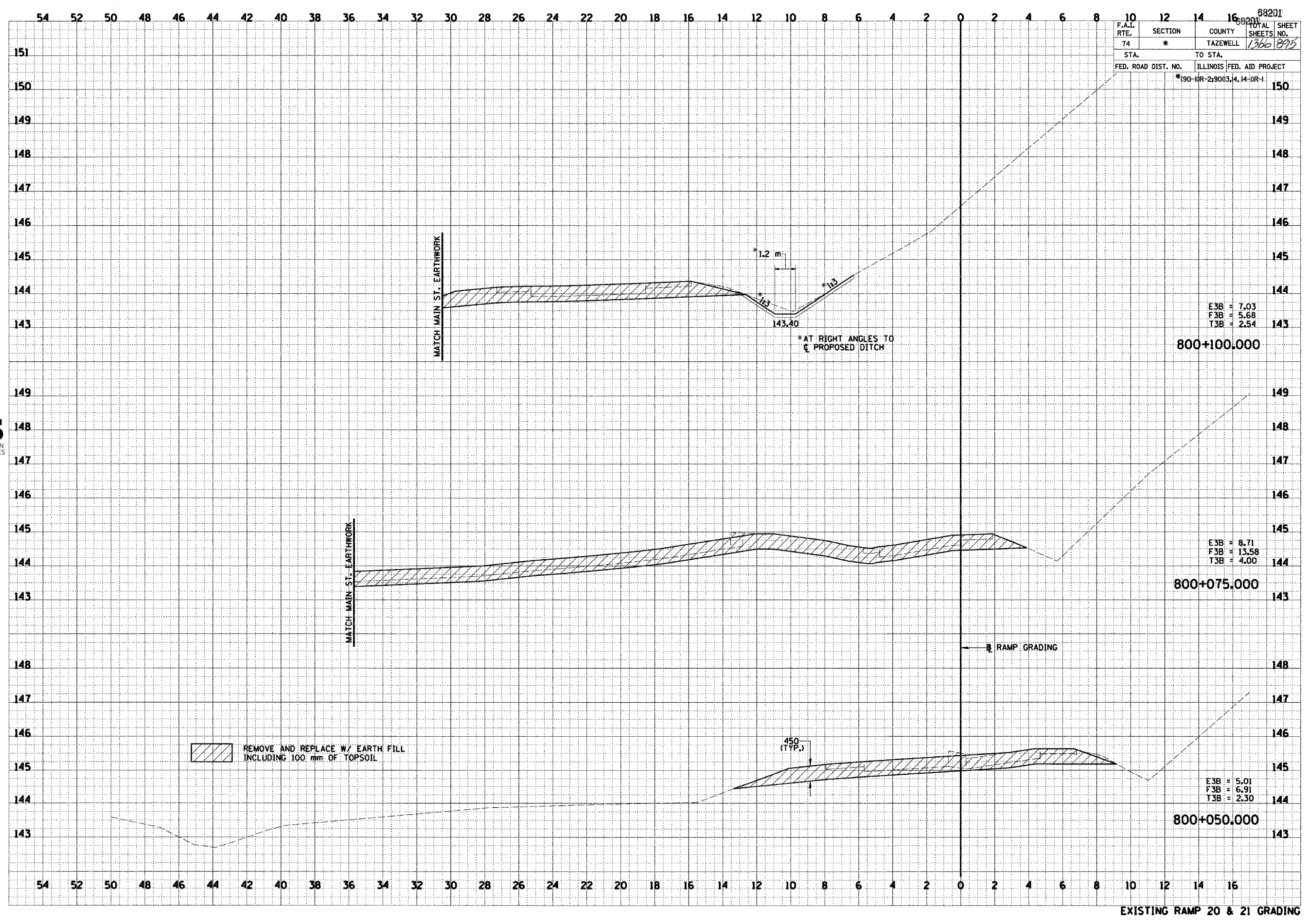

EXISTING RAMP 20 & 21 GRADING