

F.A.I. RTE.	SECTION	COUNTY	TOTAL SHEETS	SHEET NO.
74	*	TAZEWELL	1366	938
STA. 153+800		TO STA. 157+800		
FED. ROAD DIST. NO. 4		ILLINOIS FED. AID PROJECT		

• (90-1)R-2,90(13,14,14-1)R-1

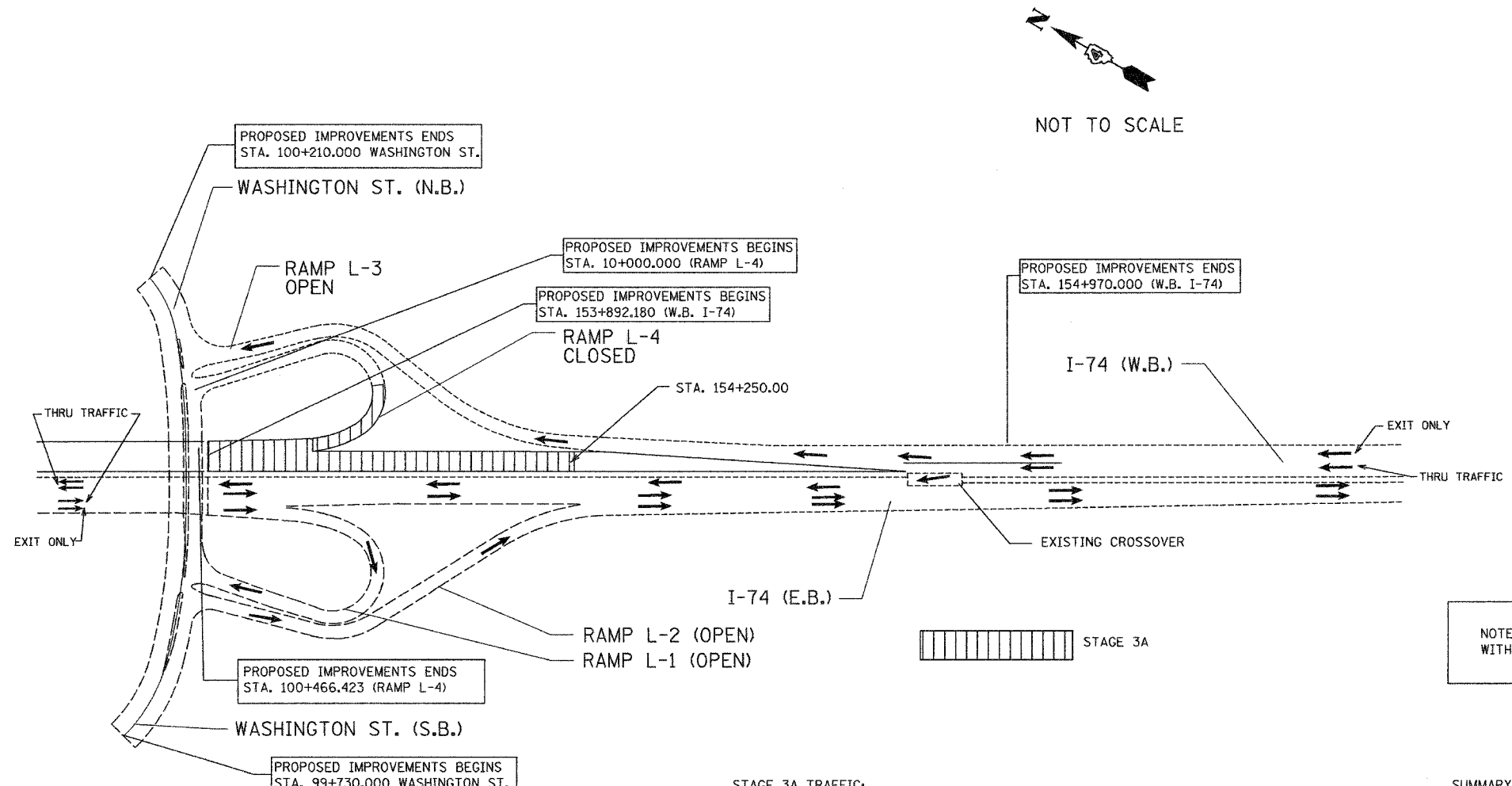

NOTE: ALL CONTRACTOR FURNISHED TEMPORARY CONCRETE BARRIER WITHIN THIS SECTION SHALL BE TYPE F CONCRETE BARRIER.

F.A.I. ROUTE 74 (W.B. I-74)
 MAINTENANCE OF TRAFFIC AND CONSTRUCTION SEQUENCE
 STAGE 3A

STAGE 3A CONSTRUCTION:

1. CLOSE THE EASTBOUND AND WESTBOUND MEDIAN LANES OF TRAFFIC. INSTALL THE TEMPORARY CONCRETE BARRIERS TO A LOCATION NEAR THE CENTER OF THE EASTBOUND LANES. TRANSFER THE WESTBOUND TRAFFIC TO THE EASTBOUND SIDE. MOVE CONCRETE BARRIERS ON WEST BOUND LANES NEAR RAMP L-3. ALLOW WESTBOUND TRAFFIC TO EXIT OFF RAMP L-3 TO WASHINGTON STREET.
2. REMOVE THE EXISTING PAVEMENT AND SHOULDERS ON THE WESTBOUND LANES BETWEEN STATION 153+892.180 AND STATION 154+250.000 AND A PORTION OF RAMP L-4.
3. BEGIN THE CONSTRUCTION OF THE PAVEMENT STRUCTURE, INCLUDING THE AGGREGATE SUBBASE, BITUMINOUS CONCRETE BINDER COURSE, CONTINUOUSLY REINFORCED PCC PAVEMENT, PCC CONCRETE SHOULDER, AGGREGATE SHOULDER AND OTHER INCIDENTAL ITEMS. THE WORK ZONE INCLUDES THE WEST BOUND LANES ON I-74 BETWEEN STATION 153+892.180 AND STATION 154+250.00
4. BEGIN CONSTRUCTION OF THE PAVEMENT STRUCTURE, INCLUDING THE AGGREGATE SUBBASE, BITUMINOUS CONCRETE BINDER COURSE, PCC PAVEMENT, PCC CONCRETE SHOULDER, PCC GUTTER AND OTHER INCIDENTAL ITEMS ON RAMP L-4 EXCEPT STATION 10+000 THROUGH STATION 10+250.
5. CONTINUE CONSTRUCTION OF EARTHWORK AND STORM SEWER IN THE INFIELD OF RAMPS L-3 AND L-4.

STAGE 3A TRAFFIC:

1. USING STANDARD 701406, CLOSE THE WESTBOUND, I-74 MEDIAN LANE TO TRAFFIC AT STATION 153+892.180 TO STATION 154+250.000 FOR REMOVAL OF THE TEMPORARY CONCRETE BARRIER, STATE OWNED. CLOSE EASTBOUND I-74 MEDIAN LANE TO TRAFFIC TO INSTALL TEMPORARY CONCRETE BARRIERS, STATE OWNED FROM STATION 153+892.180 TO STATION 154+250.000 AND TEMPORARY CONCRETE BARRIERS FROM STATION 153+892.180 TO THE EASTERN PROJECT LIMITS. THIS MUST BE COORDINATED WITH MAINTENANCE OF TRAFFIC DESCRIBED IN PLAN SET 1 OF 3, STAGE 3A.
2. CLOSE RAMP L-4 USING STANDARD 701411-I74. RAMP L-3 REMAINS OPEN. RAMPS L-1 AND L-2 TO BE KEPT OPEN AT ALL TIMES.
3. SPLIT TWO WESTBOUND LANES AT STA. 155+100. OUTSIDE LANE TO ACCESS RAMP L-3, AND WASHINGTON STREET MEDIAN SIDE LANE TO ACCESS CROSSOVER TO MEDIAN SIDE EASTBOUND LANES. THE TRAFFIC CONTROL SHALL BE BASED ON THE DETAILS SHOWN IN THE PLANS AND STANDARDS 701416 AND 701426.
4. MAINTAIN TWO WAY TRAFFIC ON THE EXISTING I-74 EASTBOUND LANES FROM STATION 153+892.180 TO STATION 154+780.000.

SUMMARY OF TEMPORARY CONCRETE BARRIER IN STAGE 3A

- REMOVE EXISTING IMPACT ATTENUATOR FROM CROSSOVER AT EASTERN LIMITS OF PROJECT AND PLACE IN STORAGE.
- RELOCATE TEMPORARY CONCRETE BARRIER, STATE OWNED : MOVE EXISTING TEMPORARY CONCRETE BARRIER TO EASTBOUND PAVEMENT NEAR THE CENTERLINE STATION 153+892.180 TO STATION 154+250.
- TEMPORARY CONCRETE BARRIER: INSTALL TEMPORARY CONCRETE BARRIER ON EASTBOUND PAVEMENT NEAR THE CENTERLINE STATION 154+250 TO STATION 154+887.
- IMPACT ATTENUATOR, TEMPORARY: INSTALL IMPACT ATTENUATOR, TEMPORARY TO EASTBOUND PAVEMENT STATION 154+887 TO WESTBOUND STATION 154+895 AND STATION 154+818.

SUMMARY OF TEMPORARY CONCRETE BARRIER IN STAGE 3A (CONTINUED)

RELOCATE TEMPORARY CONCRETE BARRIER, STATE OWNED: MOVE EXISTING TEMPORARY CONCRETE BARRIERS TO DIRECT TRAFFIC ONTO RAMP L-3.

SHEET 3 OF 18

ALL STATIONS INDICATED ARE WESTBOUND STATIONING UNLESS OTHERWISE NOTED.

ILLINOIS DEPARTMENT OF TRANSPORTATION

MAINTENANCE OF TRAFFIC
 SCHEMATIC DRAWING
 STAGE 3A
 STA. 153+800 TO STA. 156+600

DATE 01/12/2005
 DRAWN BY
 CHECKED BY

REVISIONS	
NAME	DATE

01/12/2005 05:27:54 PM G:\dtd\5589-74\dwg\Contr\cct\I1100_3A-6A.dgn

CONTRACT I11: PLAN SET 2 OF 4 FINAL PLANS 01/05