

F.A.I. RTE.	SECTION	COUNTY	TOTAL SHEETS NO.	SHEET NO.
74	*	TAZEWELL	1366	941
STA. 154+500		TO STA. 154+850		
FED. ROAD DIST. NO. 4		ILLINOIS FED. AID PROJECT		

(90-1)R-2(90)13,14,14-1R-1

NOTE: ALL CONTRACTOR FURNISHED TEMPORARY CONCRETE BARRIER WITHIN THIS SECTION SHALL BE TYPE F CONCRETE BARRIER.

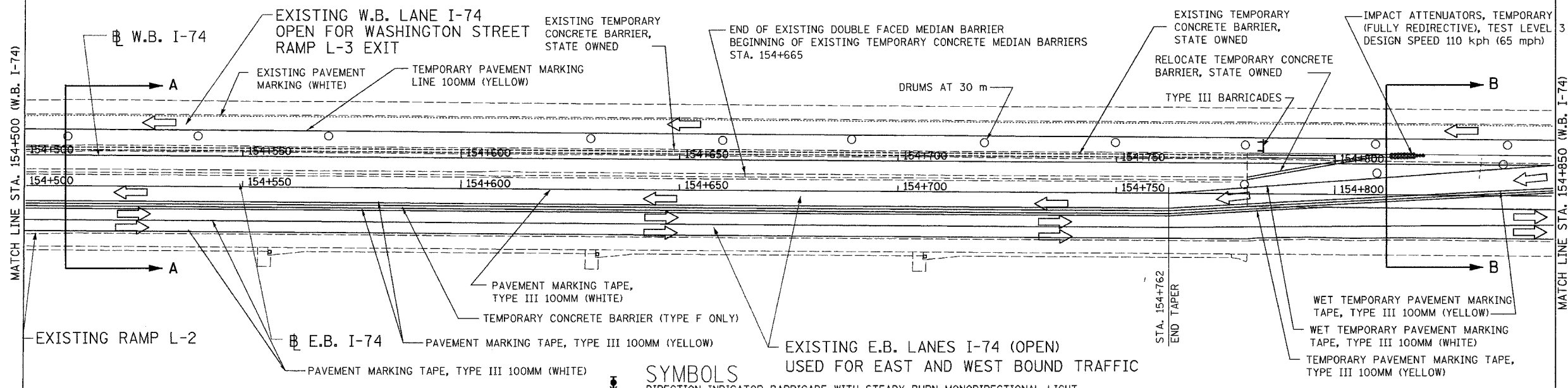
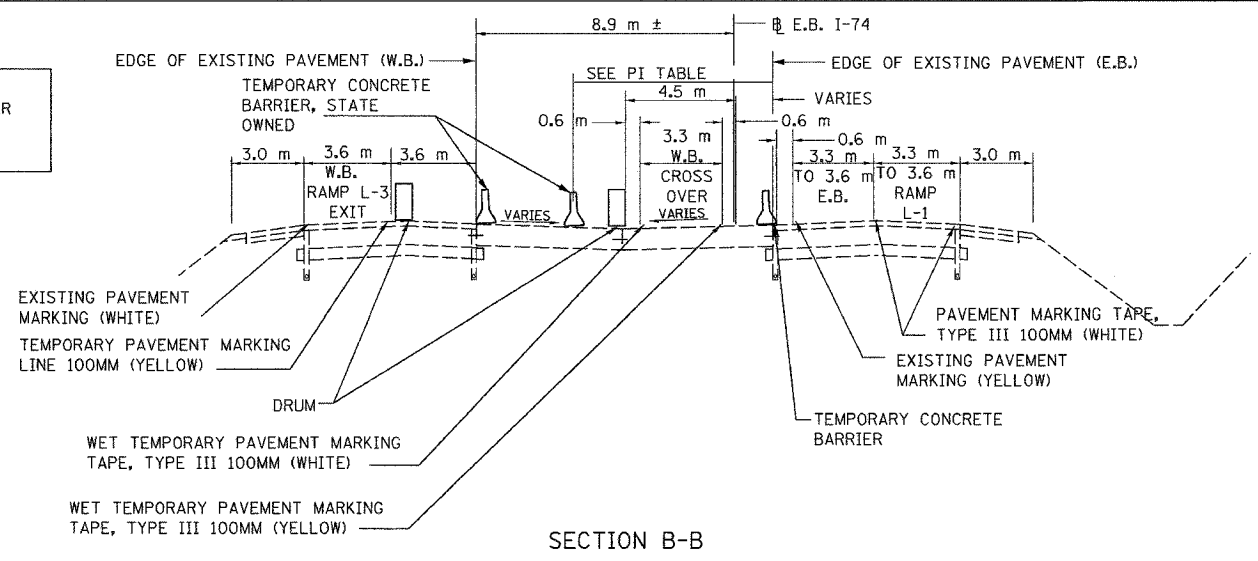
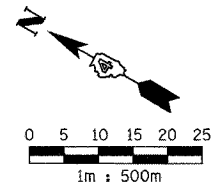

SYMBOLS
 ▽ DIRECTION INDICATOR BARRICADE WITH STEADY BURN MONODIRECTIONAL LIGHT
 ○ DRUM WITH MONODIRECTIONAL STEADY BURNING LIGHT

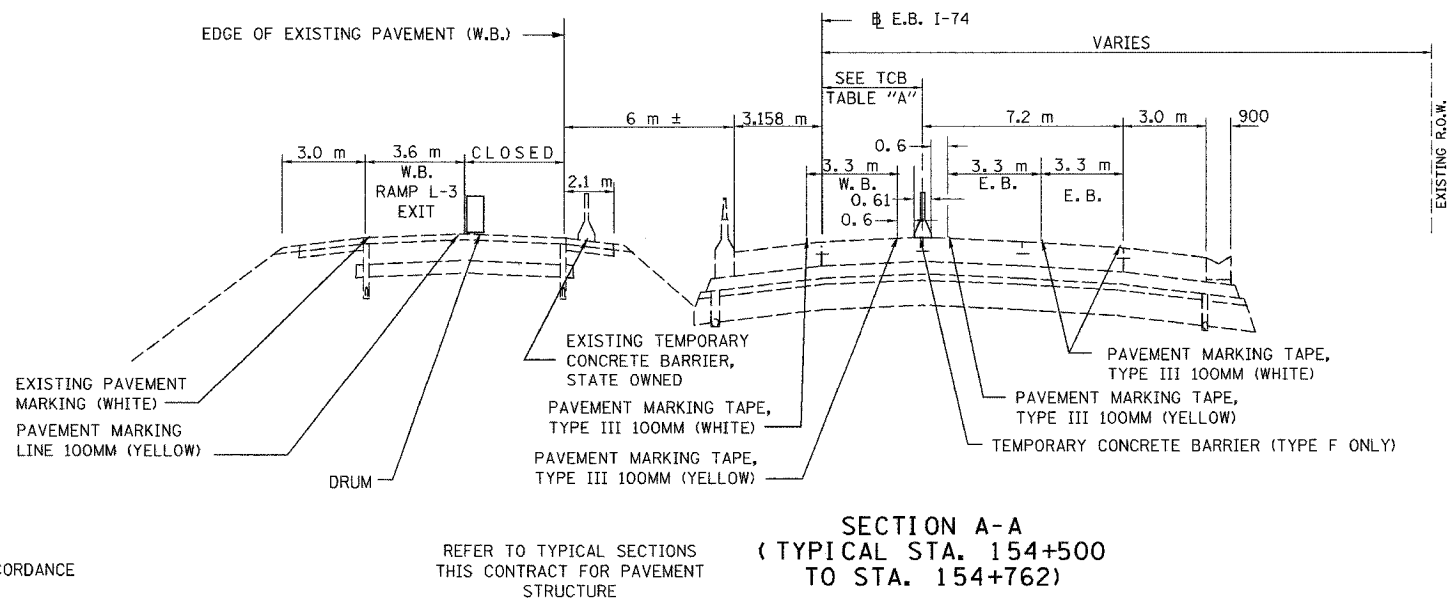

LOCATION	POINTS OF INTERSECTION (PI) TABLE						
	OFFSET IN METERS FROM EASTBOUND BASE LINE						
	WESTBOUND			EASTBOUND			
	SOLID WHITE	SOLID YELLOW	TCB OUTER	SOLID YELLOW	CENTER WHITE	OUTER WHITE	TCB LANE DIVIDER
STA. 154+500.00	0.6 LT	2.7 RT.		4.5 RT	7.8 RT	11.1 RT	3.6 RT.
STA. 154+760.00	0.6 LT	2.7 RT.		4.5 RT	7.8 RT	11.1 RT	3.6 RT.
STA. 154+780.00							
STA. 154+810.00			3.16 LT 9 LT				
STA. 154+860.00	3.5 LT						
STA. 154+887.00				3 RT	6.3 RT	9.6 RT	0.55 LT
STA. 154+900.00				2.6 RT	6.2 RT	9.8 RT	
STA. 154+906.40	12.8 LT	9.5 LT					

SHEET 6 OF 18
 ALL DIMENSIONS ARE IN METERS (m) EXCEPT AS NOTED

DA & A
 DAILY & ASSOCIATES, ENGINEERS, INC.
 PEORIA, ILLINOIS

REVISIONS	
NAME	DATE

ALL STATIONS INDICATED ARE WESTBOUND STATIONING UNLESS OTHERWISE NOTED.

ILLINOIS DEPARTMENT OF TRANSPORTATION

MAINTENANCE OF TRAFFIC
 STAGE 3A
 STA. 154+500 TO STA. 154+850

DATE 01/07/2005

DRAWN BY
 CHECKED BY

01/07/2005 04:48:18 PM
 q:\dotto\5589-74\dwg\contract\mt103_3a-6a.dgn

TRAFFIC CONTROL:
 LANE CLOSURE SHALL BE IN ACCORDANCE WITH STANDARD 701416

REFER TO TYPICAL SECTIONS THIS CONTRACT FOR PAVEMENT STRUCTURE

SECTION A-A
 (TYPICAL STA. 154+500 TO STA. 154+762)

CONTRACT 11: PLAN SET 2 OF 4 FINAL PLANS 01/05