

F.A.I. RTE.	SECTION	COUNTY	TOTAL SHEETS	SHEET NO.
74	*	TAZEWELL	1366	956
STA. 154+850		TO STA. 155+200		
FED. ROAD DIST. NO. 4		ILLINOIS FED. AID PROJECT		

• (90-11R-2;90(13,14,14-1R-1

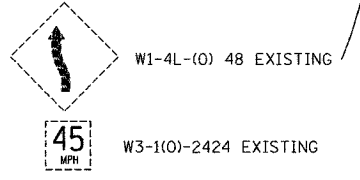

- SYMBOLS**
- DRUM WITH MONODIRECTIONAL STEADY BURNING LIGHT
 - ⇄ DIRECTION INDICATOR BARRICADE WITH STEADY BURN MONODIRECTIONAL LIGHT

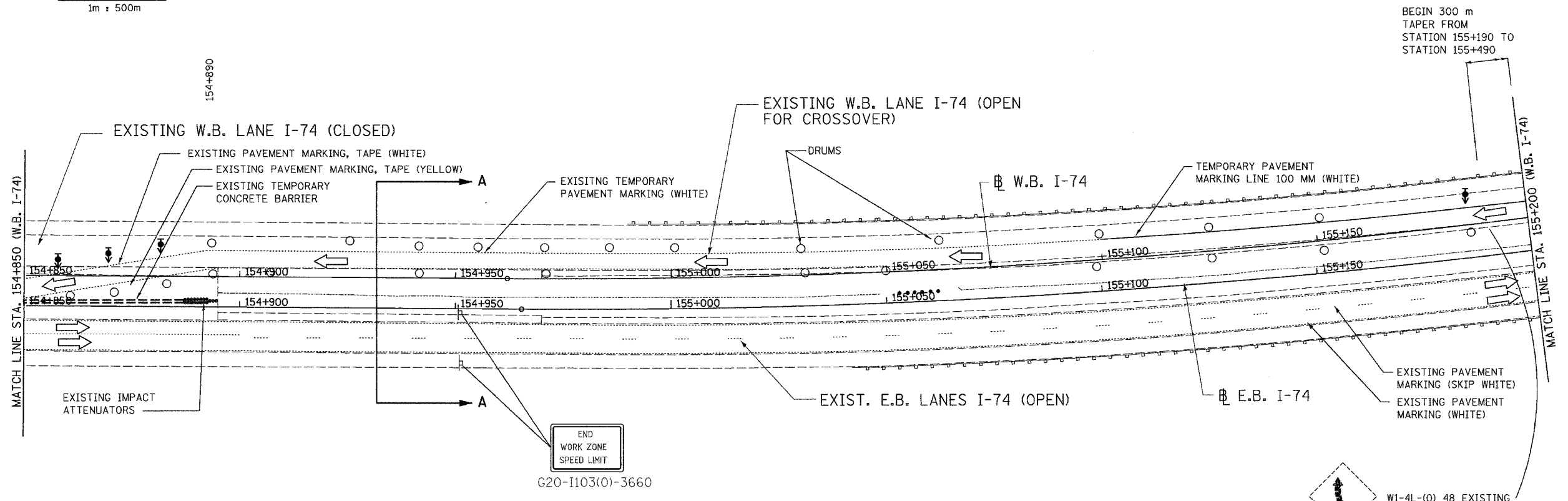
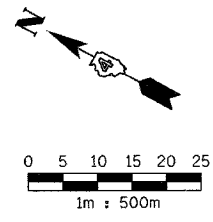
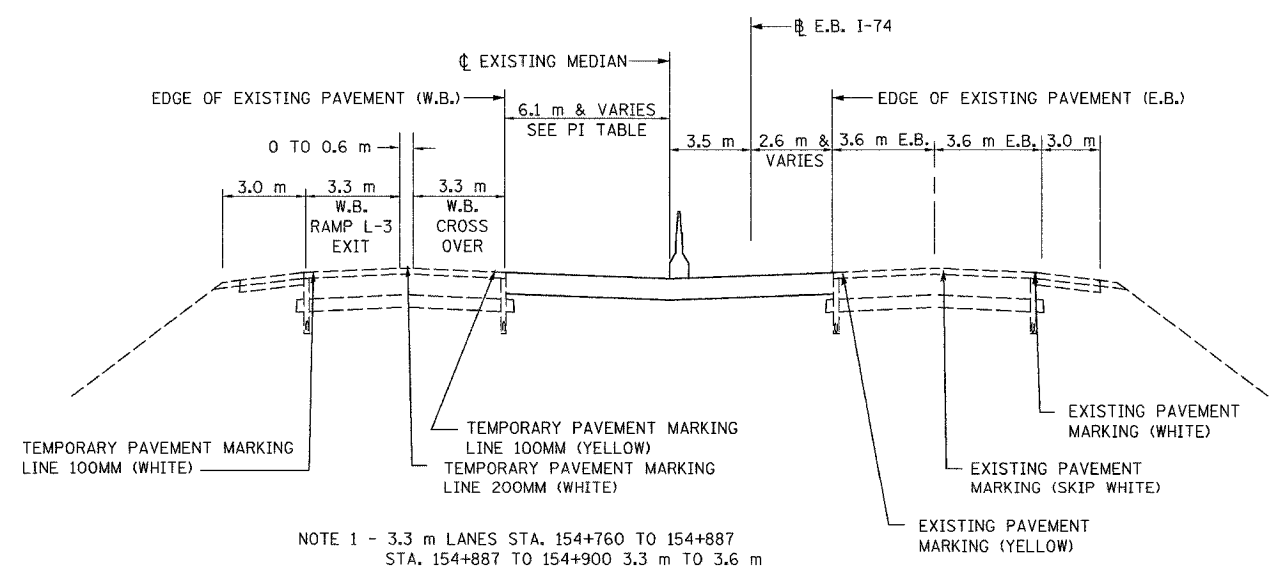

NOTE 1 - 3.3 m LANES STA. 154+760 TO 154+887
STA. 154+887 TO 154+900 3.3 m TO 3.6 m

SECTION A-A

REFER TO TYPICAL SECTIONS THIS CONTRACT FOR PAVEMENT STRUCTURE

TRAFFIC CONTROL:
LANE CLOSURE SHALL BE IN ACCORDANCE WITH STANDARD 701416

ALL DIMENSIONS ARE IN METERS (m) EXCEPT AS NOTED

ALL STATIONS INDICATED ARE WESTBOUND STATIONING UNLESS OTHERWISE NOTED.

D&A
DAILY & ASSOCIATES,
ENGINEERS, INC.
PEORIA, ILLINOIS

REVISIONS	
NAME	DATE

ILLINOIS DEPARTMENT OF TRANSPORTATION

MAINTENANCE OF TRAFFIC
STAGE 3B
STA. 154+850 TO STA. 155+200

DATE 01/07/2005

DRAWN BY
CHECKED BY

01/07/2005 05:27:44 PM
Q:\gdra\5589-74\dwg\contract\plan\114_3b-6a.dgn

CONTRACT 11: PLAN SET 2 OF 4 FINAL PLANS 01/05

D:\PROJECTS\114_3b-6a.dgn 01/07/2005 05:27:44 PM