

F.A.I. RTE.	SECTION	COUNTY	TOTAL SHEETS NO.	SHEET NO.
74		TAZEWELL	1366	980
STA. 153+892.180 TO STA. 154+150				
FED. ROAD DIST. NO. 4		ILLINOIS FED. AID PROJECT		

• (90-11)R-2;90(13,14,14-1)R-1

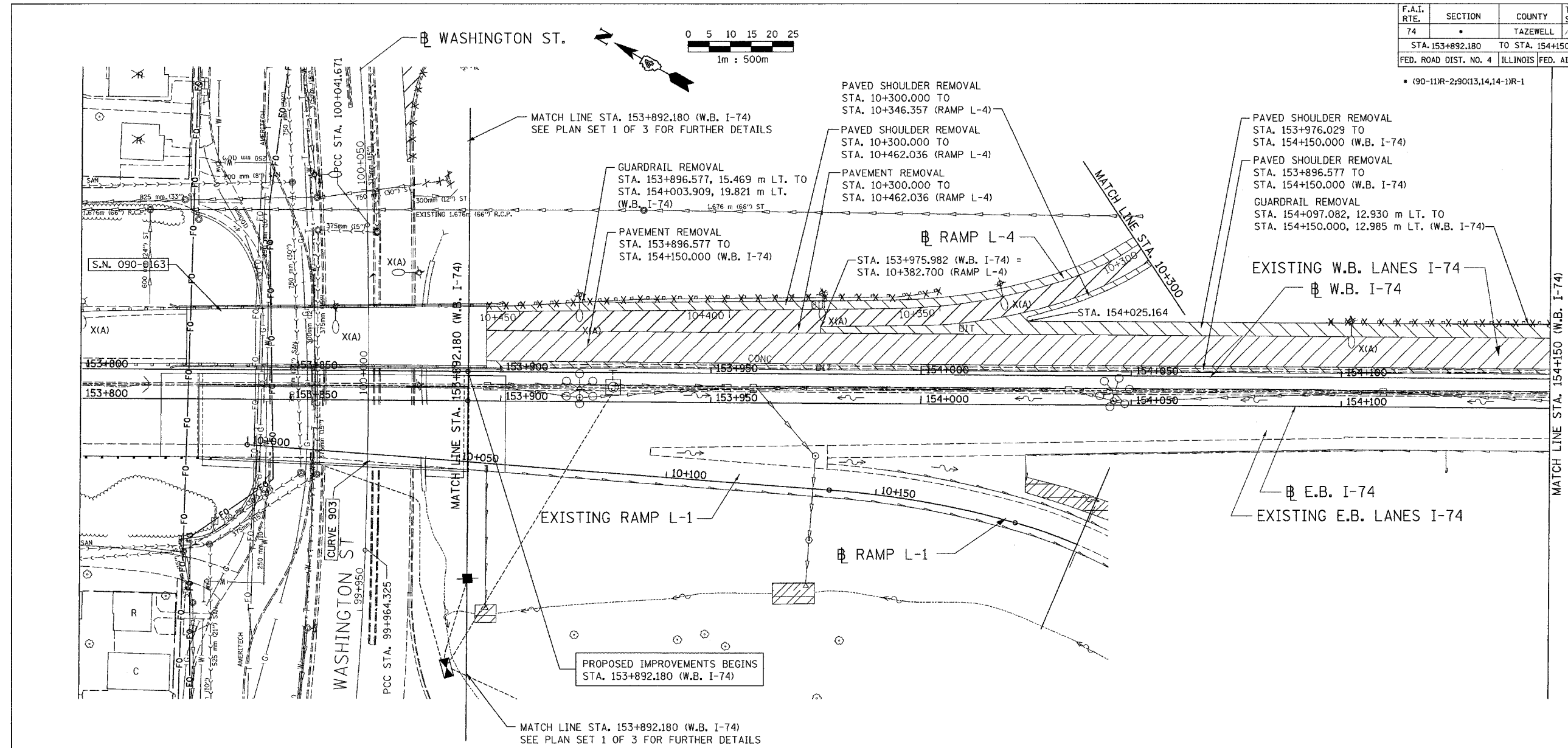

LEGEND

	CATCH BASIN		PAVEMENT REMOVAL
	INLET		SHOULDER REMOVAL
	MANHOLE		GUARDRAIL REMOVAL
	SAG		PAVED DITCH REMOVAL
	SUMMIT		RIGHT-OF-WAY
	DITCH		CONSTRUCTION LIMITS
	SWALE		
	PIPE UNDERDRAIN		
	SANITARY (LOCATION OF RECORD)		
	STORM SEWER		
	COMBINATION SEWER		
	CULVERT		
	CONCRETE HEADWALL		
	FLOW DIRECTION		
	GAS (LOCATION OF RECORD)		
	TELEPHONE (LOCATION OF RECORD)		
	WATER (LOCATION OF RECORD)		
	DITCH		

01/07/2005 02:40:15 PM
 q:\data\5589-74\dwg\contract\plan\p165-6g.dwg

ALL DIMENSIONS ARE IN METERS (m) EXCEPT AS NOTED

ALL STATIONS INDICATED ARE WESTBOUND STATIONING UNLESS OTHERWISE NOTED.

DA
 DAILY & ASSOCIATES,
 ENGINEERS, INC.
 PEORIA, ILLINOIS

REVISIONS	
NAME	DATE

ILLINOIS DEPARTMENT OF TRANSPORTATION

EXISTING ROADWAY PLAN
 F.A.I. ROUTE 74 (I-74)
 STA. 153+892.180 TO STA. 154+150

DATE 01/07/2005

DRAWN BY
 CHECKED BY

SHEET 1 OF 12

CONTRACT 11: PLAN SET 2 OF 4 FINAL PLANS 01/05