

F.A.I. RTE.	SECTION	COUNTY	TOTAL SHEETS NO.	SHEET NO.
74	**	TAZEWELL	1366	1002
STA.	**	TO STA.	**	**
FED. ROAD DIST. NO. 4 ILLINOIS FED. AID PROJECT				

• (90-11R-2)9013,14,14-1R-1
 ** RAMP L-3 STA. 10+350 TO STA. 10+700
 RAMP L-4 STA. 10+000 TO STA. 10+500

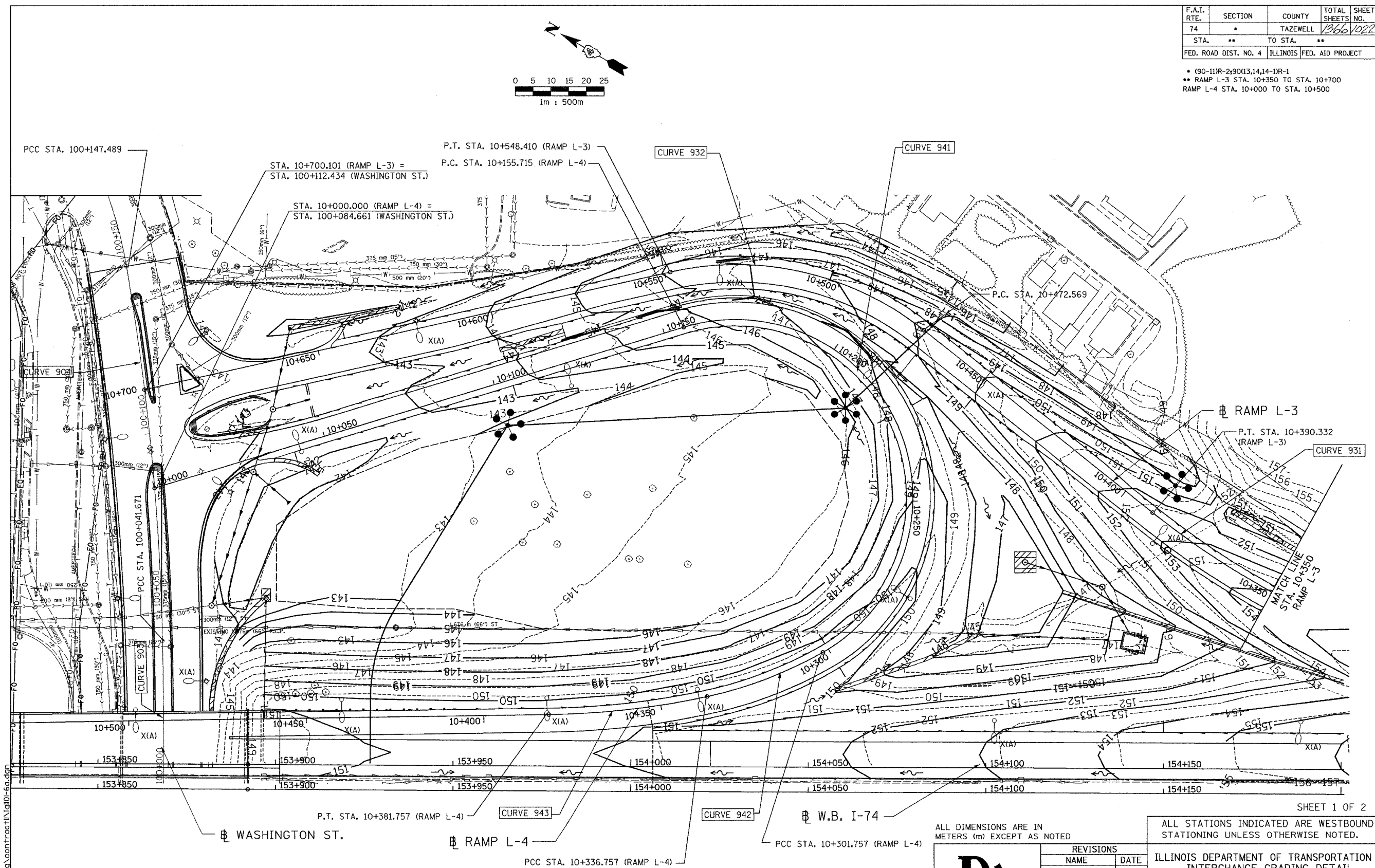
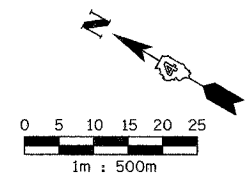

01/07/2005 01:21:49 PM
 C:\p01\15589-74\dwg\cont\get\100-60.dwg

ALL DIMENSIONS ARE IN METERS (m) EXCEPT AS NOTED



REVISIONS	
NAME	DATE

SHEET 1 OF 2

ALL STATIONS INDICATED ARE WESTBOUND STATIONING UNLESS OTHERWISE NOTED.

ILLINOIS DEPARTMENT OF TRANSPORTATION
 INTERCHANGE GRADING DETAIL
 F.A.I. ROUTE 74 (I-74)
 RAMP L-3
 STA. 10+350 TO STA. 10+700
 RAMP L-4
 STA. 10+000 TO STA. 10+500
 DRAWN BY
 DATE 01/07/2005 CHECKED BY

CONTRACT 11: PLAN SET 2 OF 4 FINAL PLANS 01/05